

FIRST ANGLE PROJECTION

Modifications

Iss

248.00

240.35

1

64.50

75.50

64.50

5.50

$\phi 3.50$

230.00

R1.00

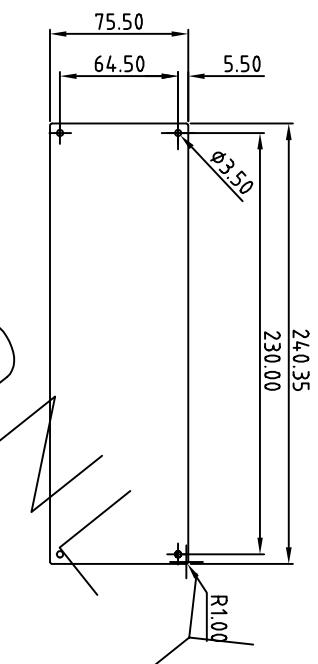
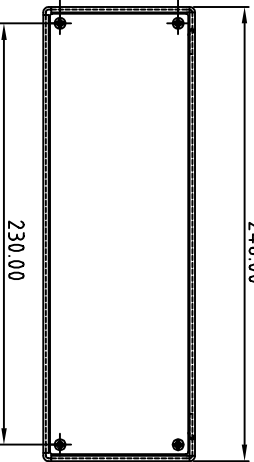

206.40

230.00

1

60.00
5.50
15.00

$\phi 3.20$
 $\phi 3.50 (x2)$

210.00

180.00

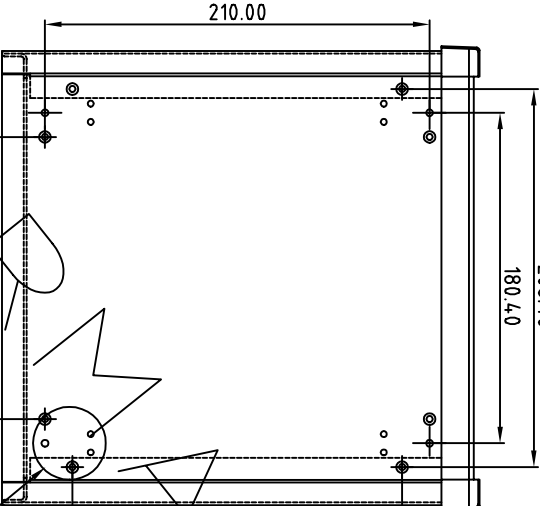
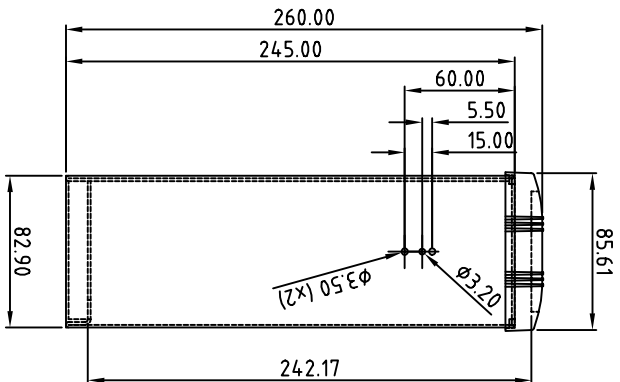

See Detail 'A'

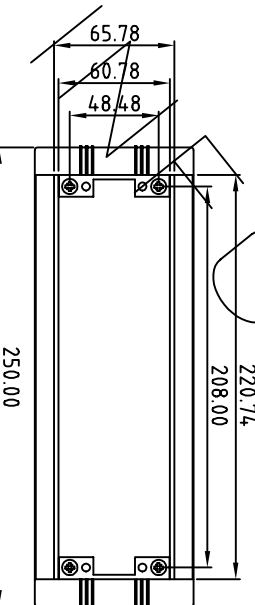
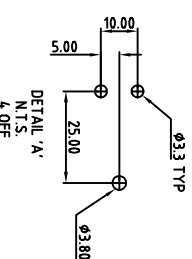

Note: Subject to technical modifications without prior notice.
Typographical and other errors do not justify any claim for damages.
All dimensions should be verified using the actual case.

Tolerances unless
otherwise stated:

General tolerances ± 0.20

Resultant tolerances between

hole centers ± 0.15

Tolerances on hole diameters ± 0.05

Angles $\pm 0.5^\circ$

Surface finish $\sqrt{32}$

Required Finish

Scale 1:4

ALL DIMENSIONS IN MILLIMETRES

Date drawn 18/04/01

DO NOT SCALE

Drawn by Mark Jeffery

Checked by

Drawing Number M5625115

Date drawn 18/04/01

Material Spec.

OKW

Unit 6, Kingdom Close, Segensworth East
Farham, Hampshire, UK, PO15 5TJ

Part Name
Unimet Size 3 for Handle

Part Number
M5625115

Sheet 1 of 1

OKW ENCLOSURES LTD DATE AS SHOWN. THIS DRAWING CONTAINS PROPRIETARY INFORMATION OF OKW ENCLOSURES LTD AND IS TENDERED SUBJECT TO THE FOLLOWING CONDITIONS. THE INFORMATION BE RETAINED IN CONFIDENCE, NOT BE REPRODUCED OR COPIED, AND NOT BE USED OR INCORPORATED IN ANY PRODUCT, UNLESS PERMISSION IS OBTAINED IN WRITING FROM OKW ENCLOSURES LTD.

A4