

Datasheet

RS PRO Cylindrical Male - Male Anti Vibration Mounts

A simple and cost-effective mount using made from natural rubber and Zinc plated mild steel. For use in compression and shear. A Very large range of available size and studs.

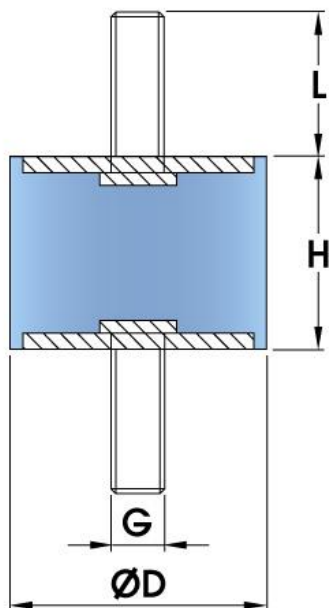

H – Height
D – Diameter
G – Thread Size
L – Stud Length

RS Code (mm)	Rubber Hardness (ShA)	Diameter (mm)	Height (mm)	G x L (mm)	Max Compression Load (KG)	Max Shear Load (KG)
1893246	45	8	8	M3x6	2.4	0.8
1893249	60	8	8	M3x6	4.4	1.5
1893252	45	10	8	M4x10	2.7	0.9
1893290	60	10	8	M4x10	7.9	2.4
1893293	60	15	8	M4x10	25	5.2
1893306	35	15	15	M5x12	4	1.3
1893261	45	16	15	M4x10	6	2
1893298	60	16	15	M4x10	13.3	5.2
1893268	35	20	15	M6x18	8.2	2.8
1893280	45	20	15	M6x18	12.3	4.2
1893307	45	20	20	M6x18	11	4.2
1893234	45	25	15	M6x18	21.5	6.6
1893273	45	25	20	M6x18	18.4	6.6
1893217	60	25	20	M6x18	38.5	14.4
1893282	35	25	20	M8x20	12.2	4.4
1893243	45	25	25	M6x18	17.1	6.6
1893245	45	25	30	M8x20	16.4	6.6
1893259	50	30	20	M8x20	37.5	12

RS Code (mm)	Rubber Hardness (ShA)	Diameter (mm)	Height (mm)	G x L (mm)	Max Compression Load (KG)	Max Shear Load (KG)
1893310	50	25	20	M8x20	23.3	8.3
1893223	35	25	30	M8x20	10.9	4.4
1893211	45	30	25	M8x20	26.3	9.5
1893220	45	30	30	M8x20	24.8	9.5
1893231	60	30	30	M8x20	52.9	20.8
1893221	60	40	20	M10x25	112	36.9
1893214	45	40	25	M10x25	54	17
1893251	60	40	30	M10x25	100.2	36.9
1893242	50	40	30	M8x23	48.1	17
1893283	70	40	30	M8x23	147	54
1893228	45	40	35	M10x25	46	17
1893212	60	40	35	M10x25	97.8	36.9
1893322	45	40	35	M8x23	46	17
1893288	45	50	25	M10x25	97.6	26.5

RS Code (mm)	Rubber Hardness (ShA)	Diameter (mm)	Height (mm)	G x L (mm)	Max Compression Load (KG)	Max Shear Load (KG)
1893313	60	50	33	M10x25	159.8	57.7
1893321	45	50	35	M10x25	77.4	26.5
1893319	45	50	40	M10x25	73	26.5
1893281	70	50	40	M10x28	225.3	84.8
1893271	60	50	45	M10x28	149	57.7
1893275	45	50	50	M10x25	70.1	26.5
1893250	60	50	50	M10x25	146	57.7
1893266	70	75	50	M12x37	533.9	190.9