



Part Number : [732841040](#)

Product Description : Standard-Density EMI Filtered D-Sub Connector, Male, Straight, Solder Cup, 4000pF Pi, Locking Inserts, RoHS, 9 Circuits

Series Number : 73284

Status : Active

Product Category : D-Sub Connectors

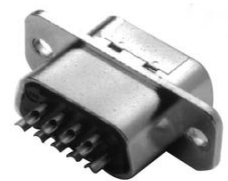

Documents & Resources

Drawings

[732841040 sd.pdf](#)

[STEP AP242](#)

[SOLIDWORKS](#)

[Creo](#)

Product Environment Compliance

Compliance

GADSL/IMDS	Not Relevant
China RoHS	Not Reviewed per SJ/T 11365-2006
EU ELV	Not Relevant
Low-Halogen Status	Not Reviewed per IEC 61249-2-21
REACH SVHC	Not Reviewed per D(2025)4165-DC (25 June 2025)
EU RoHS	Not Reviewed per EU 2015/863

Compliance Statements

- EU RoHS
- REACH SVHC
- Low-Halogen

Industry Documents

- IPC 1752A Class C
- IPC 1752A Class D
- Molex Product Compliance Declaration
- IEC-62474

- chemSHERPA (xml)

Substances of Interest

- PFAS

EU RoHS Certificate of Compliance

Additional Product Compliance Information

Part Details

General

Status	Active
Category	D-Sub Connectors
Series	73284
Description	Standard-Density EMI Filtered D-Sub Connector, Male, Straight, Solder Cup, 4000pF Pi, Locking Inserts, RoHS, 9 Circuits
Application	RF
Component Type	Connector
Product Name	EMI Filtered D-Sub
Type	Standard Density EMI Filtered
UPC	198282531685

Electrical

Current - Maximum per Contact	5.0A
Capacitance Value	4000 pF
Capacitance Tolerance	+ 100 / - 0%
3 dB Cut-off Frequency Max. (MHz)	0.8
Dielectric Withstanding Voltage (V)	150
EMI Filter Circuits	Pi Style
Minimum Insertion Loss (dB) - 1 GHz	70
Minimum Insertion Loss (dB) - 10 MHz	13
Minimum Insertion Loss (dB) - 100 MHz	50
Minimum Insertion Loss (dB) - 20 MHz	20

Minimum Insertion Loss (dB) - 200 MHz	64
Minimum Insertion Loss (dB) - 5 MHz	8
Minimum Insertion Loss (dB) - 50 MHz	37
Minimum Insertion Loss (dB) - 500 MHz	70
Shielded	Yes
Voltage - Maximum	50V DC

Physical

Circuits (Loaded)	9
Circuits (maximum)	9
Color - Resin	Black
Durability (mating cycles max)	500
Gender	Male
Material - Contact	Copper Alloy
Material - Plating Mating	Gold
Material - Plating Termination	Gold
Material - Resin	Polyester
Material - Shell	Zinc
Number of Rows	2
Orientation	Straight
Packaging Type	Tray
Panel Mount	Rear
Panel Mount Method	Hardware
PCB Locator	No
PCB Retention	None
PC Tail Length	N/A
Pitch - Mating Interface	2.77mm
Pitch - Termination Interface	2.77mm
Plating min - Mating	0.380µm
Plating min - Termination	Flash
Plating - Shell	Nickel
Polarized to Mating Part	Yes

Polarized to PCB	Yes
Ports	1
Temperature Range - Operating	-55° to +125°C
Termination Style	Solder Cup
Waterproof / Dustproof	No
Wire Size (AWG)	20

This document was generated on Oct 02, 2025