

Datasheet

RS PRO 3 Way Fuse Terminal Block

ENGLISH

Stock No: 209-7561

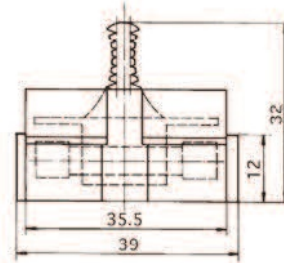
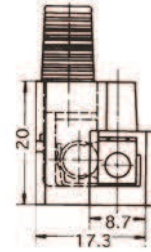
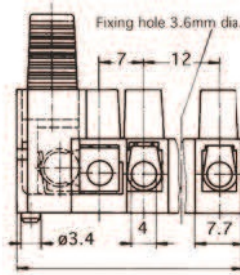
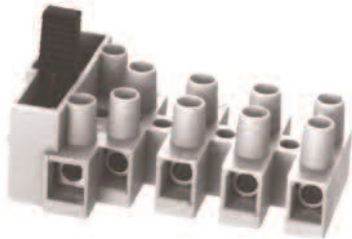

Fused terminal blocks - 1" x 1/4" fuses

FEATURES

Series 1003SI fused terminal blocks are available in unearthed versions from 1 to 5 poles and earthed versions from 3 to 5 poles. A common dovetail enables mixed assemblies to be constructed by clipping on additional 1 pole lengths to provide multiple versions of fused and unfused terminals. All variations can be supplied with or without wire protectors.

Earth Screws & Washers (Optional)
Screws: 1003SIES - M3.5x12, Posi
Washers: 1003SITW - M3.5

Approvals		
Nominal Cross-Section mm ²	4.0	22-10 AWG 16 Amp.
Voltage Rating	V	500 300

TECHNICAL DETAILS

Mouldings:	nylon 6.6, grey, UL94 V2, (fuseholder black)
Inserts:	brass, tinned
Screws:	M3.5 steel, zinc plated, chromed
Screw tightening torque:	max: 0.8 Nm
Temp. limits:	max short term: 160° C continuous: 100° C
Current rating:	to EN 60 127-6: fuseholders: 16A to EN 60 598: terminal blocks: 25A to EN 60 998: terminal blocks: 32A
Voltage rating:	terminal blocks: 500v fuseholders: 250v
Conductor size:	without wire protectors: up to 10mm ² with wire protectors: up to 4mm ²
Wire stripping length:	7.5mm ² - 8.0mm ²
Fuse size:	1" x 1/4" or 1.1/4" x 1/4"
Fixing centres:	peg to earth screw: 18mm peg to fixing hole: 24mm

OPTIONS

Glow wire options available for installations in accordance with EN 60 335-1 upon request.
Marking: special printing available. Please provide sketch.
Fuses
High temperature: details on request.

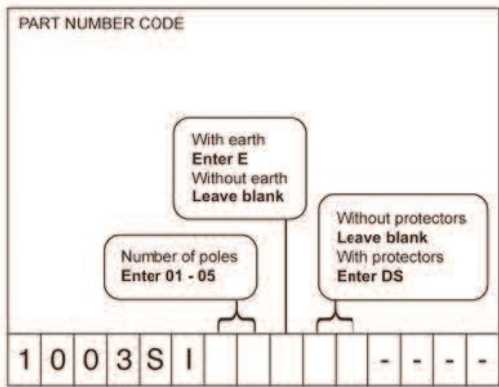

1 0 0 3 S I - - - -