

## FEATURES

- This RS PRO rackmount enclosure is made from high-grade cold-rolled steel, with the front and back panels made from lightweight aluminium
- Each unit offers top, base and side ventilation apertures for optimum cooling, especially when housing electronic equipment or components
- The two-layer front panel has been designed with an adjustable gap (0 – 20 mm)
- The whole enclosure unit is powder-coated following a 5-stage iron phosphate pre-treatment to prevent oxidation and provide longer-lasting protection, especially in harsh environments
- The precise design and high-quality manufacturing standard enables fast and easy assembly while offering complete compatibility with all 19-inch standard equipment
- In addition to this, each unit has 2 extruded aluminium handles and 4 adhesive rubber feet for additional versatility across a wide range of applications
- Gloss black finish for easy cleaning and keeping the surface dust and debris free
- The enclosure unit and accessories supplied with the unit are packed flat for convenient shipment and storage
- Supplied with 4 fitted and 4 loose Board / Chassis plate / Component fixing crossbars
- The PF19 enclosure range is available in a wide variety of sizes

# RS PRO Rackmount Enclosures-Ventilated Rackmount Enclosure

RS Stock No.: 665-7728



RS Professionally Approved Products bring to you professional quality parts across all product categories. Our product range has been tested by engineers and provides a comparable quality to the leading brands without paying a premium price.

## Product Description

### RS PRO PF19 Series Rackmount Enclosure

Introducing the RS PRO PF19 Rackmount Enclosures, a high quality and heavy-duty electronic enclosure series, suitable for a wide range of uses. Constructed from a mixture of high grade rolled steel and lightweight aluminium panels, these rackmount enclosures offer a sturdy construction and combined with the tough powder-coated finish, provide long-lasting life of the product even in harsh environments. The enclosures are easy to use and assemble, thanks to the precision workmanship and well-engineered design. In addition to this, the high-quality materials that are used to manufacture this RS PRO enclosure offer a strong and aesthetically-pleasing finished product, suitable for a wide range of applications both at home or in industry.

## General Specifications

<b>Series</b>	<b>PF-19</b>
<b>Mounting</b>	<b>Rackmount</b>
<b>Rack Units</b>	<b>4U</b>
<b>Material</b>	<b>Steel</b>
<b>Horizontal Pitch</b>	<b>84HP</b>
<b>Ventilated</b>	<b>Yes</b>
<b>Handles</b>	<b>Yes</b>
<b>Colour</b>	<b>Black</b>
<b>For Use With</b>	<b>In outdoor conditions and exposure to the elements</b>
<b>Features</b>	<b>The PF19 enclosure range is available in a wide variety of sizes</b>
<b>Sound Proof</b>	<b>No</b>
<b>Fan Included</b>	<b>No</b>

## Mechanical Specifications

<b>Dimension</b>	<b>177 x 482.6 x 335mm</b>
<b>Height</b>	<b>177mm</b>
<b>Depth</b>	<b>335mm</b>
<b>Width</b>	<b>482.6mm</b>

## Approvals

<b>Declarations</b>	<b>RoHS Certificate of Compliance</b>
---------------------	---------------------------------------

## Similar Products

Stock No.	Brand	Product Name	Material	Dimension	Rack Units
6657700	RS PRO	Ventilated Rackmount Enclosure	Steel	43.7 x 482.6 x 245mm	1U
6657712	RS PRO	Ventilated Rackmount Enclosure	Steel	88.1 x 482.6 x 335mm	2U

Accessories / Dimension Drawing / Top View / Front View / Side View

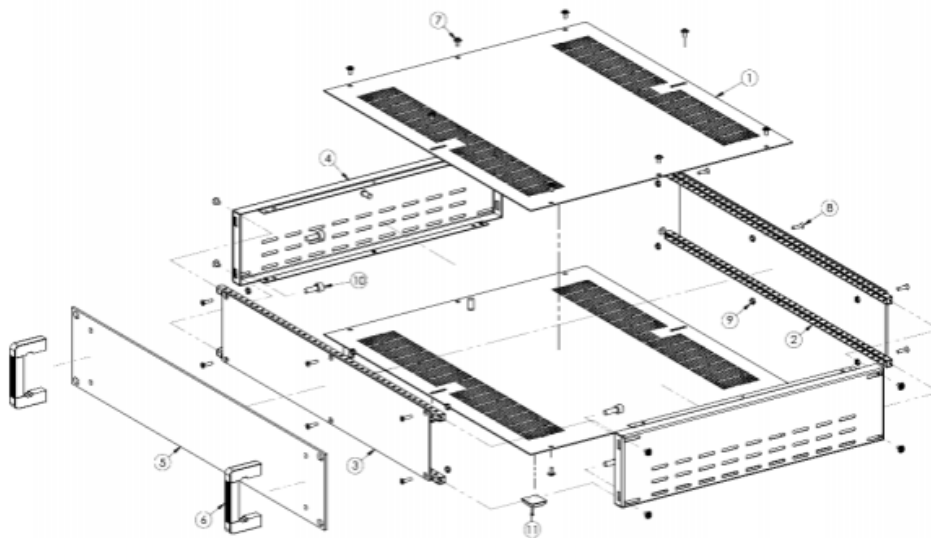

### PF 19 inches Part List :

Item	Material	Contents of Kit					
		1U	2U	3U	4U	5U	6U
1. Top / Base Panel	Mild steel 1.2 MM	2	2	2	2	2	2
2. General Purpose Bar (90mm/other models)	Zinc plate steel 0.9 MM	4/8	8	8	8	8	8
3. Inside Front/ Rear Panel	AL (0.9/1.2 MM)	2 (0.9)	2 (0.9)	2(1.2)	2(1.2)	2(1.2)	2(1.2)
4. Side Panel	Mild Steel 0.9 MM	2	2	2	2	2	2
5. Front Panel	AL 3.0 MM	1	1	1	1	1	1
6. Handle	AL extruded	2	2	2	2	2	2
7. Umbrella Phillips screw	M3x6	28	28, 32	16	16	16	16
8. Umbrella Phillips screw	M4x8	-	-	16	16	16	16
9. Flat Head screw	M3x12 with nut	12	12	-	-	-	-
10. Flat Head screw	M3x15	-	-	12	12	12	12
11. Round Head screw	M5x15 with nut	-	4	4	4	4	4
12. Hex screw	M5x15 with nut	4	-	-	-	-	-

**Note :** Torque 7 in lbs for screw M3  
Torque 10 in lbs for screw M4

## Available Dimensions :

There are 24 different sizes and configurations which are available in :

- Height : 1.5U to 6U (B)
- Width : 482 (A)
- Depth : 90, 245, 335, 425 and 465 (D)

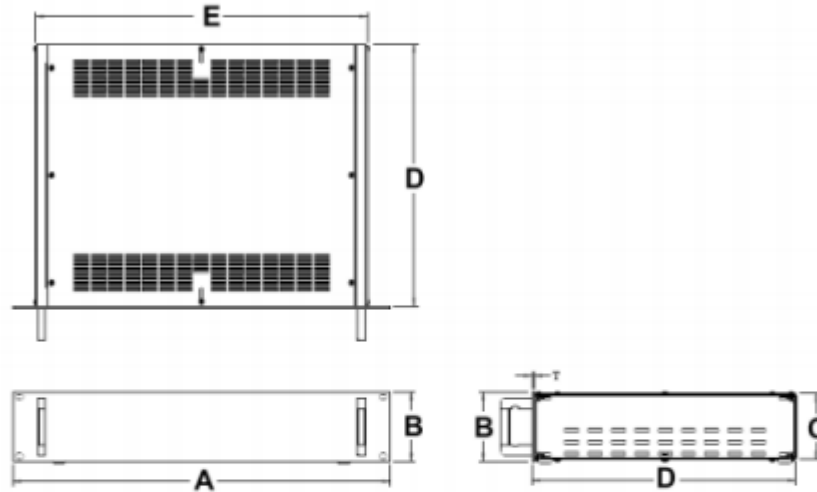

RS Stock No.	Model	Front Panel (A x B)	Handle Height	Cabinet (E x D x C)
665-7706	1U-D0	483 x 44	25	425x90x39 mm
665-7700	1U-D1	483 x 44	25	425x245x39 mm
665-7719	2U-D1	483 x 88	60	425x245x83 mm
665-7712	2U-D2	483 x 88	60	425x335x83 mm
665-7716	3U-D2	483 x 133	90	425x335x128 mm
665-7725	3U-D3	483 x 133	90	425x425x128 mm
665-7728	4U-D2	483 x 177	130	425x335x172 mm
665-7722	4U-D3	483 x 177	130	425x425x172 mm
665-7731	5U-D3	483 x 222	130	425x425x217 mm
665-7734	6U-D3	483 x 266	130	425x425x261 mm
665-7738	6U-D4	483 x 266	130	425x465x261 mm