

EV-T2SOCR-B-WL-C - Protective cover



1527521

<https://www.phoenixcontact.com/gb/products/1527521>

Please be informed that the data shown in this PDF document is generated from our online catalog. Please find the complete data in the user documentation. Our general terms of use for downloads are valid.



CHARX connect modular, Type 2, Protective cover, Accessories, Basic, circular, Front mounting, M5 thread, with self-locking mechanism, with marking C, for attaching to infrastructure charging sockets, Lasered C marking according to DIN EN 17186 instead of a logo, IEC 62196-2

Product description

Self-closing protective cover for infrastructure charging socket

Your advantages

- Developed and produced in accordance with the IATF 16949 automotive standard and ISO 9001
- Individual branding, thanks to the use your own logo
- Reliable protection of your socket outlet from weather and vandalism

Commercial data

Item number	1527521
Packing unit	1 pc
Minimum order quantity	1 pc
Sales key	XWBAFC
Product key	XWBAFC
GTIN	4063151995393
Weight per piece (including packing)	99.5 g
Weight per piece (excluding packing)	99.5 g
Customs tariff number	39269097
Country of origin	DE

EV-T2SOCR-B-WL-C - Protective cover



1527521

<https://www.phoenixcontact.com/gb/products/1527521>

Technical data

Product properties

Product type	Protective cover for Socket Outlet
Product family	CHARX connect modular
Application	for attaching to infrastructure charging sockets
Design (Protective cover)	circular
Type	Accessories
	Basic
Design	with self-locking mechanism
	with marking C
Compatibility	compatible with shutter, see accessories
Affixed logo	Lasered C marking according to DIN EN 17186 instead of a logo
Charging standard	Type 2
Charging mode	Mode 3, Case B
Customer variations	On request

Dimensions

Protective cover

Dimensional drawing	
Depth	22.9 mm
Diameter	109.2 mm

Bore dimensions

Dimensional drawing	
Width	60 mm
Height	60 mm

Material specifications

Color (Protective cover)	black (9005)
Material (Protective cover)	Plastic

Mechanical properties

EV-T2SO-CR-B-WL-C - Protective cover



1527521

<https://www.phoenixcontact.com/gb/products/1527521>

Type of cover movement	Self-locking
------------------------	--------------

Environmental and real-life conditions

Ambient conditions

Degree of protection (Protective cover)	IP54
	IK08
Ambient temperature (operation)	-30 °C ... 50 °C
Ambient temperature (storage/transport)	-40 °C ... 80 °C
Altitude	5000 m (above sea level)

Standards and regulations

Standards

Standards/regulations	IEC 62196-2
-----------------------	-------------

Mounting

Mounting type Protective cover	Front mounting (rear screw connection)
Fixing screws	M5 thread

EV-T2SOOCR-B-WL-C - Protective cover

1527521

<https://www.phoenixcontact.com/gb/products/1527521>



Drawings

Dimensional drawing

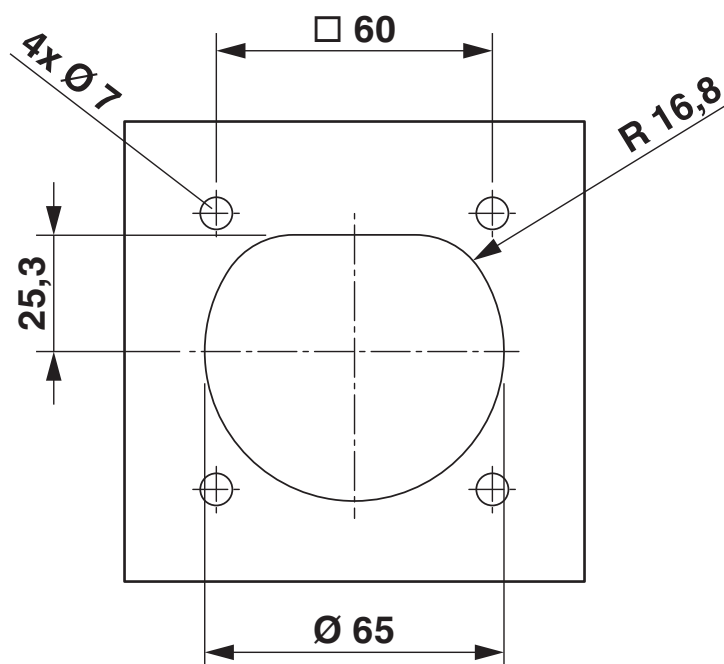

Dimensional drawing

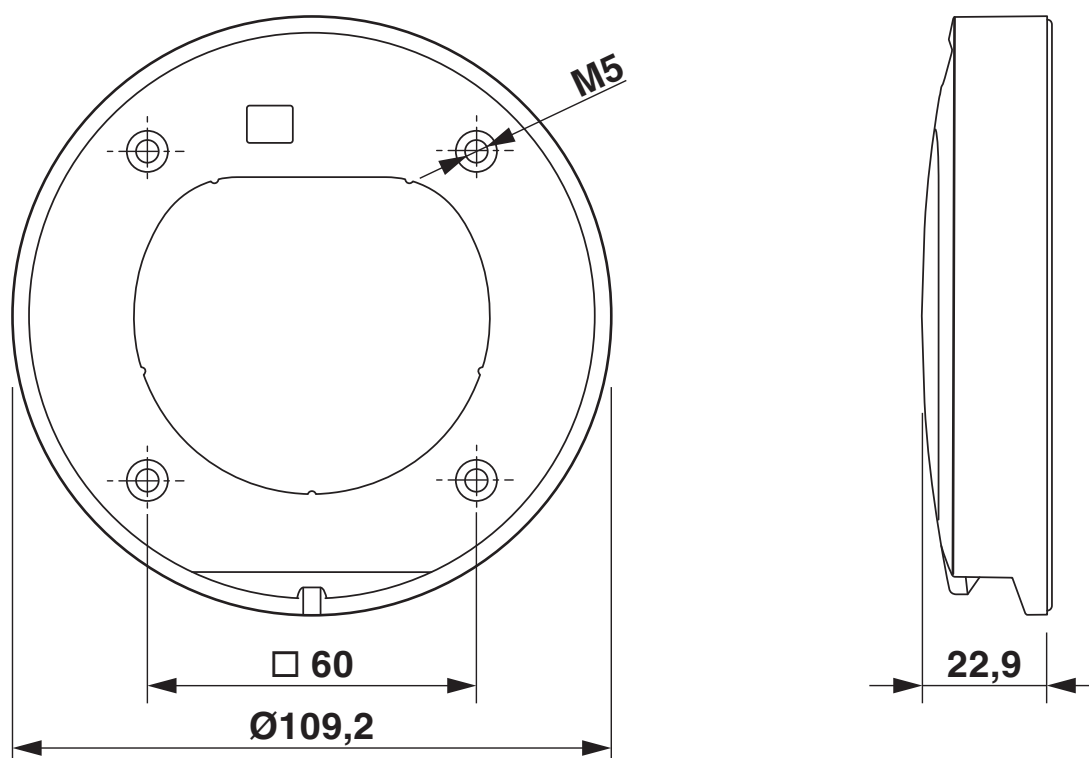

EV-T2SOCR-B-WL-C - Protective cover

1527521

<https://www.phoenixcontact.com/gb/products/1527521>



Exploded view

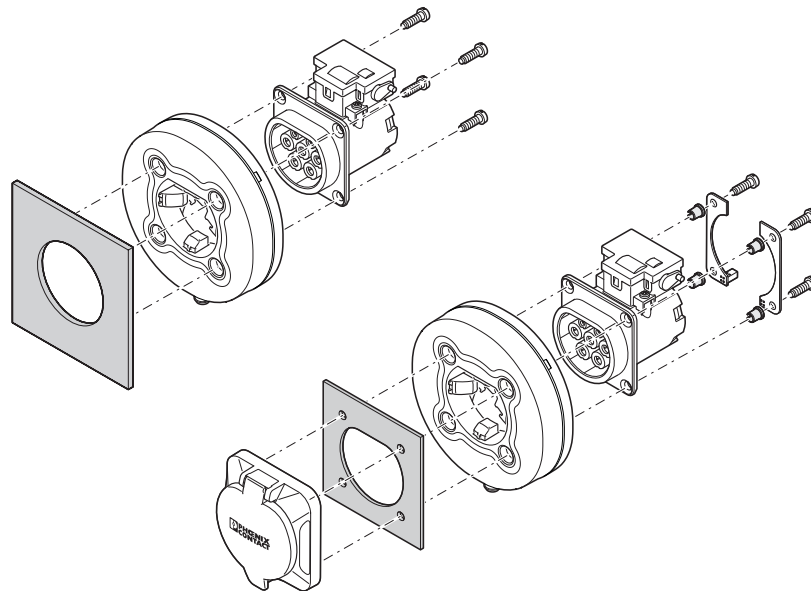

Rear mounting

EV-T2SOCR-B-WL-C - Protective cover



1527521

<https://www.phoenixcontact.com/gb/products/1527521>

Classifications

ECLASS

ECLASS-13.0	27144792
-------------	----------

ETIM

ETIM 9.0	EC002884
----------	----------

EV-T2SOCCR-B-WL-C - Protective cover



1527521
<https://www.phoenixcontact.com/gb/products/1527521>

Environmental product compliance

EU RoHS	
Fulfills EU RoHS substance requirements	Yes, No exemptions
EU REACH SVHC	
REACH candidate substance (CAS No.)	No substance above 0.1 wt%

Phoenix Contact 2025 © - all rights reserved
<https://www.phoenixcontact.com>

PHOENIX CONTACT Ltd
Halesfield 13, Telford
Shropshire, TF7 4PG
01952 681700
info@phoenixcontact.co.uk