

Ordering number CA13307_LAURA-O-WAS-PIN

Family	Laura	FWHM	Asym degrees
Type	Assembly	Efficiency	84 %
LED	Oslon SSL 150	cd/lm	3.100
Color	White	Gerber File	Available
Diameter	21.6x21.6 mm		
Height	13.1 mm		
Style	Square		
Optic Material	PMMA		
Holder Material	PC		
Fastening	Pin, tape		
Status	Ready		

Ordering number CP13308_LAURA-O-WAS-PG

Family	Laura	FWHM	Asym degrees
Type	Assembly	Efficiency	84 %
LED	Oslon SSL 150	cd/lm	3.100
Color	White	Gerber File	Available
Diameter	21.6x21.6 mm		
Height	12.9 mm		
Style	Square		
Optic Material	PMMA		
Holder Material	PC		
Fastening	Pin, glue		
Status	Ready		

Ordering number CP13311_LAURA-SS-WAS-PG

Family	Laura	FWHM	Asym degrees
Type	Assembly	Efficiency	90 %
LED	Oslon SSL 150	cd/lm	12.200
Color	White	Gerber File	Available
Diameter	21.6x21.6 mm		
Height	12.9 mm		
Style	Square		
Optic Material	PMMA		
Holder Material	PC		
Fastening	Pin, glue		
Status	Ready		

Ordering number CA13312_LAURA-SS-WAS-PIN

Family	Laura	FWHM	Asym degrees
Type	Assembly	Efficiency	90 %
LED	Oslon SSL 150	cd/lm	12.200
Color	White	Gerber File	Available
Diameter	21.6x21.6 mm		
Height	13.1 mm		
Style	Square		
Optic Material	PMMA		
Holder Material	PC		
Fastening	Pin, tape		
Status	Ready		

Ordering number CA11959_LAURA-RS-PIN

Family	Laura	FWHM	7 degrees
Type	Assembly	Efficiency	92 %
LED	Oslon SSL 150	cd/lm	42.000
Color	White	Gerber File	Available
Diameter	21.6 x 21.6 mm		
Height	13.1 mm		
Style	Square		
Optic Material	PMMA		
Holder Material	PC		
Fastening	Pin, tape		
Status	Ready		

Ordering number CA12011_LAURA-SS-PIN

Family	Laura	FWHM	11 degrees
Type	Assembly	Efficiency	91 %
LED	Oslon SSL 150	cd/lm	12.500
Color	White	Gerber File	Available
Diameter	21.6 + 21.6 mm		
Height	13.1 mm		
Style	Square		
Optic Material	PMMA		
Holder Material	PC		
Fastening	Pin, tape		
Status	Ready		

Ordering number CA11960_LAURA-D-PIN

Family	Laura	FWHM	12 degrees
Type	Assembly	Efficiency	83 %
LED	Oslon SSL 150	cd/lm	8.900
Color	White	Gerber File	Available
Diameter	21.6 + 21.6 mm		
Height	13.1 mm		
Style	Square		
Optic Material	PMMA		
Holder Material	PC		
Fastening	Pin, tape		
Status	Ready		

Ordering number CA11837_LAURA-M-PIN

Family	Laura	FWHM	26 degrees
Type	Assembly	Efficiency	87 %
LED	Oslon SSL 150	cd/lm	2.720
Color	White	Gerber File	Available
Diameter	21.6 mm		
Height	13.1 mm		
Style	Square		
Optic Material	PMMA		
Holder Material	PC		
Fastening	Pin, tape		
Status	Ready		

Ordering number CA12344_LAURA-W-PIN

Family	Laura	FWHM	34 degrees
Type	Assembly	Efficiency	85 %
LED	Oslon SSL 150	cd/lm	-
Color	White	Gerber File	Available
Diameter	21.6 + 21.6 mm		
Height	13.1 mm		
Style	Square		
Optic Material	PMMA		
Holder Material	PC		
Fastening	Pin, tape		
Status	Ready		

Ordering number CA12012_LAURA-O-PIN

Family	Laura	FWHM	36+10 degrees
Type	Assembly	Efficiency	86 %
LED	Oslon SSL 150	cd/lm	4.440
Color	White	Gerber File	Available
Diameter	21.6 + 21.6 mm		
Height	13.1 mm		
Style	Square		
Optic Material	PMMA		
Holder Material	PC		
Fastening	Pin, tape		
Status	Ready		

NOTE: The typical divergence will be changed by different color, chip size and chip position tolerance. The typical total divergence is the full angle measured where the luminous intensity is half of the peak value.



PRODUCT DATASHEET

Laura series

last update 11/10/2012



GENERAL INFORMATION

- Product series especially designed & optimized for Oslon SSL 150 series of LEDs.
- Special care taken to make light distribution as uniform as possible.
- Lens material optical grade PMMA with high UV and temperature resistance. Allows use of high current and temperature conditions.

Please find more information about used material from below:

http://ledil.fi/sites/default/files/Documents/Technical/Material/PMMA%20N%20UL94_Yellow%20Card.pdf

<http://ledil.fi/sites/default/files/Documents/Technical/Material/PMMA%20N%20PLEXIGLAS-Datasheet.pdf>

- Optic holder molded by high quality PC material (120 degrees of Celcius / 248 degrees of Fahrenheit).

Relative intensity of LAURA-O-PIN-OSL150

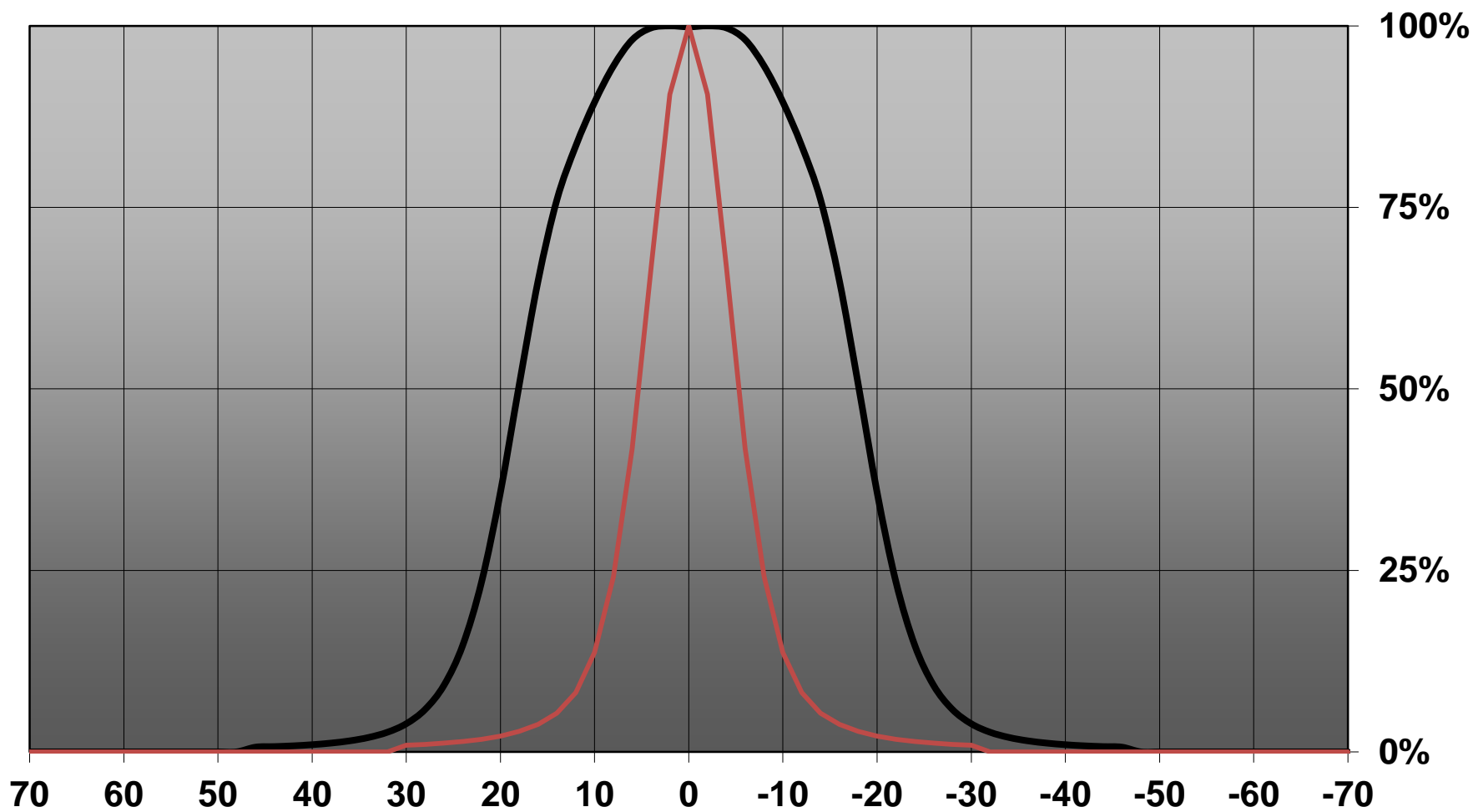

D

C

B

A

4

4

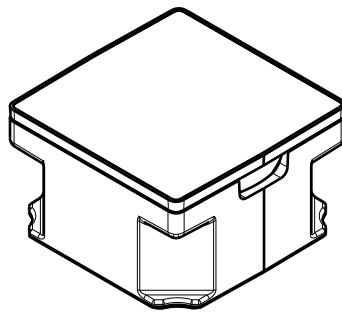

Isometric view

3

3

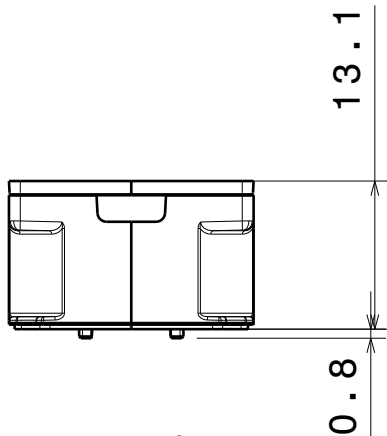

Front view

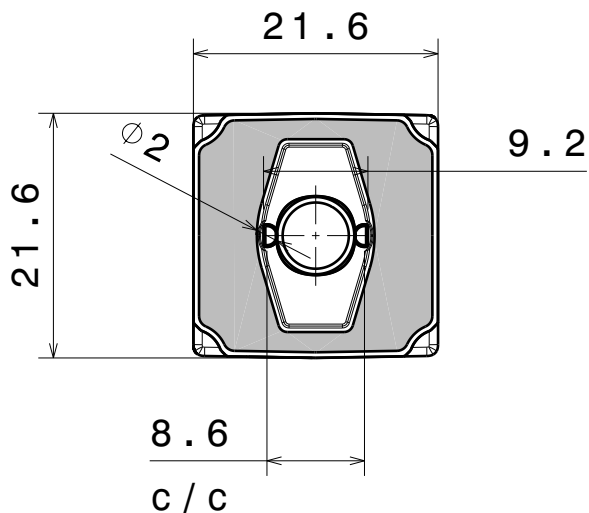

Bottom view

2

2

Tolerances if not otherwise shown
 According to DIN ISO 2768-1
 Linear measures:
 Up to 30mm class F, otherwise class M.
 According to DIN ISO 2768-2
 Form and position: class K

LEDiL Ledil Oy
 Salorankatu 10
 FIN 24240 SALO
 Finland

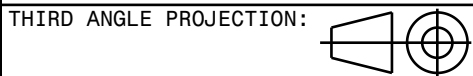

DRAWING TITLE
LAURA-WAS-PIN-TAPE

This drawing is the property of LEDiL Oy. It may not be reproduced, copied or communicated without a written agreement with LEDiL Oy."

SIZE	PART NUMBER		
A4	-		
SCALE	3:2	WEIGHT	-
		SHEET	1/1

1

1

D

A

Luminaire: Ledil Oy CP13308&CA13307_LAURA-O-WAS-OSL150 (Osram oslon 150deg 95lm @ 250mA) Efficiency=84%
Lamps: 1 x Osram oslon 150deg 95lm @ 250mA

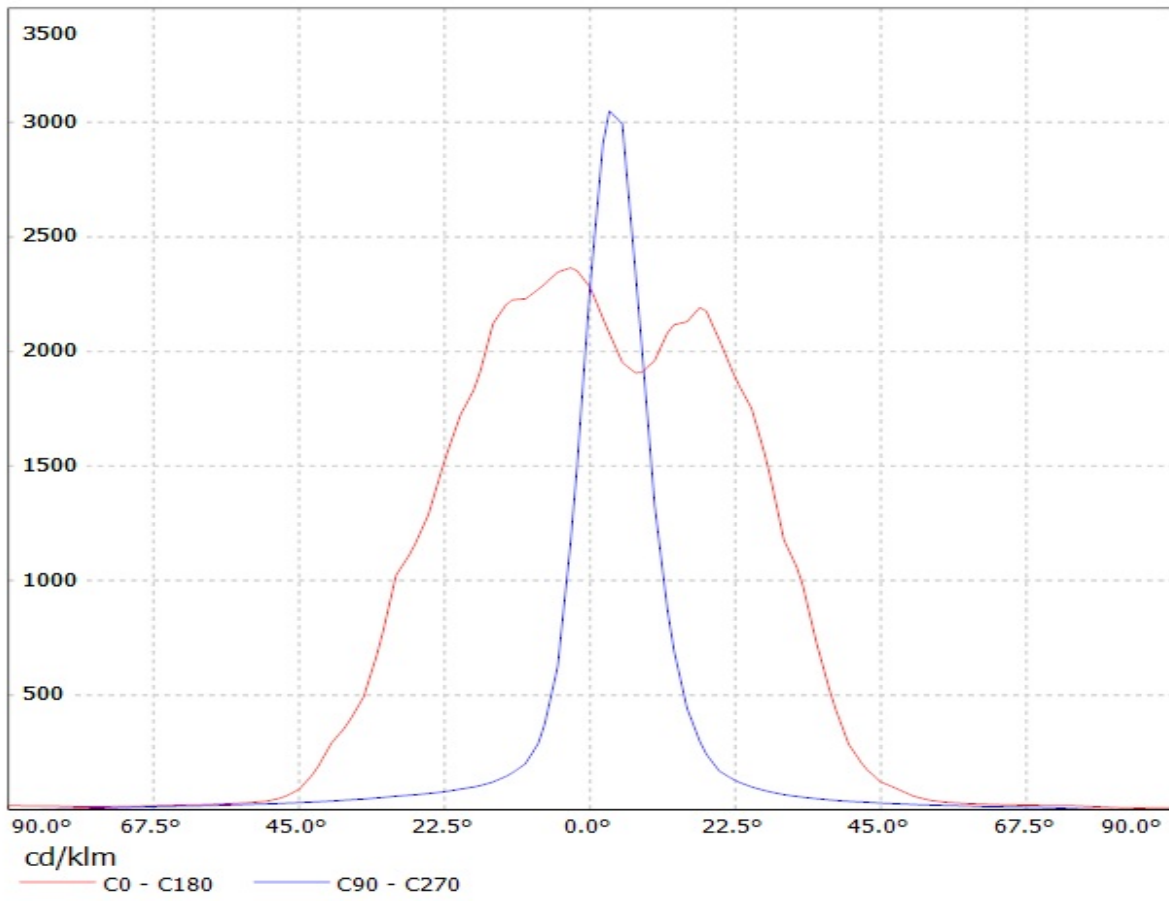

Luminaire: Ledil Oy CP13308&CA13307_LAURA-O-WAS-OSL150 (Osram oslon 150deg 95lm @ 250mA) Efficiency=84%
Lamps: 1 x Osram oslon 150deg 95lm @ 250mA

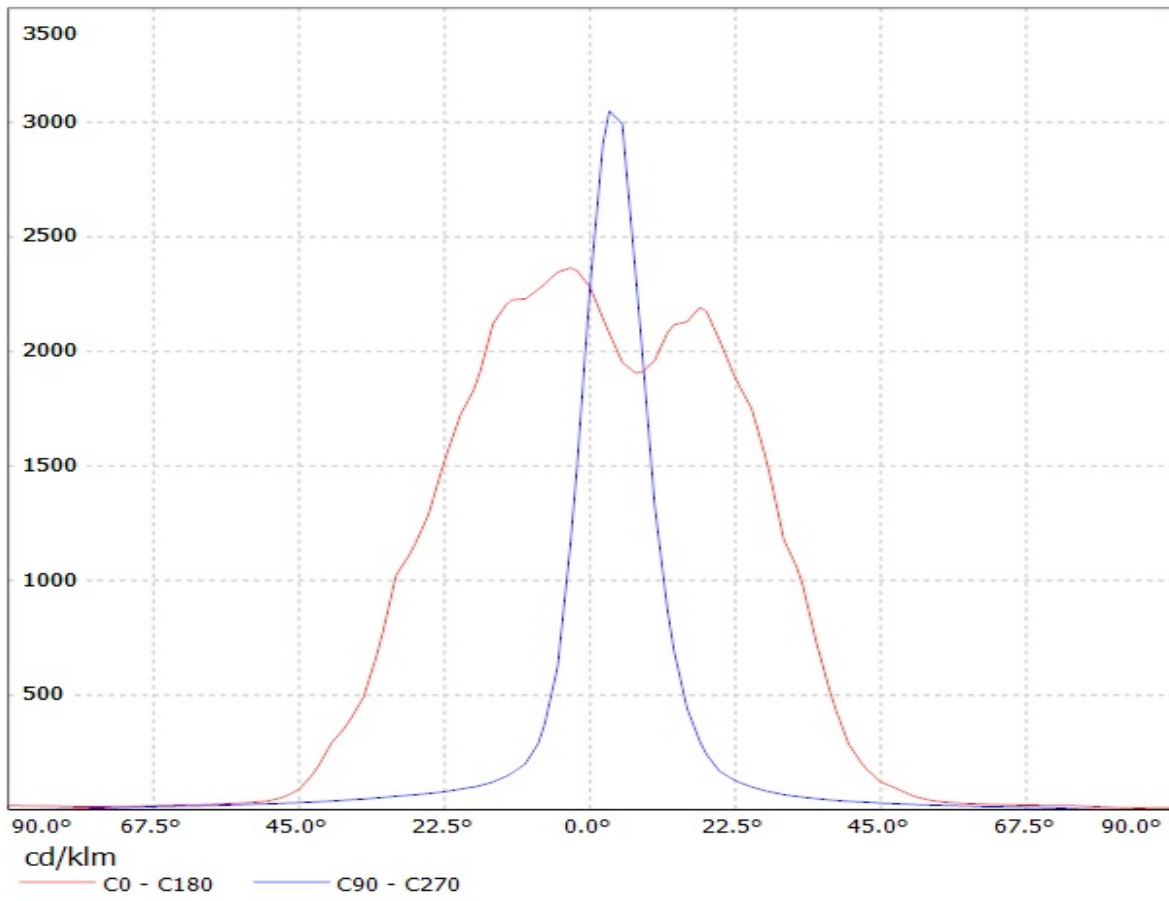

Luminaire: Ledil Oy CP13311&CA13312_LAURA-SS-WAS (OSram OSL150 95lm @ 250mA) Efficiency=90%
Lamps: 1 x OSram OSL150 95lm @ 250mA

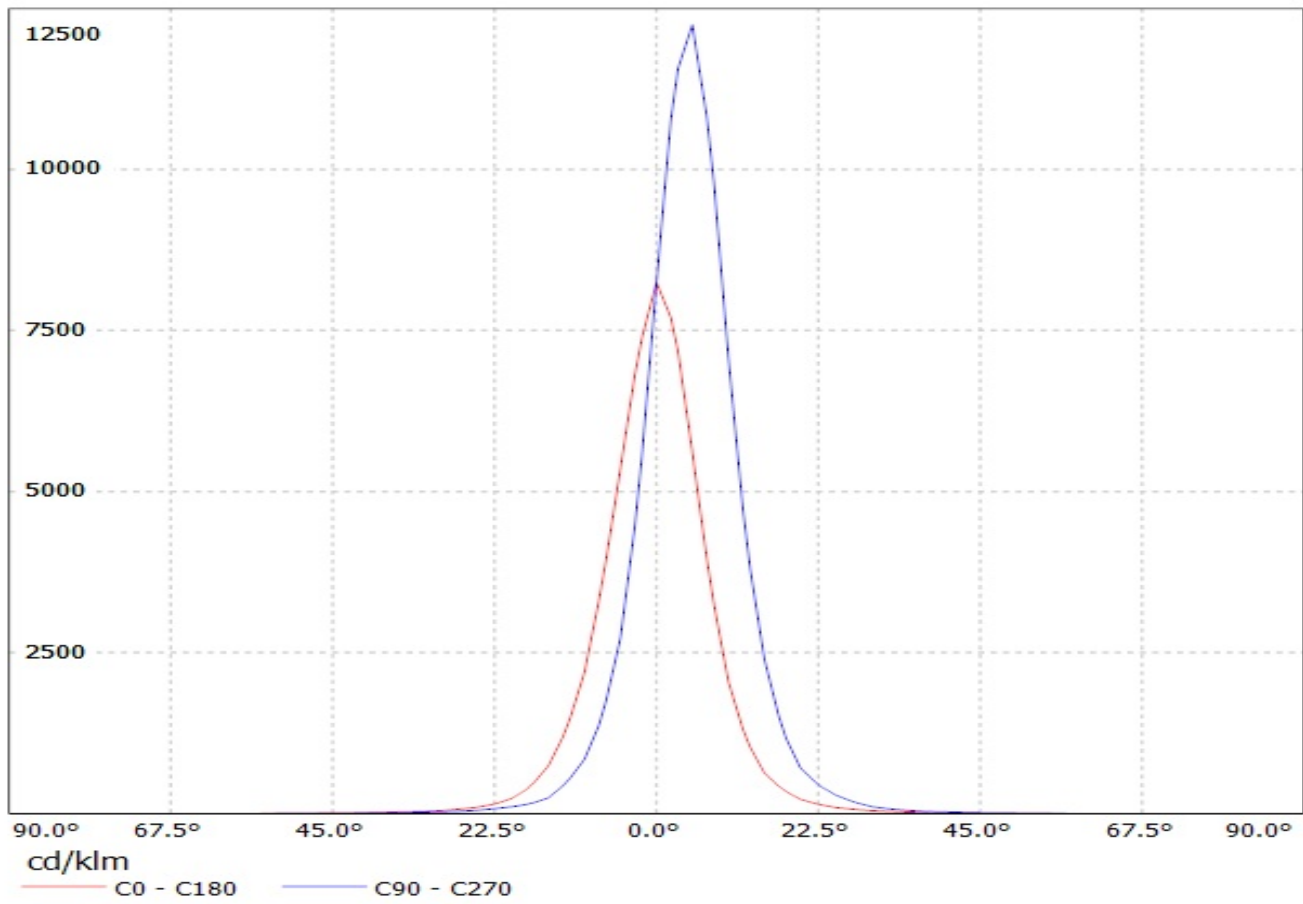

Luminaire: Ledil Oy CP13311&CA13312_LAURA-SS-WAS (OSram OSL150 95lm @ 250mA) Efficiency=90%
Lamps: 1 x OSram OSL150 95lm @ 250mA

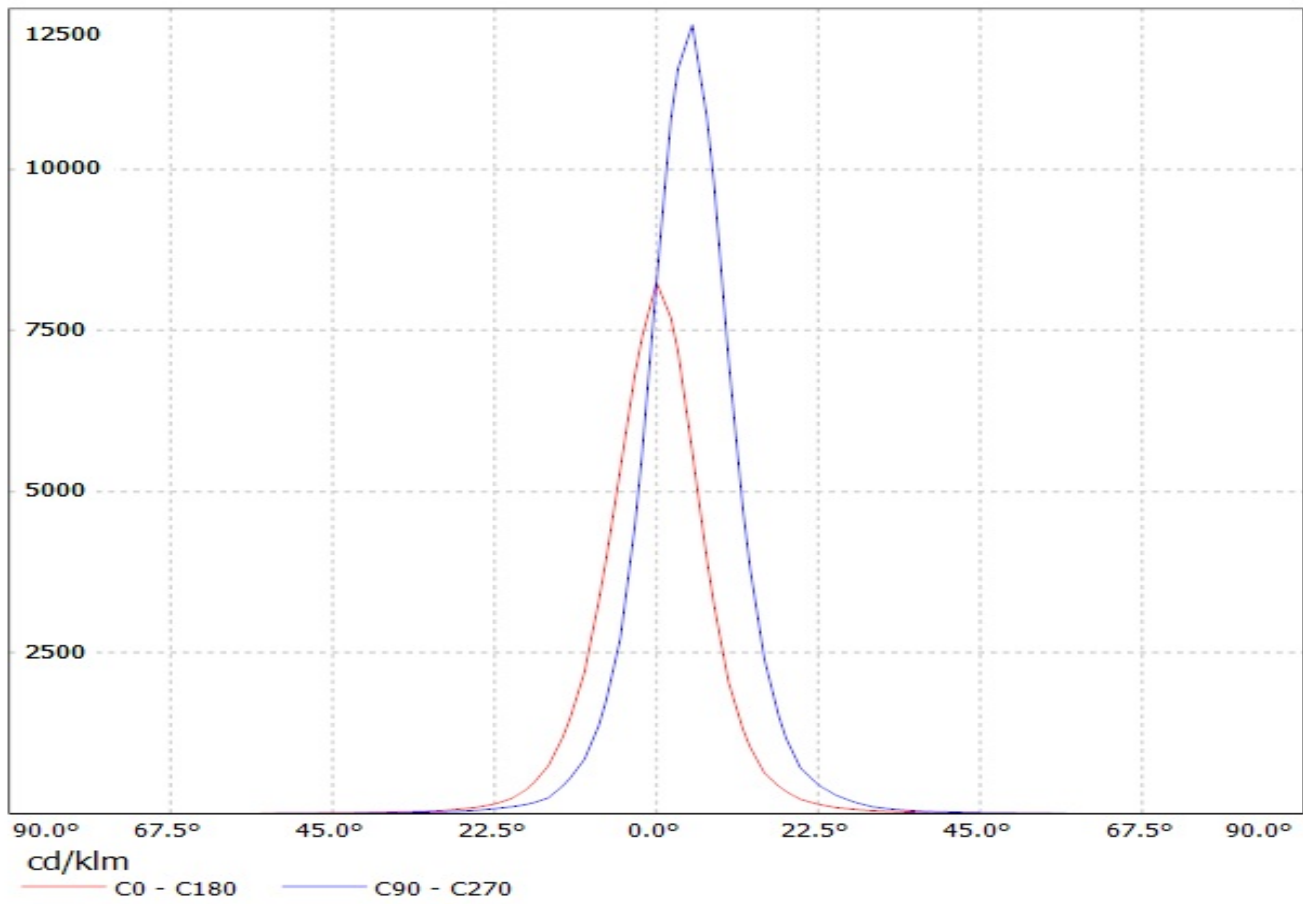

Luminaire: LEDIL OY CA11959_LAURA-RS-PIN (SSL150) Efficiency=92%
Lamps: 1 x Osram Oslon SSL150 (95lm@250mA)

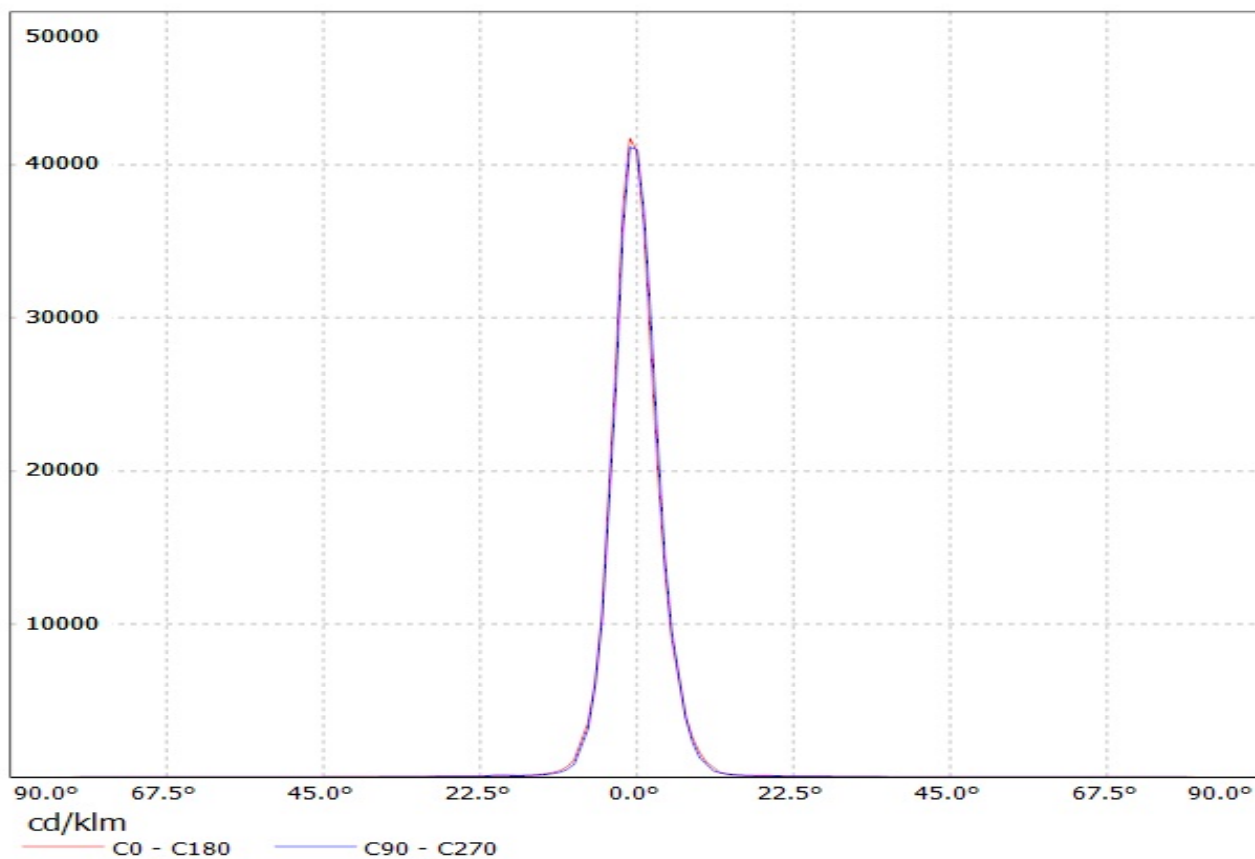

Luminaire: Ledil Oy CP13308&CA13307_LAURA-O-WAS-OSL150 (Osram oslon 150deg 95lm @ 250mA) Efficiency=84%
Lamps: 1 x Osram oslon 150deg 95lm @ 250mA

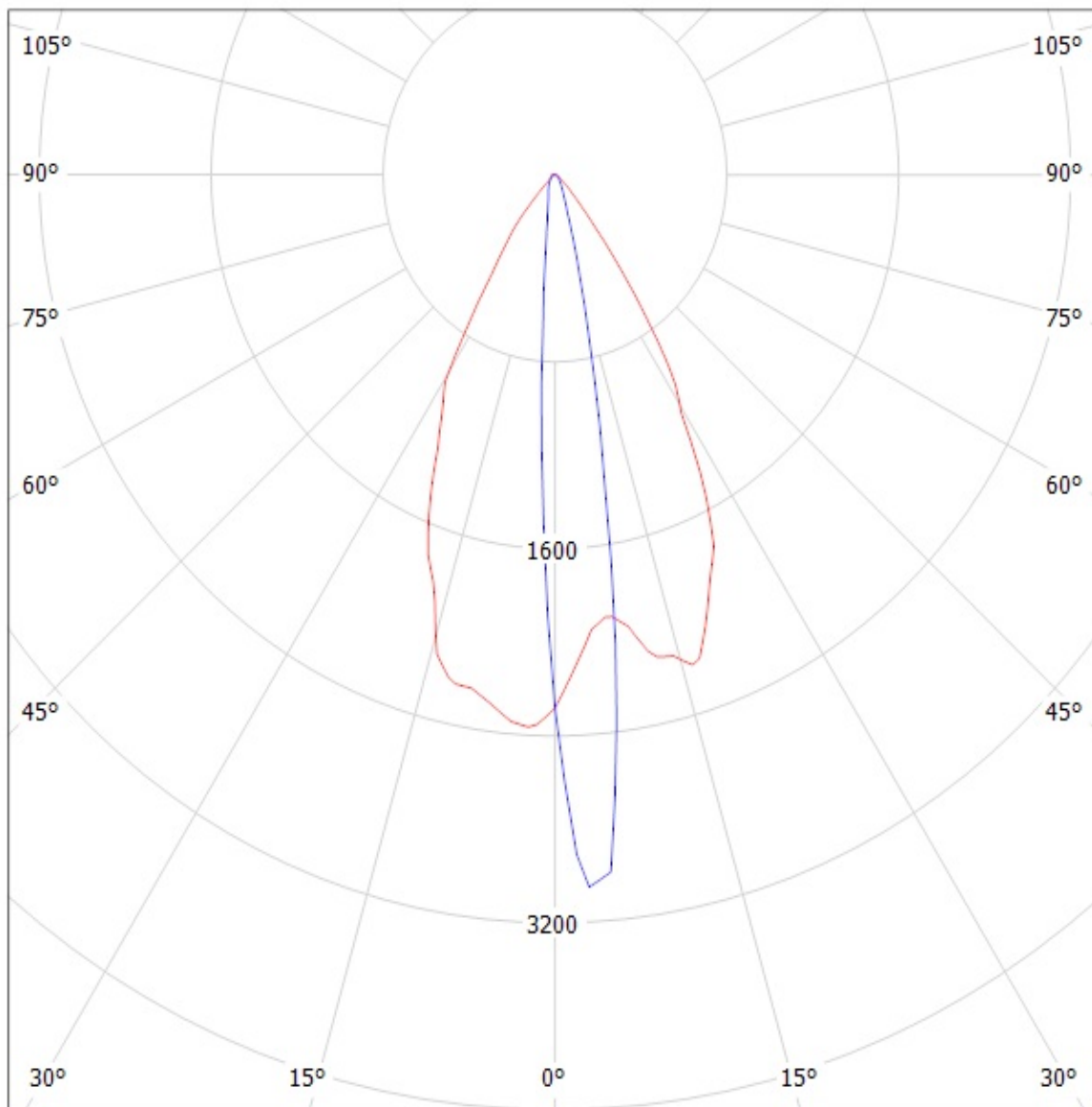

cd/klm

— C0 - C180 — C90 - C270

Luminaire: Ledil Oy CP13308&CA13307_LAURA-O-WAS-OSL150 (Osram oslon 150deg 95lm @ 250mA) Efficiency=84%
Lamps: 1 x Osram oslon 150deg 95lm @ 250mA

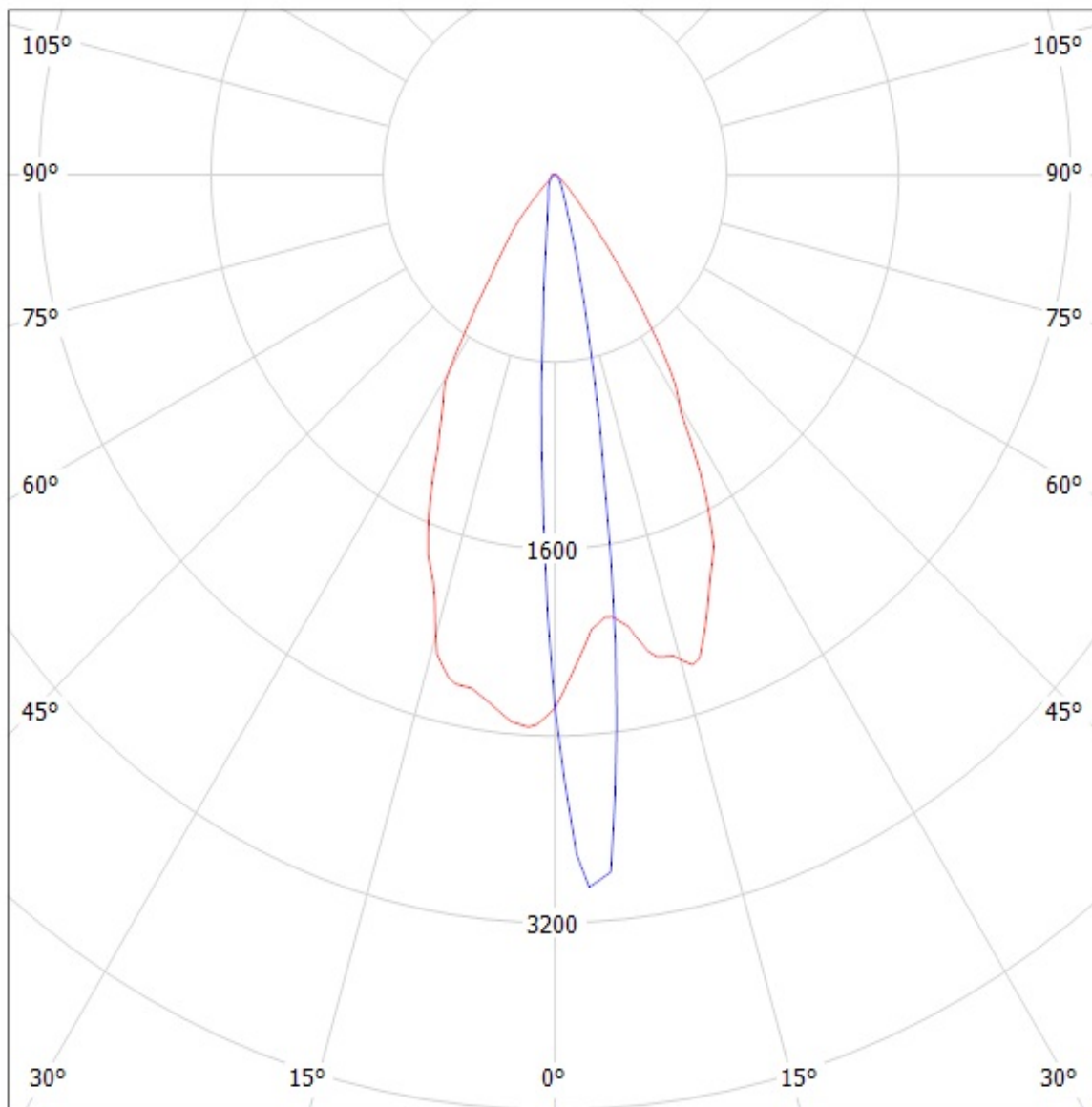

cd/klm

— C0 - C180 — C90 - C270

Luminaire: Ledil Oy CP13311&CA13312_LAURA-SS-WAS (OSram OSL150 95lm @ 250mA) Efficiency=90%
Lamps: 1 x OSram OSL150 95lm @ 250mA

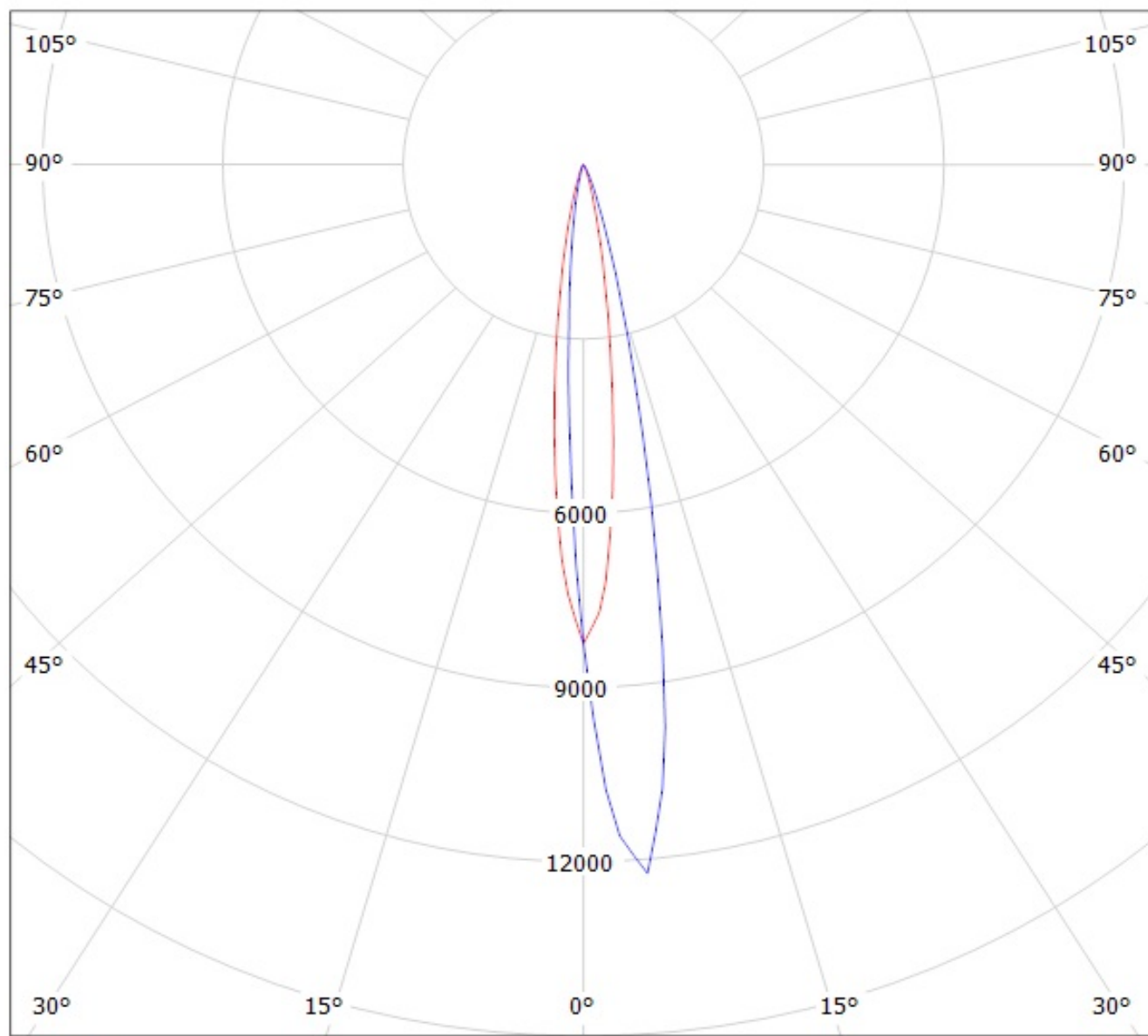

cd/klm

— C0 - C180

— C90 - C270

Luminaire: Ledil Oy CP13311&CA13312_LAURA-SS-WAS (OSram OSL150 95lm @ 250mA) Efficiency=90%
Lamps: 1 x OSram OSL150 95lm @ 250mA

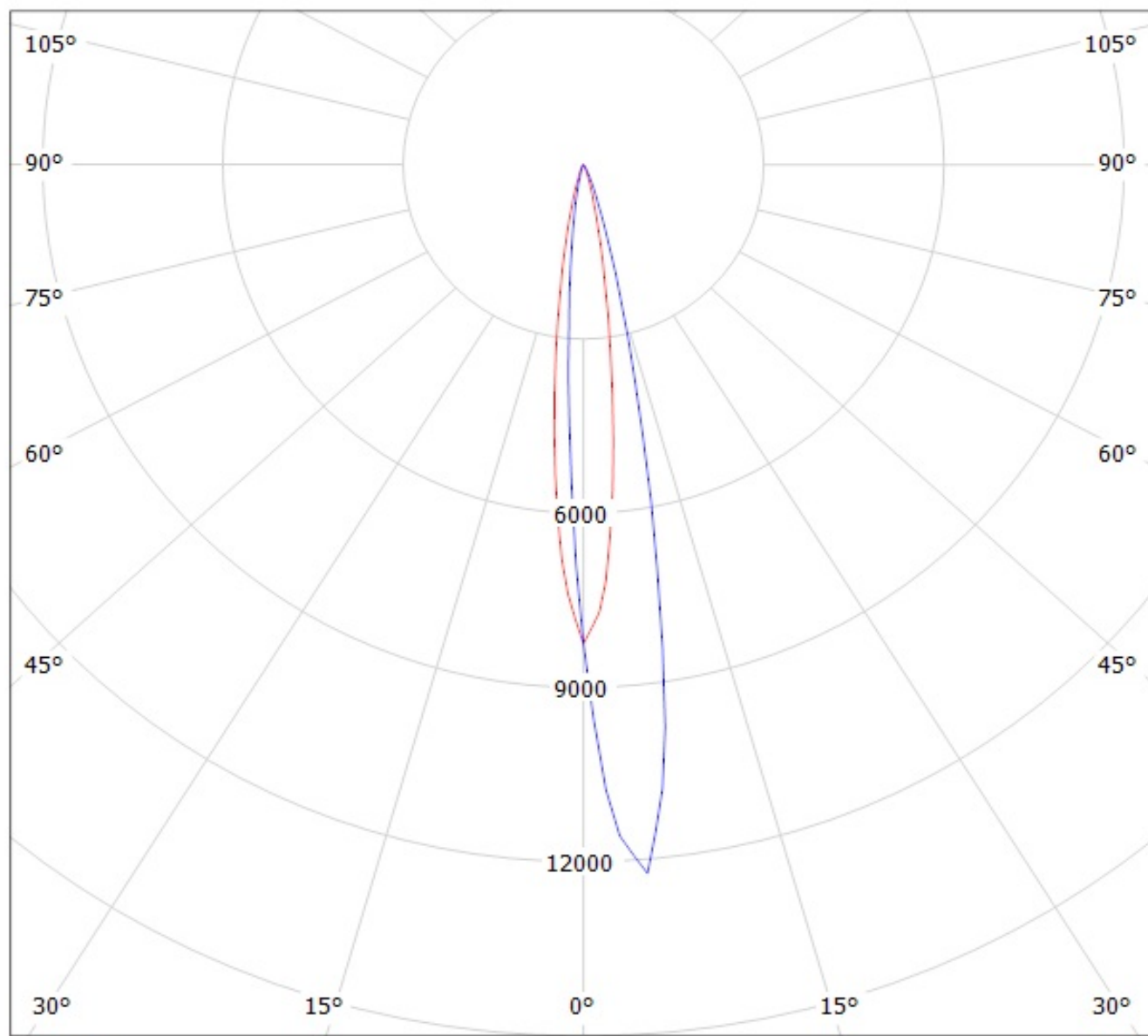

cd/klm

— C0 - C180

— C90 - C270

Luminaire: LEDIL OY CA11959_LAURA-RS-PIN (SSL150) Efficiency=92%
Lamps: 1 x Osram Oslon SSL150 (95lm@250mA)

