

PNEUMATIC TIME-RELAY BLOCK ON-DELAY 0.1 ...
30S 1NO + 1NC, FOR MOTOR CONTACTORS SZ S0



General technical data:

product brand name		SIRIUS
Product designation		pneumatic delay block
Design of the product		slow-operating
Size of contactor		S0
Ambient temperature		
• during storage	°C	-50 ... +80
• during operation	°C	-25 ... +60
Protection class IP on the front		IP20
Mechanical service life (switching cycles) typical		5 000 000
Electrical endurance (switching cycles) at AC-15 at 230 V typical		1 000 000
Mechanical service life (switching cycles)		
• with 3RT2.2 contactor		5 000 000
• with 3RT2.3 contactor		5 000 000
Adjustable pickup delay time	s	30 ... 0.1
Insulation voltage with degree of pollution 3 rated value	V	690

Relative accuracy of the operating delay time/backslide delay time	%	10
--	---	----

Auxiliary circuit:

Operating current

<ul style="list-style-type: none"> • of auxiliary contacts <ul style="list-style-type: none"> — at AC-12 maximum — at AC-14 <ul style="list-style-type: none"> — at 230 V — at 400 V — at 500 V — at 690 V — at AC-15 <ul style="list-style-type: none"> — at 230 V — at 400 V — at DC-13 <ul style="list-style-type: none"> — at 24 V — at 48 V — at 110 V — at 220 V — at 440 V • at AC-15 <ul style="list-style-type: none"> — at 500 V rated value — at 690 V rated value 	A	10
	A	6
	A	4
	A	2.5
	A	1.5
	A	6
	A	4
	A	4
	A	2
	A	0.7
	A	0.3
	A	0.1
	A	2.5
	A	1.5

Short-circuit:

Design of the fuse link for short-circuit protection of the auxiliary switch required	Fuse gG 10 A with short-circuit current $I_k = 1$ kA according to IEC 60947-5-1
--	---

Installation/ mounting/ dimensions:

Mounting type		clip-on
Width	mm	45
Height	mm	44.6
Depth	mm	83.5
Mounting position		any





Connections/ Terminals:

Type of electrical connection for auxiliary and control current circuit		screw-type terminals
Type of connectable conductor cross-sections		
<ul style="list-style-type: none"> • for auxiliary contacts <ul style="list-style-type: none"> — solid — finely stranded <ul style="list-style-type: none"> — with core end processing • at AWG conductors for auxiliary contacts 		2x (0.5 ... 2.5 mm ²), 2x (2.5 ... 4 mm ²)
		2x (0.5 ... 2.5 mm ²)
		2x (22 ... 12)

Certificates/ approvals:



Certificate of suitability

CE / UL / CSA / CCC

General Product Approval		Declaration of Conformity	Test Certificates	Shipping Approval
 CCC		 UL	 EG-Konf.	spezielle Prüfbescheinigungen  ABS

Shipping Approval



Shipping Approval	other	Railway
 RMRS	Bestätigungen Umweltbestätigung	 VDE Schwingen/Schocke n

Safety related data:

Protection against electrical shock

finger-safe

Further information

Information- and Downloadcenter (Catalogs, Brochures,...)

<http://www.siemens.com/industrial-controls/catalogs>

Industry Mall (Online ordering system)

<http://www.siemens.com/industrymall>

Cax online generator

<http://support.automation.siemens.com/WW/CAXorder/default.aspx?lang=en&mlfb=3RT29262PA01>

Service&Support (Manuals, Certificates, Characteristics, FAQs,...)

<https://support.industry.siemens.com/cs/ww/en/ps/3RT29262PA01>

Image database (product images, 2D dimension drawings, 3D models, device circuit diagrams, EPLAN macros, ...)

http://www.automation.siemens.com/bilddb/cax_de.aspx?mlfb=3RT29262PA01&lang=en

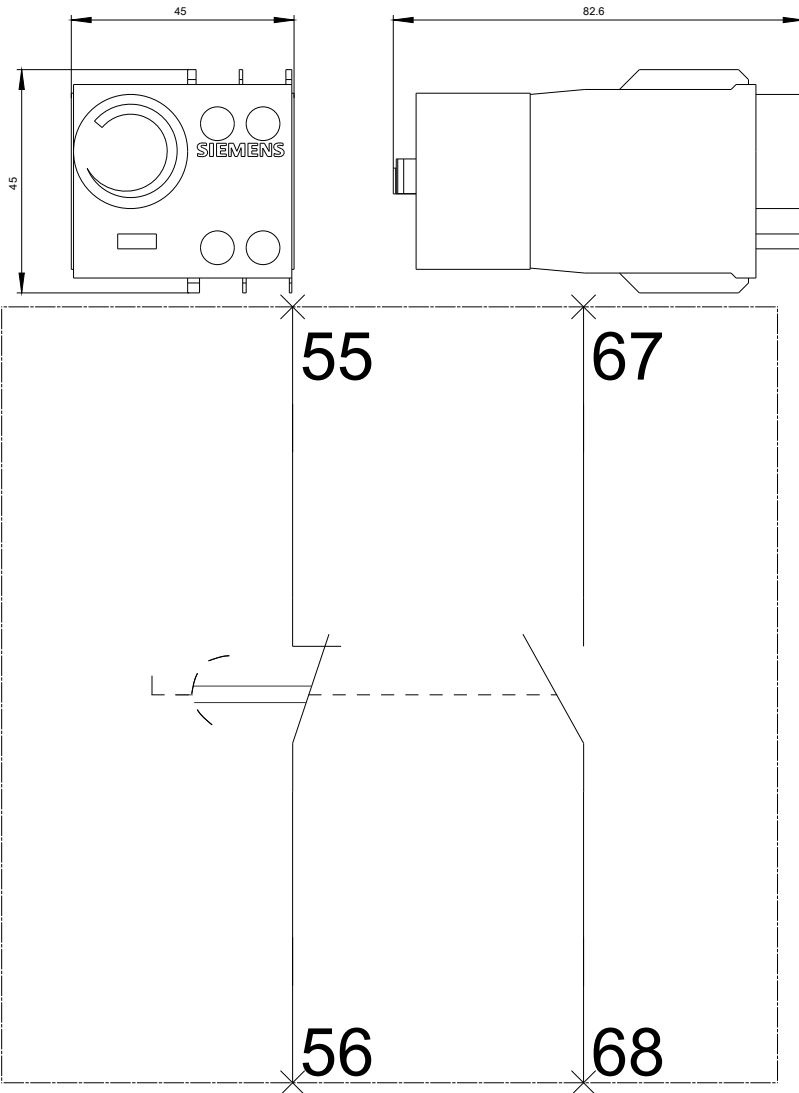

last modified:

06.06.2016