

Electronic housing - UCS 145-125-F-CCD 7035 - 2203447

Please be informed that the data shown in this PDF Document is generated from our Online Catalog. Please find the complete data in the user's documentation. Our General Terms of Use for Downloads are valid (<http://phoenixcontact.com/download>)



Complete housing for PCBs, fixed to the corner inlays; includes housing half shells, side panels closed, corner inlays with PCB attachment, screws for housing and PCB attachment; light gray housing with turquoise blue corner inlays

Your advantages

- High degree of application flexibility, thanks to the modular housing design
- Flexible PCB attachment, adapts to virtually all form factors
- Practical customization options
- Reduced logistics outlay, thanks to components which are compatible with one another

Key Commercial Data

Packing unit	1 pc
GTIN	
GTIN	4055626403359
Weight per Piece (excluding packing)	401.500 g
Custom tariff number	85389099
Country of origin	Germany

Technical data

Item properties

Type	UCS 145-125-F-CCD 7035
Order No.	2203447
Type	flat
Housing type	Complete housing

Measurements

Width [w]	145 mm
Height [h]	125 mm
Depth [d]	47 mm
Dimensions	120 mm x 100 mm (Maximum circuit board dimensions)

Electronic housing - UCS 145-125-F-CCD 7035 - 2203447

Technical data

Material specifications

Flammability rating according to UL 94	V0
Housing material	PC
Color (RAL)	light gray (7035)

Ambient conditions

Ambient temperature (storage/transport)	-40 °C ... 55 °C
Ambient temperature (assembly)	-5 °C ... 100 °C
Ambient temperature (operation)	-40 °C ... 100 °C (depending on power dissipation)
Relative humidity (storage/transport)	80 %

PCB data

Number of PCB holders	1
Note on PCB holders	This product is prepared for a printed-circuit board. Additional printed-circuit boards can be mounted using adhesive pads (accessories).
PCB thickness	0.8 mm ... 3 mm
Total PCB surface	12000 mm ²
Type of PCB mount	Bolt mounting

Power dissipation, single housing at 20 °C

Ambient temperature	20 °C
Reduction factor	1
Mounting position	vertical
Power dissipation	11 W

Power dissipation, single housing at 30 °C

Ambient temperature	30 °C
Reduction factor	0.85
Mounting position	vertical
Power dissipation	9.4 W

Power dissipation, single housing at 40 °C

Ambient temperature	40 °C
Reduction factor	0.7
Mounting position	vertical
Power dissipation	7.7 W

Power dissipation, single housing at 50 °C

Ambient temperature	50 °C
Reduction factor	0.55
Mounting position	vertical
Power dissipation	6 W

Power dissipation, single housing at 60 °C

Ambient temperature	60 °C
Reduction factor	0.4

Electronic housing - UCS 145-125-F-CCD 7035 - 2203447

Technical data

Power dissipation, single housing at 60 °C

Mounting position	vertical
Power dissipation	4.4 W

Mechanical strength/tumbling barrel

Specification	IEC 60068-2-31:2008-05
Height of fall	50 cm
Number of drop cycles	50

Vibration test

Specification	IEC 60068-2-6:2007-12
Frequency	10 - 150 - 10 Hz
Sweep speed	1 octave/min
Amplitude	0.15 mm (10 - 58.1 Hz)
Acceleration	2g (58.1 - 150 Hz)
Test duration per axis	2.5 h
Test directions	X-, Y- and Z-axis

Shock

Specification	IEC 60068-2-27:2008-02
Pulse shape	Half-sine
Acceleration	15g
Shock duration	11 ms
Number of shocks per direction	3
Test directions	X-, Y- and Z-axis (pos. and neg.)

Thermostability (ball thrust test)

Specification	IEC 60695-10-2:2014-02
Temperature	125 °C
Test duration	1 h
Force	20 N

Test for assessing the risk of fire (glow wire)

Specification	DIN EN 60695-2-11 (VDE 0471-2-11):2014-11
Temperature	850 °C
Time of exposure	30 s

Test for substances that would hinder coating with paint or varnish

Result	Test passed
Specification	VW PV 3.10.7:2005-02

Degrees of protection provided by enclosures (IP code)

Specification	IEC 60529:1989-11 + AMD 1:1999-11 + AMD 2:2013-08
Result, degree of protection, IP code	IP40

Electronic housing - UCS 145-125-F-CCD 7035 - 2203447

Technical data

General information

Note	The housing can be opened a maximum of 10 times.
------	--

Note on mounting

Tightening torque / rotational speed	Screw connection between housing halves: 1.2 Nm-1.4 Nm / 500 rpm-1000 rpm
	Mounting of PCB on corner feeder: 0.4 Nm-0.5 Nm / 500 rpm-1000 rpm
Drive form screw head	Screw connection between housing halves: Slotted Torx®(T10)
	Mounting the PCB: Slotted Torx®(T7)

Packaging information

Pieces per package	1
Denomination packing units	Pcs.

Standards and regulations

Flammability rating according to UL 94	V0
--	----

Drawings

Dimensional drawing

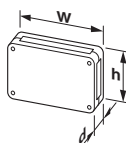

Classifications

eCl@ss

eCl@ss 5.1	27180506
eCl@ss 6.0	27180800
eCl@ss 7.0	27182702
eCl@ss 8.0	27182702
eCl@ss 9.0	27182702

ETIM

ETIM 5.0	EC001031
ETIM 6.0	EC001031

Accessories

Accessories

Screwdriver tools

Electronic housing - UCS 145-125-F-CCD 7035 - 2203447

Accessories

Screwdriver - SF-TXH 10X80 - 1200149



Screwdriver, Torx® with bore hole, TX 10 x 80, two-component handle

Screw insert - SF-BIT-TX 10-50 - 1212573



Screw bit, Torx®, E6.3-1/4" drive, size: TX 10 x 50 mm, hardened, suitable for holder according to DIN 3126-F6.3/ISO 1173

Torque tool

Battery-powered screwdriver - SF-ASD 21 - 1212532



Cordless screwdriver, incl. 1.5 Ah battery, forward/reverse running, 21-stage coupling, up to 600 rpm, 6.3 mm hexagonal fast connection drill chuck, torque can be adjusted from 0.3 ... 4.4 Nm

Torque screwdriver - TSD-M 1,2NM - 1212224



Torque screw driver, accuracy as per EN ISO 6789 standard, adjustable from 0.3 - 1.2 Nm

Additional products

Fiber optic - HS LC-H-D2/ R2XC1-2,54 - 2202316



Light guides, can be used for the ME, ME-MAX, ME-IO, ME PLC, and EH housing ranges (housing must be processed), color: transparent

Electronic housing - UCS 145-125-F-CCD 7035 - 2203447

Accessories

Fiber optic - HS LC-H-D2/ R2XC2-2,54 - 2202317



Light guides, can be used for the ME, ME-MAX, ME-IO, ME PLC, and EH housing ranges (housing must be processed), color: transparent

Fiber optic - HS LC-H-D2/ R2XC5-2,54 - 2202318



Light guides, can be used for the ME, ME-MAX, ME-IO, ME PLC, and EH housing ranges (housing must be processed), color: transparent

Fiber optic - HS LC-H-D2/ R2XC10-2,54 - 2202319



Light guides, can be used for the ME, ME-MAX, ME-IO, ME PLC, and EH housing ranges (housing must be processed), color: transparent

Corner inlay - UCS CCD 7035 - 2203479



Corner inlay for UCS housings with integrated screw boss; material: polyamide; color: light gray, similar to RAL 7035

Corner inlay - UCS CCD 9005 - 2203477



Corner inlay for UCS housings with integrated screw boss; material: polyamide; color: black, similar to RAL 9005

Electronic housing - UCS 145-125-F-CCD 7035 - 2203447

Accessories

Accessories - UCS SF 3,5X20 - 2203402



Screw set for creating a UCS housing of height 47 mm

Accessories - UCS SF 3,5X40 - 2203403



Screw set for creating a UCS housing of height 67 mm

Accessories - UCS GD 9005 - 2203401



Adhesive screw boss, for securing the printed-circuit board, material: polyamide; content 4 pieces with screws 2.5 x 8

Stand - UCS PED 9005 - 2203393



Stand for mounting the UCS housing; height: 47 mm; material: polyamide; color: black, similar to RAL 9005; wall mounting option is integrated, snaps into the screw holes of the housing

Stand - UCS PED 7035 - 2203392



Stand for mounting the UCS housing; height: 47 mm; material: polyamide; color: light gray, similar to RAL 7035; wall mounting option is integrated, snaps into the screw holes of the housing

Electronic housing - UCS 145-125-F-CCD 7035 - 2203447

Accessories

Stand - UCS PED 5018 - 2203394



Stand for mounting the UCS housing, height: 47 mm; material: polyamide; color: turquoise blue, similar to RAL 5018; wall mounting option is integrated, snaps into the screw holes of the housing

Phoenix Contact 2018 © - all rights reserved
<http://www.phoenixcontact.com>