

Product data sheet

Specifications



Harmony XVC, Monolithic precabled tower light, plastic, red orange green, Ø60, tube mounting, steady, IP23, 24 V AC/DC

XVC6B3

Main

Range of product	Harmony XVC6
Product or component type	Complete pre-wired monolithic tower light
Beacon or indicator bank unit type	3 illuminated units
Sound signalling	Without
Mounting diameter	60 mm
Component name	XVC
Light source	LED steady red LED steady orange LED steady green
[Us] rated supply voltage	24 V
Supply circuit type	AC/DC

Complementary

Material	Polycarbonate: illuminated unit ABS (acrylonitrile butadiene-styrene): base unit PBT + ABS (UL94HB): top cover STK (chromium-plated): support tube
Product mounting	On support tube, 22 mm
Cable cross section	0.33 mm²
AWG gauge	AWG 22
Cable length	600 mm
Marking	CE
[Uimp] rated impulse withstand voltage	0.8 kV
Current consumption	75 mA
Flashing frequency	1 Hz
Net weight	0.78 kg
Height	508.3 mm

Environment

Standards	EN/IEC 61000-6-4 EN/IEC 61000-6-2 EN/IEC 61000-6-3
-----------	--

Product certifications	UL
Protective treatment	TC
Ambient air temperature for storage	-35...70 °C
Ambient air temperature for operation	-10...50 °C
Electrical shock protection class	Class I conforming to EN/IEC 61140
IP degree of protection	IP23 vertical surface installation conforming to EN/IEC 60529

Packing Units

Unit Type of Package 1	PCE
Number of Units in Package 1	1
Package 1 Weight	1.048 kg
Package 1 Height	8.7 cm
Package 1 width	8.5 cm
Package 1 Length	77.5 cm
Unit Type of Package 2	S06
Number of Units in Package 2	1
Package 2 Weight	13.0 kg
Package 2 Height	73.5 cm
Package 2 width	60 cm
Package 2 Length	80 cm
Unit Type of Package 3	P06
Number of Units in Package 3	20
Package 3 Weight	32.242 kg
Package 3 Height	77 cm
Package 3 width	80 cm
Package 3 Length	60 cm

Offer Sustainability

EU RoHS Directive	Pro-active compliance (Product out of EU RoHS legal scope) EU RoHS Declaration
Mercury free	Yes
RoHS exemption information	Yes
China RoHS Regulation	China RoHS declaration
Environmental Disclosure	Product Environmental Profile
Circularity Profile	End of Life Information
California proposition 65	WARNING: This product can expose you to chemicals including: Lead and lead compounds, which is known to the State of California to cause cancer and birth defects or other reproductive harm. For more information go to www.P65Warnings.ca.gov

Contractual warranty

Warranty	18 months
----------	-----------

Product data sheet

Pre-assembled and Pre-wired Tower Light with Support Tube Mounting

Dimensions

Below drawing shows the maximum configuration of the product. Select the number of stages according to the product characteristics in order to get **b** dimension.

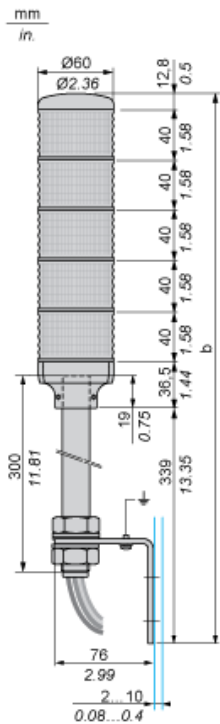

No. of illuminated units	b Without buzzer (mm)	b Without buzzer (in.)
1 stage	428.3	16.86
2 stages	468.3	18.44
3 stages	508.3	20.01
4 stages	548.3	20.01
5 stages	588.3	23.16

Pre-assembled and Pre-wired Tower Light

Support Tube Mounting

