



Copper Cable Lug

CL-Series

Copper cable lugs provide a reliable solution for terminating copper conductors in a wide range of electrical installations. Designed for general-purpose use, they accommodate various conductor sizes and are suitable for both high-performance systems and routine electrical work. Manufactured from 99.9% pure, high-conductivity copper and fully annealed, HellermannTyton lugs offer excellent ductility and mechanical strength, ensuring secure crimping without cracking under compression. The straight barrel design allows for easy conductor insertion and is compatible with both indent and hexagonal crimping tools. A tin-plated finish (5–10 microns) enhances corrosion resistance and electrical performance, supporting long-term reliability in harsh environments.



Copper lugs, CL series.

Features and benefits

- Wide range of sizes that supports conductor sizes from 1.5 mm² to 630 mm²
- Inspection window included up to 240 mm² for visual confirmation of cable placement
- Total conductivity: 99.9% IACS
- Low oxygen content (30 ppm max)
- Tin electroplating (5–10 microns)
- Total resistivity: 1.72 micro-ohm cm
- Ductile rating: 40%
- REACH compliant

MATERIAL	Copper (CU)
Specifications	AS/NZS4325 Part 1
Operating Temperature	-55 °C to +155 °C

More details: Click on article number in table.

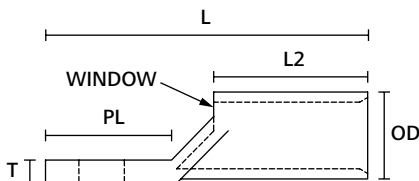

Copper Lug Series, Side View

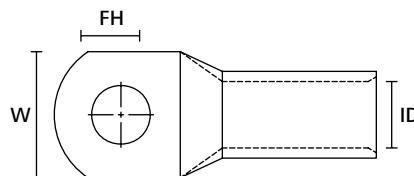

Copper Lug Series, Top View

TYPE	Conductor Size (mm ²)	Hole Ø (FH)	Cable Size (Strands)	Inside Ø (ID)	Outside Ø (OD)	Length (L)	Length (L2)	Width (W)	Palm Length (PL)	Thickness (T)	A/F Hex (A/F2)	Pack Cont.	Tools	Art.-No.
CL1.5-4	1.5	4.2	7 x 0.5	2	4	18.5	7.5	8.0	9	1.00	-	100 pcs.	65	924-00563
CL1.5-5	1.5	5.2	7 x 0.5	2	4	18.5	7.5	8.0	9	1.00	-	100 pcs.	65	924-00564
CL1.5-6	1.5	6.4	7 x 0.5	2	4	20.5	7.5	10.0	11	0.80	-	100 pcs.	65	924-00565
CL2.5-4	2.5	4.2	7 x 0.67	2.5	4.4	19.0	8	8.0	9	1.00	-	100 pcs.	65	924-00566
CL2.5-5	2.5	5.2	7 x 0.67	2.5	4.4	21.0	8	10.0	11	0.80	-	100 pcs.	65	924-00567
CL2.5-6	2.5	6.4	7 x 0.67	2.5	4.4	21.0	8	10.0	11	0.80	-	100 pcs.	65	924-00568
CL2.5-8	2.5	8.4	7 x 0.67	2.5	4.4	26.0	8	11.0	15	0.70	-	100 pcs.	65	924-00569
CL4-5	4	5.2	7 x 0.85	3.3	5.2	22.0	9	10.0	11	1.00	-	100 pcs.	65	924-00570
CL4-6	4	6.4	7 x 0.85	3.3	5.2	22.0	9	10.0	11	1.00	-	100 pcs.	65	924-00571
CL4-8	4	8.4	7 x 0.85	3.3	5.2	26.0	9	12.0	15	0.80	-	100 pcs.	65	924-00572
CL4-10	4	10.2	7 x 0.85	3.3	5.2	32.0	9	15.0	19	0.80	-	100 pcs.	65	924-00573
CL6-5	6	5.2	7 x 1.04	3.8	5.5	24.0	10	10.0	11	1.20	4.4	100 pcs.	65-67	924-00574

Recommended Tools: 65=HD16L, 66=HD0650AU, 67=HD06120AU, 68=HYCP400, 69=HP700A, 70=FH700FP. For more information on toolings please go to www.HellermannTyton.com.au/application-tooling.

All dimensions in mm. Tolerance ± 2%. Subject to technical changes. Lugs above 95 mm are also available in single units.

Please note: Some or all of the products listed here have these approvals, or have one or more sustainable attributes. Please see our website for the latest details.

TYPE	Conductor Size (mm ²)	Hole Ø (FH)	Cable Size (Strands)	Inside Ø (ID)	Outside Ø (OD)	Length (L)	Length (L2)	Width (W)	Palm Length (PL)	Thickness (T)	A/F Hex (A/F2)	Pack Cont.	Tools	Art.-No.
CL6-6	6	6.4	7 x 1.04	3.8	5.5	28.0	10	12.0	15	1.00	4.4	100 pcs.	65-67	924-00575
CL6-8	6	8.4	7 x 1.04	3.8	5.5	28.0	10	12.0	15	1.00	4.4	100 pcs.	65-67	924-00576
CL6-10	6	10.2	7 x 1.04	3.8	5.5	32.0	10	15.0	19	0.80	4.4	100 pcs.	65-67	924-00577
CL10-5	10	5.2	7 x 1.35	4.7	7.1	27.0	10	12.0	13	1.80	5.7	100 pcs.	65-67	924-00578
CL10-6	10	6.4	7 x 1.35	4.7	7.1	27.0	10	12.0	13	1.80	5.7	100 pcs.	65-67	924-00579
CL10-8	10	8.4	7 x 1.35	4.7	7.1	29.0	10	14.0	15	1.60	5.7	100 pcs.	65-67	924-00580
CL10-10	10	10.2	7 x 1.35	4.7	7.1	32.0	10	15.0	18	1.50	5.7	100 pcs.	65-67	924-00581
CL10-12	10	13.0	7 x 1.35	4.7	7.1	38.0	10	18.0	22	1.00	5.7	100 pcs.	65-67	924-00582
CL16-6	16	6.4	7 x 1.7	5.5	7.9	37.0	19	11.0	14	2.40	6.3	50 pcs.	65-68	924-00583
CL16-8	16	8.4	7 x 1.7	5.5	7.9	39.0	19	14.0	16	1.70	6.3	50 pcs.	65-68	924-00584
CL16-10	16	10.2	7 x 1.7	5.5	7.9	41.0	19	16.0	18	1.50	6.3	50 pcs.	65-68	924-00585
CL16-12	16	13.0	7 x 1.7	5.5	7.9	48.0	19	18.0	23	1.20	6.3	50 pcs.	65-68	924-00586
CL25-6	25	6.4	19 x 1.35	7.1	9.5	41.0	21	13.5	16	2.40	7.7	50 pcs.	66-68	924-00587
CL25-8	25	8.4	19 x 1.35	7.1	9.5	41.0	21	13.5	16	2.40	7.7	50 pcs.	66-68	924-00588
CL25-10	25	10.2	19 x 1.35	7.1	9.5	44.0	21	16.0	19	1.90	7.7	50 pcs.	66-68	924-00589
CL25-12	25	13.0	19 x 1.35	7.1	9.5	48.0	21	18.0	23	1.60	7.7	50 pcs.	66-68	924-00590
CL35-6	35	6.4	19 x 1.53	8.4	11.5	45.0	21	16.0	19	3.00	9.2	50 pcs.	66-68	924-00591
CL35-8	35	8.4	19 x 1.53	8.4	11.5	45.0	21	16.0	19	3.00	9.2	50 pcs.	66-68	924-00592
CL35-10	35	10.2	19 x 1.53	8.4	11.5	45.0	21	18.5	19	2.60	9.2	50 pcs.	66-68	924-00593
CL35-12	35	13.0	19 x 1.53	8.4	11.5	51.0	22	20.0	24	2.20	9.2	50 pcs.	66-68	924-00594
CL50-6	50	6.4	19 x 1.78	9.5	12.8	48.0	22	18.0	20	3.30	10.4	50 pcs.	66-68	924-00595
CL50-8	50	8.4	19 x 1.78	9.5	12.8	48.0	22	18.0	20	3.30	10.4	50 pcs.	66-68	924-00596
CL50-10	50	10.2	19 x 1.78	9.5	12.8	48.0	22	18.0	20	3.30	10.4	50 pcs.	66-68	924-00597
CL50-12	50	13.0	19 x 1.78	9.5	12.8	52.0	22	21.0	24	2.70	10.4	50 pcs.	66-68	924-00598
CL70-6	70	6.4	19 x 2.14	11.3	14.6	54.0	24	21.0	24	3.50	11.5	25 pcs.	67-68	924-00599
CL70-8	70	8.4	19 x 2.14	11.3	14.6	54.0	24	21.0	24	3.50	11.5	25 pcs.	67-68	924-00600
CL70-10	70	10.2	19 x 2.14	11.3	14.6	54.0	24	21.0	24	3.50	11.5	25 pcs.	67-68	924-00601
CL70-12	70	13.0	19 x 2.14	11.3	14.6	54.0	24	21.0	24	3.50	11.5	25 pcs.	67-68	924-00602
CL70-16	70	17.0	19 x 2.14	11.3	14.6	64.0	24	28.0	34	3.00	11.5	25 pcs.	67-68	924-00603
CL95-8	95	8.4	19 x 2.45	13.5	17.4	60.0	26	25.0	27	4.00	14.2	25 pcs.	67-68	924-00604
CL95-10	95	10.2	19 x 2.45	13.5	17.4	60.0	26	25.0	27	4.00	14.2	25 pcs.	67-68	924-00605
CL95-12	95	13.0	19 x 2.45	13.5	17.4	60.0	26	25.0	27	4.00	14.2	25 pcs.	67-68	924-00606
CL95-16	95	17.0	19 x 2.45	13.5	17.4	64.0	26	28.0	30	3.50	14.2	25 pcs.	67-68	924-00607
CL120-8	120	8.4	37 x 2.03	15.6	20.6	64.0	30	29.0	26	5.00	16.5	25 pcs.	67-68	924-00608
CL120-10	120	10.2	37 x 2.03	15.6	20.6	64.0	30	29.0	26	5.00	16.5	25 pcs.	67-68	924-00609
CL120-12	120	13.0	37 x 2.03	15.6	20.6	64.0	30	29.0	26	5.00	16.5	25 pcs.	67-68	924-00610
CL120-16	120	17.0	37 x 2.03	15.6	20.6	68.0	30	29.0	30	5.00	16.5	25 pcs.	67-68	924-00611
CL150-8	150	8.4	37 x 2.25	16.7	22.2	71.0	30	31.5	32	5.80	18.3	20 pcs.	68	924-00612
CL150-10	150	10.2	37 x 2.25	16.7	22.2	71.0	30	31.5	32	5.80	18.3	20 pcs.	68	924-00613
CL150-12	150	13.0	37 x 2.25	16.7	22.2	80.0	30	31.5	41	5.80	18.3	20 pcs.	68	924-00614
CL150-16	150	17.0	37 x 2.25	16.7	22.2	80.0	30	31.5	41	5.80	18.3	20 pcs.	68	924-00615
CL185-10	185	10.2	37 x 2.52	18.4	24.2	74.0	32	34.5	32	5.80	20.0	20 pcs.	68	924-00616
CL185-12	185	13.0	37 x 2.52	18.4	24.2	83.0	32	34.5	41	5.80	20.0	20 pcs.	68	924-00617
CL185-16	185	17.0	37 x 2.52	18.4	24.2	83.0	32	34.5	41	5.80	20.0	20 pcs.	68	924-00618
CL240-10	240	10.2	61 x 2.25	21.2	28.5	92.0	38	40.0	42	7.00	23.1	10 pcs.	68	924-00619

Recommended Tools: 65=HD16L, 66=HD0650AU, 67=HD06120AU, 68=HYCP400, 69=HP700A, 70=FH700FP. For more information on toolings please go to www.HellermannTyton.com.au/application-tooling.

All dimensions in mm. Tolerance ± 2%. Subject to technical changes. Lugs above 95 mm are also available in single units.

Please note: Some or all of the products listed here have these approvals, or have one or more sustainable attributes. Please see our website for the latest details.



TYPE	Conductor Size (mm ²)	Hole Ø (FH)	Cable Size (Strands)	Inside Ø (ID)	Outside Ø (OD)	Length (L)	Length (L2)	Width (W)	Palm Length (PL)	Thickness (T)	A/F Hex (A/F2)	Pack Cont.	Tools	Art.-No.
CL240-12	240	13.0	61 x 2.25	21.2	28.5	92.0	38	40.0	42	7.00	23.1	10 pcs.	68	924-00620
CL240-16	240	17.0	61 x 2.25	21.2	28.5	92.0	38	40.0	42	7.00	23.1	10 pcs.	68	924-00621
CL300-10	300	10.2	61 x 2.25	23.8	31.9	101.0	42	45.5	46	7.80	26.0	5 pcs.	68	924-00622
CL300-12	300	13.0	61 x 2.25	23.8	31.9	101.0	42	45.5	46	7.80	26.0	5 pcs.	68	924-00623
CL300-16	300	17.0	61 x 2.25	23.8	31.9	101.0	42	45.5	46	7.80	26.0	5 pcs.	68	924-00624
CL400-12	400	13.0	61 x 2.85	26.8	34.9	114.0	44	50.0	52	8.00	28.1	1 pc.	69-70	924-00625
CL400-16	400	17.0	61 x 2.85	26.8	34.9	114.0	44	50.0	52	8.00	28.1	1 pc.	69-70	924-00626
CL500-10	500	10.2	61 x 3.2	30	38.1	124.0	48	55.0	56	9.00	31.0	1 pc.	69-70	924-00627
CL500-12	500	13.0	61 x 3.2	30	38.1	124.0	48	55.0	56	9.00	31.0	1 pc.	69-70	924-00628
CL630-12	630	13.0	127 x 2.52	34	44	134.0	56	64.0	56	11.00	37.0	1 pc.	69-70	924-00629
CL630-16	630	17.0	127 x 2.52	34	44	134.0	56	64.0	56	11.00	37.0	1 pc.	69-70	924-00630

Recommended Tools: 65=HD16L, 66=HD0650AU, 67=HD06120AU, 68=HYCP400, 69=HP700A, 70=FH700FP. For more information on toolings please go to www.HellermannTyton.com.au/application-tooling.

All dimensions in mm. Tolerance ± 2%. Subject to technical changes. Lugs above 95 mm are also available in single units.

Please note: Some or all of the products listed here have these approvals, or have one or more sustainable attributes. Please see our website for the latest details.