



RME070-XL

Flanged housing unit

Housing units RMEO, four-bolt flanged housing units, cast iron, centring spigot, eccentric locking collar, series 63, R seals

X-life

Technical information

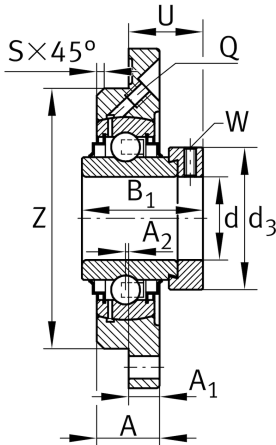
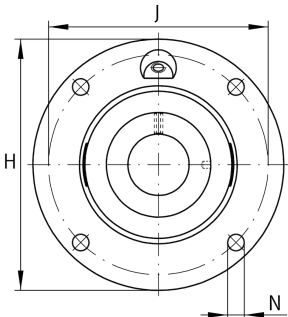

Your current product variant

Material	GG	Grey cast iron
----------	----	----------------

Main Dimensions & Performance Data

d	70 mm	Bore diameter
H	300 mm	Height flange
B ₁	75.5 mm	Locking collar total width
U	49.9 mm	Total height unit
C _r	104,000 N	Basic dynamic load rating, radial
C _{0r}	68,000 N	Basic static load rating, radial
C _{ur}	3,400 N	Fatigue load limit, radial
≈m	12.2 kg	Weight

Mounting dimensions

J	252 mm	Pitch circle diameter (holes)
N	25 mm	Fixing bore
Z	185 mm	Diameter spigot
	h8	Diameter spigot clearance
n	4	Number of screwing holes



Dimensions

A	43 mm	Height housing
A ₁	25 mm	Thickness of flange
A ₂	-0.5 mm	Distance raceway
S	4 mm	Chamfer width
Q	M6	Connection thread for lubrication

Additional information

1	Number of housings
MEO14	Housing
GNE70-XL-KRR-B	Bearing designation

Temperature range

T _{min}	-20 °C	Operating temperature min.
T _{max}	120 °C	Operating temperature max.