

# Customer Information Sheet

IF IN DOUBT - ASK

©

NOT TO SCALE

THIRD ANGLE PROJECTION

ALL DIMENSIONS IN mm

ORDER CODE: **G125-MHXXX05L1R**

CONTACT STYLE:  
 3.2mm PC-TAIL = H1  
 4.7mm PC-TAIL = H2

TOTAL No. OF CONTACTS:  
 06, 10, 12, 16, 20, 26, 34, 50

LATCHES:  
 1.7mm BOARD MOUNT & LATCHES = L1

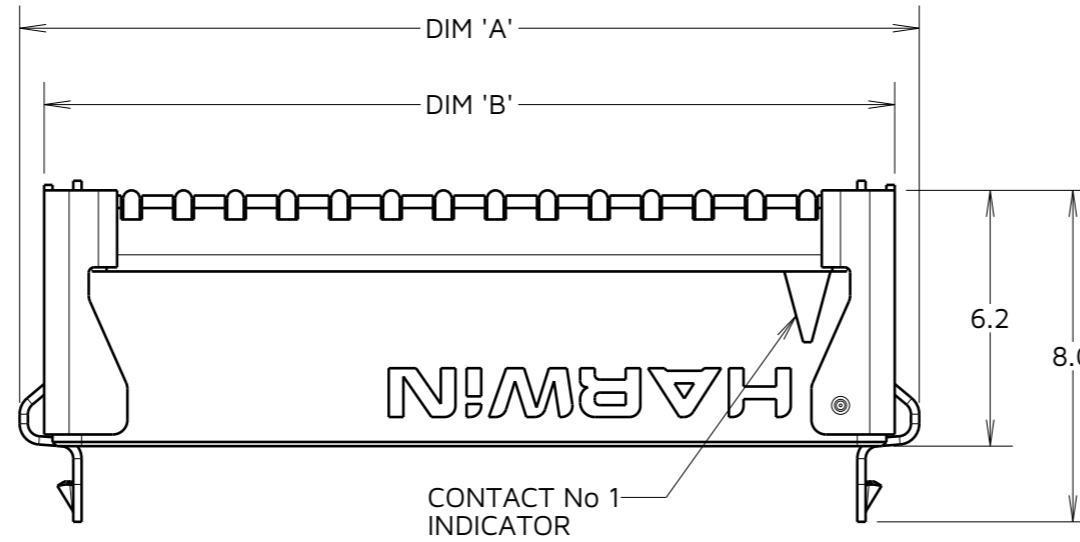
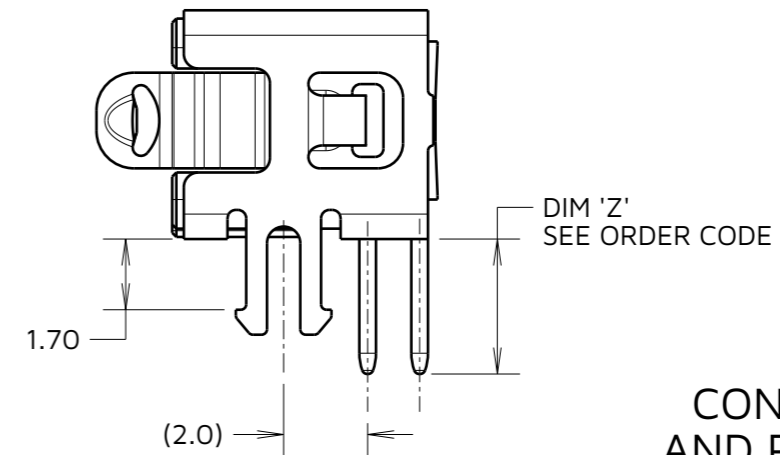
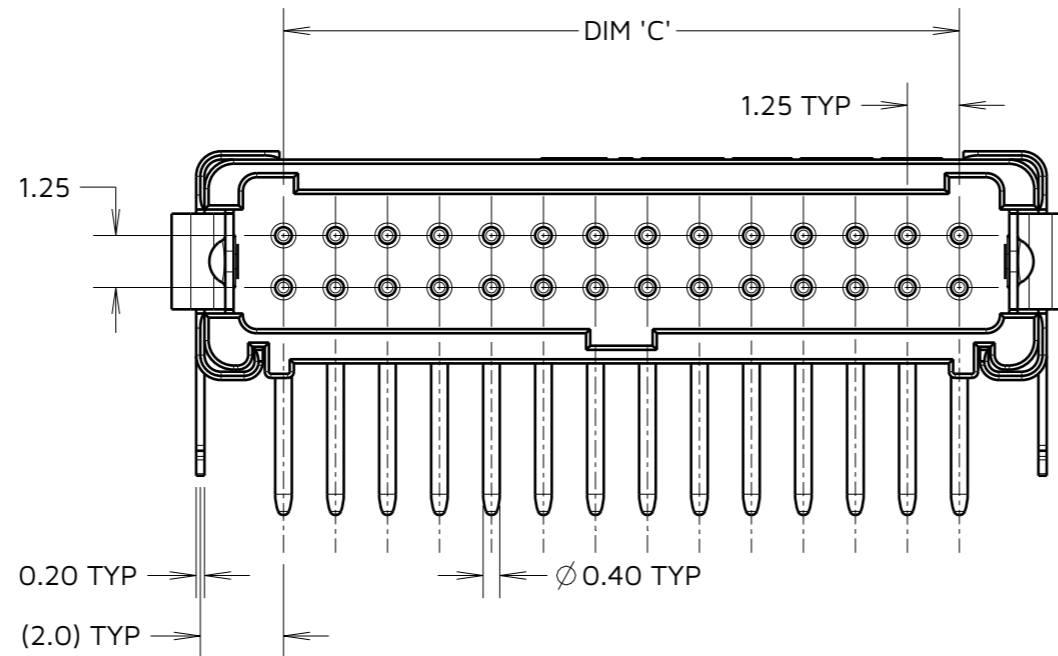
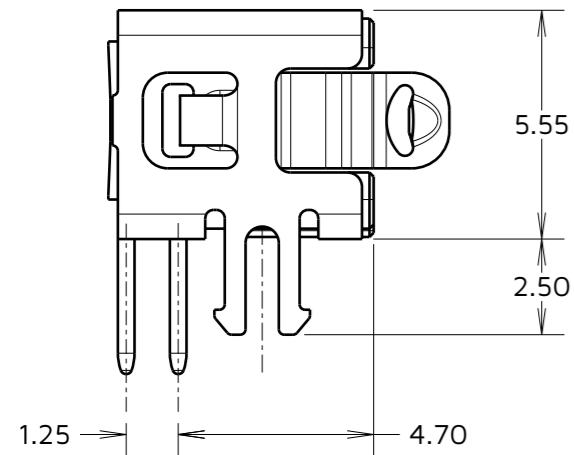
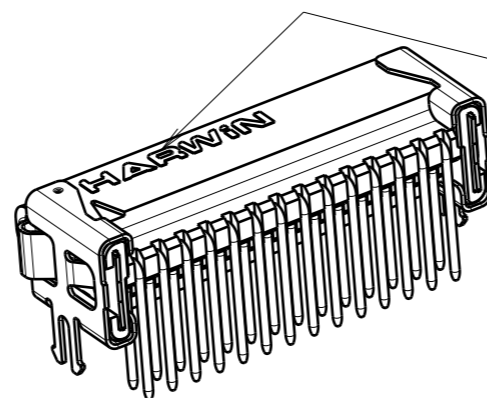
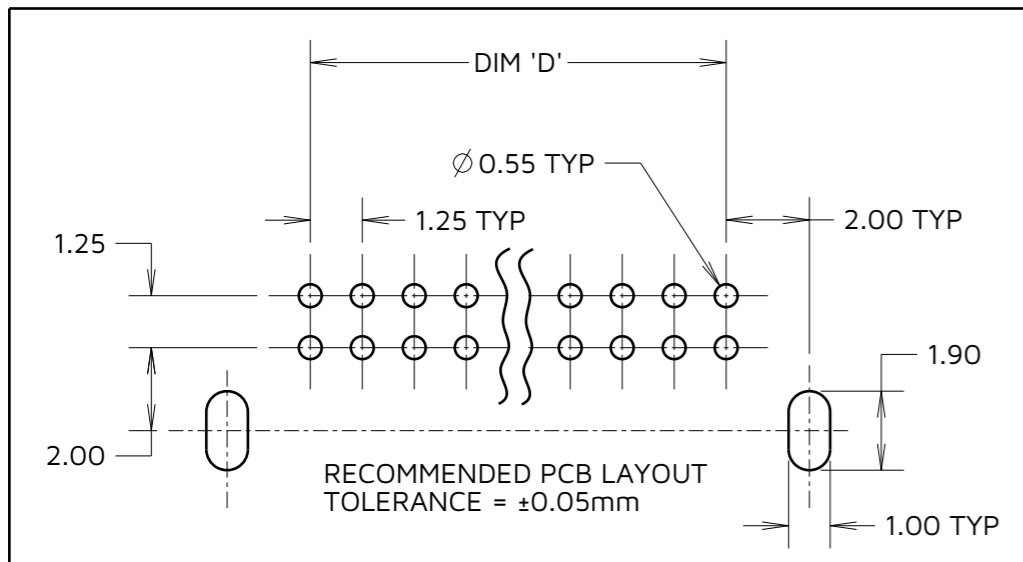

TABLE 1: DIMENSION VARIANTS				
PART No.	DIM 'A'	DIM 'B'	DIM 'C'	DIM 'D'
G125-MHX0605L1R-00	8.05	6.80	2.50	2.50
G125-MHX1005L1R-00	10.55	9.30	5.00	5.00
G125-MHX1205L1R-00	11.80	10.55	6.25	6.25
G125-MHX1605L1R-00	14.30	13.05	8.75	8.75
G125-MHX2005L1R-00	16.80	15.55	11.25	11.25
G125-MHX2605L1R-00	20.55	19.30	15.00	15.00
G125-MHX3405L1R-00	25.55	24.30	20.00	20.00
G125-MHX5005L1R-00	35.55	34.30	30.00	30.00



CONNECTOR DETAILS  
 AND PCB LAYOUT ONLY.  
 SEE SHEET 6 FOR  
 TAPE AND REEL DETAILS.



FULL LOGO ON 20 TO 50 WAY.  
 'H' ON 6 & 10 WAY.  
 'HWN' ON 12 & 16 WAY.

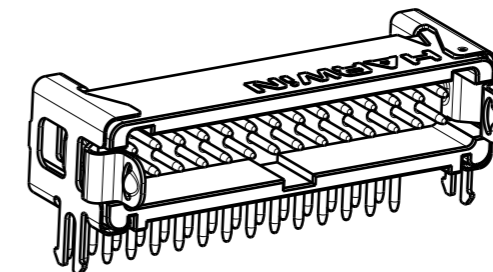

MJ	7	16.10.24	34985
NAME	ISS.	DATE	CN/CO
APPROVED:		M. JELLEY	
CHECKED:		A. YEOMANS	
DRAWN:		MARK G PLESTED	

NOTES:  
 1. FOR COMPLETE SPECIFICATION, SEE COMPONENT SPECIFICATION C125XX (LATEST ISSUE).

**HARWIN**

www.harwin.com

TOLERANCES  
 X. = ±1mm  
 X.X = ±0.50mm  
 X.XX = ±0.20mm  
 X.XXX = ±0.01mm  
 ANGLES = ±5°  
 UNLESS STATED

THIS DRAWING AND ANY INFORMATION OR DESCRIPTIVE MATTER SET OUT HEREON ARE CONFIDENTIAL AND COPYRIGHT PROPERTY OF THE HARWIN GROUP AND MUST NOT BE DISCLOSED, LOANED, COPIED OR USED FOR MANUFACTURING, TENDERING OR FOR ANY OTHER PURPOSE WITHOUT THEIR WRITTEN PERMISSION.

MATERIAL & FINISH:  
 SEE NOTE 1

TITLE:  
**G125 MALE HORIZONTAL PC TAIL SERIES IN TAPE & REEL**

DRAWING NUMBER:  
**G125-MHXXX05L1R**

SHT  
 5 OF 6

# Customer Information Sheet

IF IN DOUBT - ASK

©

NOT TO SCALE

THIRD ANGLE PROJECTION

ALL DIMENSIONS IN mm

ORDER CODE: **G125-MHXXX05L1R**

CONTACT STYLE:  
 3.2mm PC-TAIL = H1  
 4.7mm PC-TAIL = H2

TOTAL No. OF CONTACTS:  
 06, 10, 12, 16, 20, 26, 34, 50

LATCHES:  
 1.7mm BOARD MOUNT & LATCHES = L1

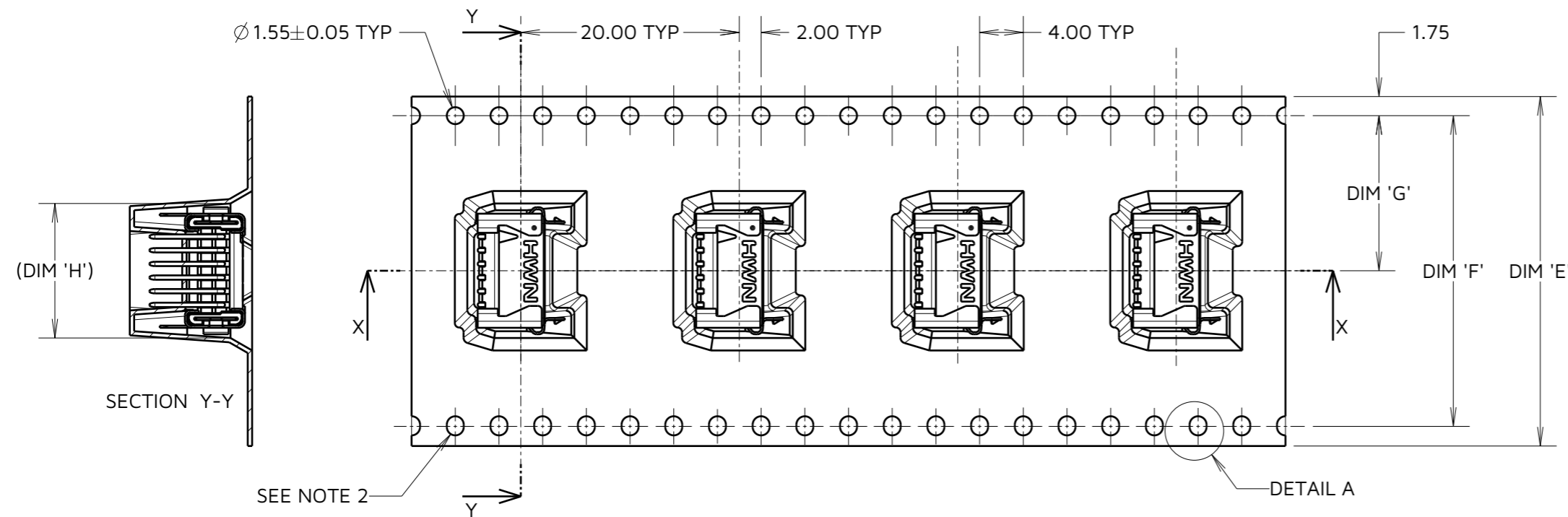

SEE NOTE 2

DETAIL A

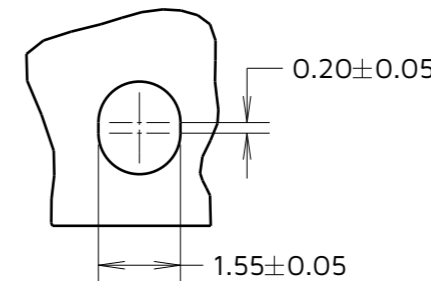
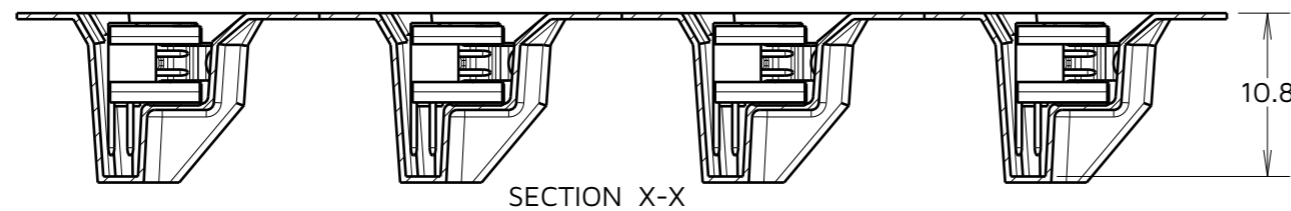
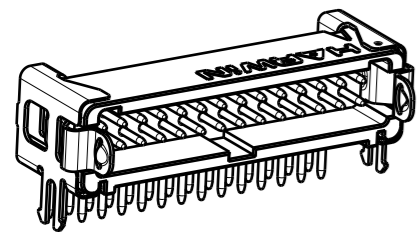

DETAIL A  
SEE NOTE 5

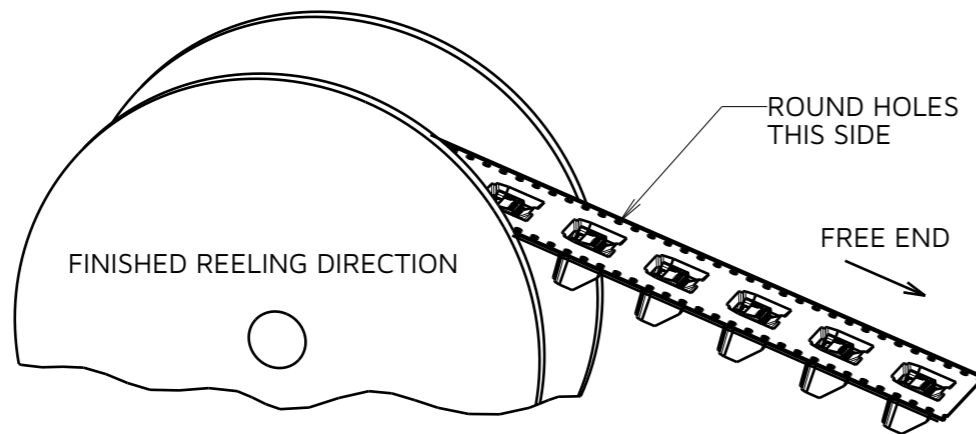
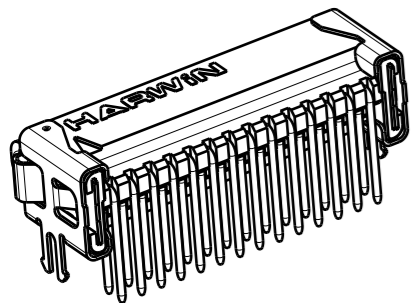
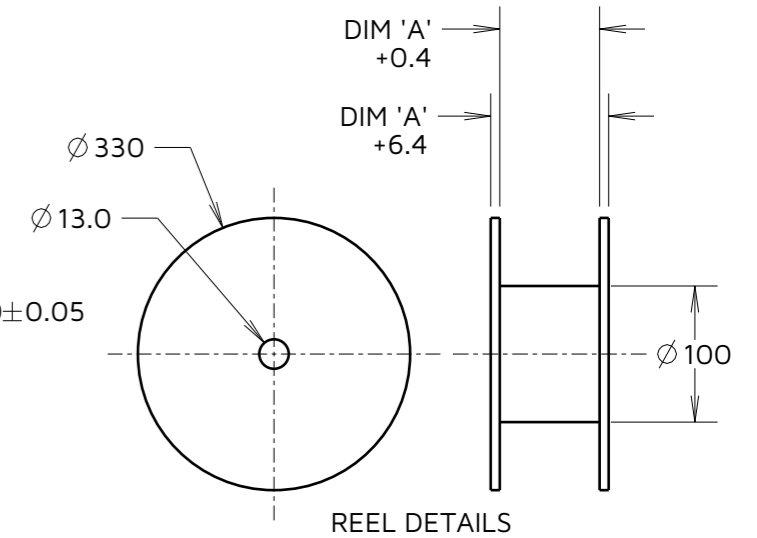

TABLE 2: DIMENSION VARIANTS

PART No.	DIM 'E'	DIM 'F'	DIM 'G'	(DIM 'H')
G125-MHX0605L1R	24.0 +0.3/-0.1	NO ELONGATED HOLE	11.50	8.5
G125-MHX1005L1R				11.0
G125-MHX1205L1R	32.0±0.3	28.40	14.20	12.2
G125-MHX1605L1R				14.7
G125-MHX2005L1R	44.0±0.3	40.40	20.2±0.15	17.2
G125-MHX2605L1R				21.0
G125-MHX3405L1R	56.0±0.3	52.40	26.2±0.15	26.0
G125-MHX5005L1R				36.0

MJ	7	16.10.24	34985
NAME	ISS.	DATE	CN/CO
APPROVED:		M. JELLEY	
CHECKED:		A. YEOMANS	
DRAWN: MARK G PLESTED			

- NOTES:
- QUANTITY OF COMPONENTS PER REEL = 250.
  - FOR OTHER QUANTITIES SEE G125-MHXXX05L1P.
  - FOR COMPLETE SPECIFICATION, SEE COMPONENT SPECIFICATION C125XX (LATEST ISSUE).
  - ELONGATED SPROCKET HOLE NOT PRESENT ON 06 & 10 POSITIONS.
  - SEE SHEET 5 FOR CONNECTOR DETAILS.

**HARWIN**

www.harwin.com

TOLERANCES  
 X. = ±1mm  
 X.X = ±0.50mm  
 X.XX = ±0.20mm  
 X.XXX = ±0.01mm  
 ANGLES = ±5°  
 UNLESS STATED

THIS DRAWING AND ANY INFORMATION OR DESCRIPTIVE MATTER SET OUT HEREON ARE CONFIDENTIAL AND COPYRIGHT PROPERTY OF THE HARWIN GROUP AND MUST NOT BE DISCLOSED, LOANED, COPIED OR USED FOR MANUFACTURING, TENDERING OR FOR ANY OTHER PURPOSE WITHOUT THEIR WRITTEN PERMISSION.

MATERIAL & FINISH:  
 SEE SHEET 5

TITLE:  
**G125 MALE HORIZONTAL PC TAIL SERIES IN TAPE & REEL**

DRAWING NUMBER:  
**G125-MHXXX05L1R**