

REVISIONS					
P	LTR	DESCRIPTION	DATE	DWN	APVD
	A	INITIAL RELEASE	09JUL2025	WB	SA

NOTES:  
 1.MATERIAL:  
 HOUSING:HIGH TEMP THERMO PLASTIC UL94V-0  
 CONTACT:COPPER ALLOY  
 SOLDER PEG:COPPER ALLOY  
 2.FINISH  
 UNDERPLATED:30U".NICKEL ALL OVER  
 CONTACT MATING AREA:AU 8U"  
 SOLDER AREA:GOLD FLASH

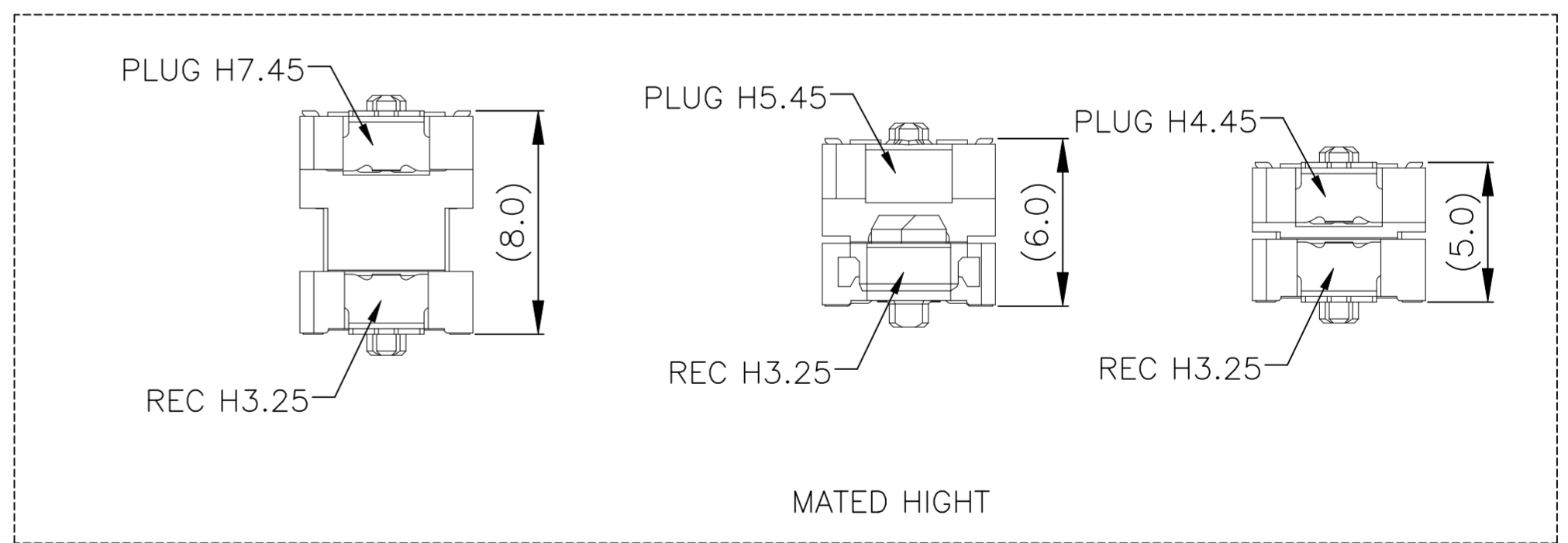
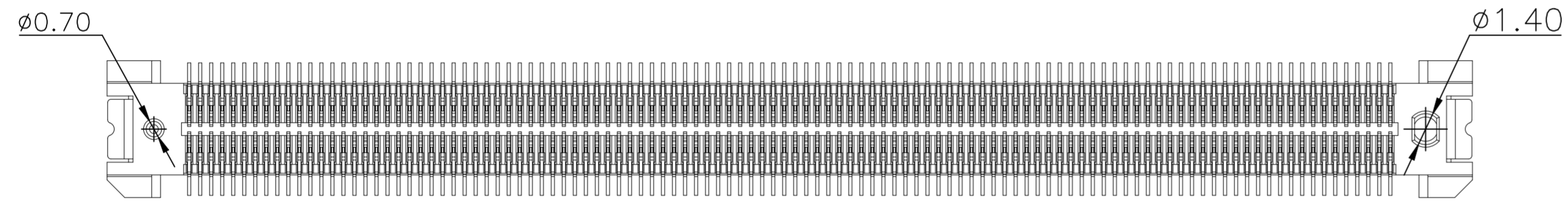
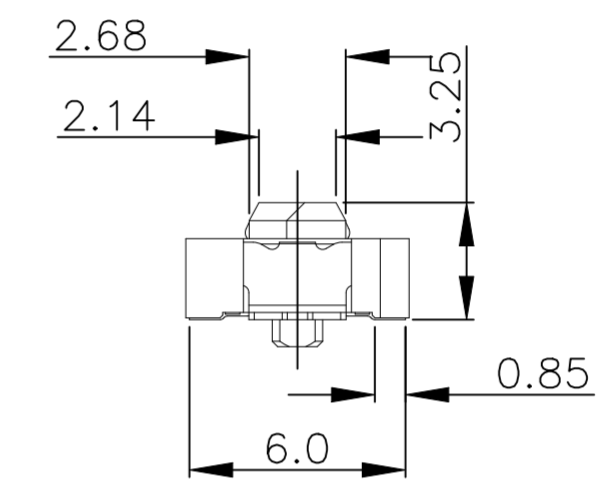
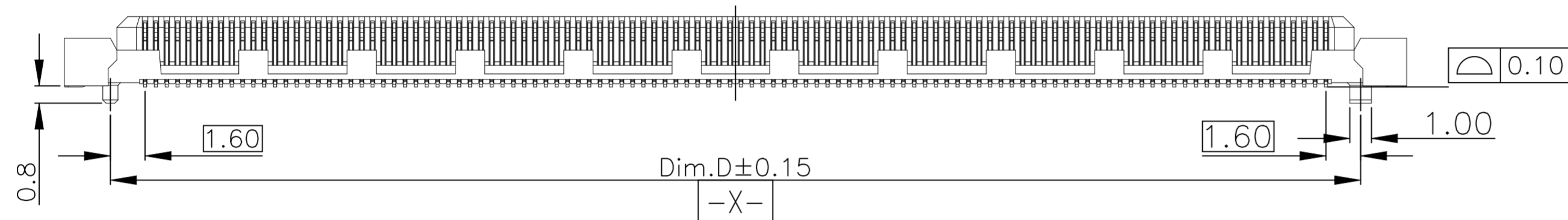
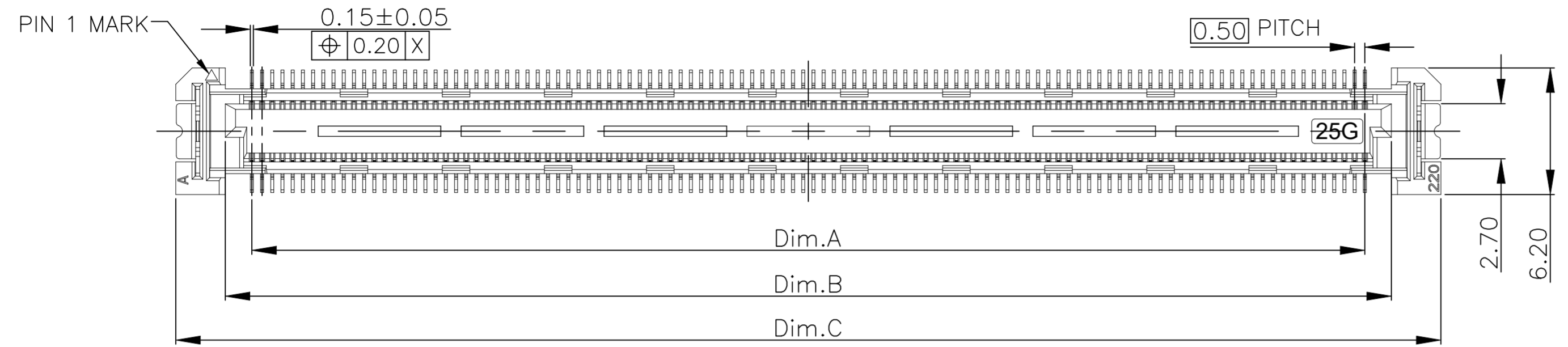

220	2499542-5	54.50	57.10	62.00	57.70
160	2499542-4	39.50	42.10	47.00	42.70
120	2499542-3	29.50	32.10	37.00	32.70
80	2499542-2	19.50	22.10	27.00	22.70
40	2499542-1	9.50	12.10	17.00	12.70
PIN NO	TE PN's	DIM.'A'	DIM.'B'	DIM.'C'	DIM.'D'

THIS DRAWING IS A CONTROLLED DOCUMENT.

DIMENSIONS: mm	TOLERANCES UNLESS OTHERWISE SPECIFIED: 0 PLC ± 0.50 1 PLC ± 0.20 2 PLC ± 0.10 3 PLC ± 0.05 4 PLC ± 0.05 ANGLES ± 3°	DWN MANOJ K 18DEC2024 CHK GOWTHAM CHITTY 18DEC2024 APVD JAGRUTI MOHANTY 18DEC2024	TE Connectivity	
MATERIAL SEE NOTE	FINISH SEE NOTE	NAME 108-161908 APPLICATION SPEC 114-161404	SIZE A2	CAGE CODE 00779
CUSTOMER DRAWING		DRAWING NO 2499542	RESTRICTED TO -	SCALE 1:1
			SHEET 1 OF 10	REV A

2499542

REVISIONS				
P	LTR	DESCRIPTION	DATE	APVD
-	-	SEE SHEET 1	-	-

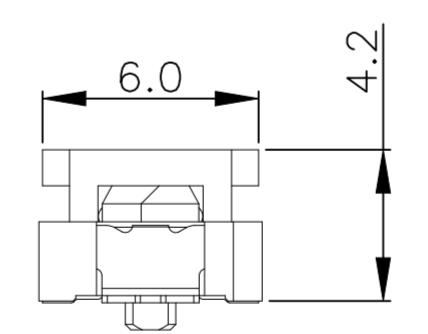
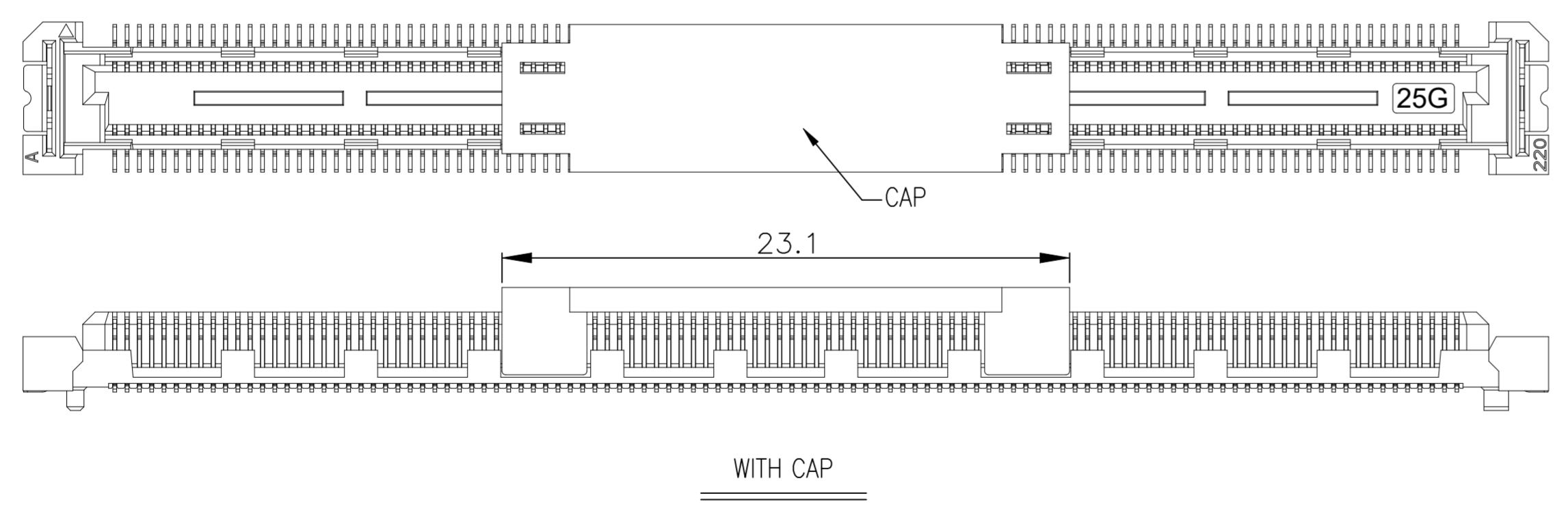
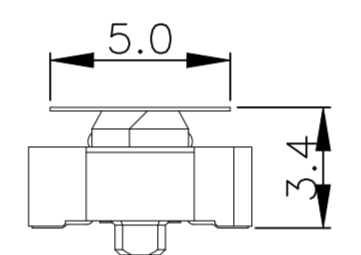
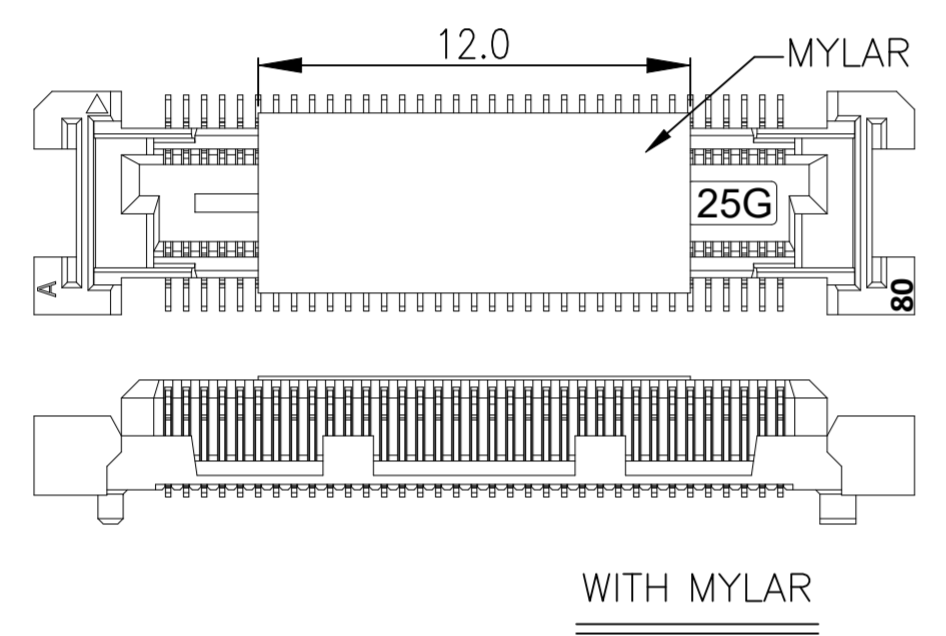
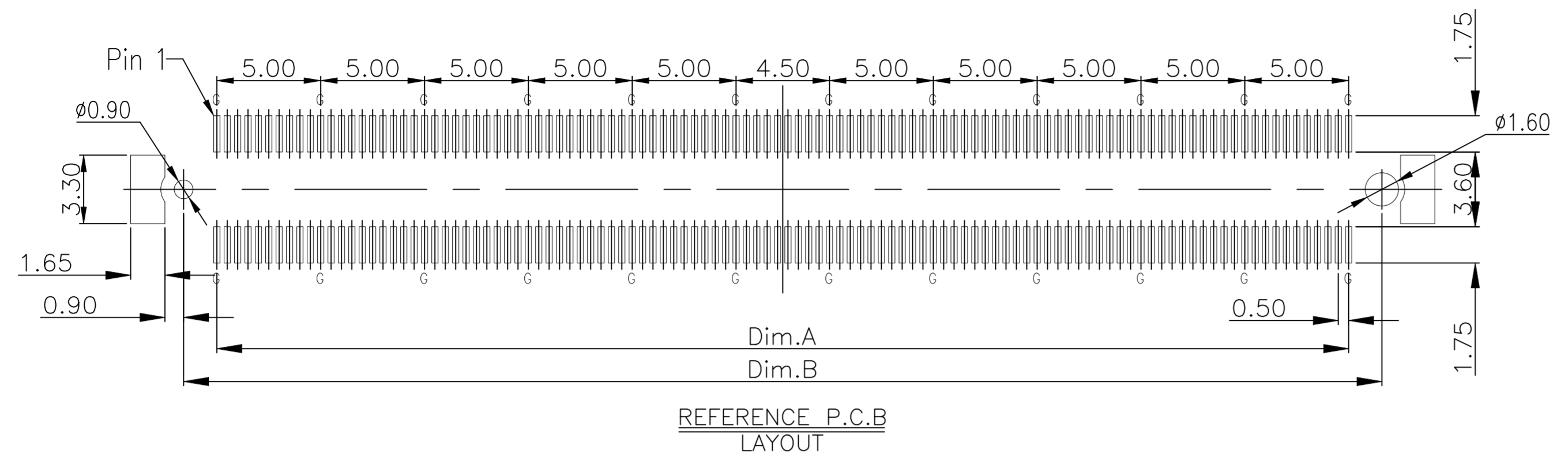

CAP	B0501WV-2BOA-5KRA3	2499542-5	220
	B0501WV-280A-5KRA3	2499542-4	160
	B0501WV-260A-5KRA3	2499542-3	120
MYLAR	B0501WV-240A-5KRA3	2499542-2	80
	B0501WV-220A-5KRA3	2499542-1	40
PICK MODE	MGF PART NO.	PART NO.	PIN NO

THIS DRAWING IS A CONTROLLED DOCUMENT.		DWN MANOJ K 18DEC2024	TE Connectivity	
DIMENSIONS: mm		CHK GOWTHAM CHITTY 18DEC2024		
TOLERANCES UNLESS OTHERWISE SPECIFIED:		APVD JAGRUTI MOHANTY 18DEC2024	NAME -	
0 PLC ± 0.50 1 PLC ± 0.20 2 PLC ± 0.10 3 PLC ± 0.05 4 PLC ± 0.05 ANGLES ± 3°		PRODUCT SPEC 108-161908	0.5 BTB Receptacle H3.25	
MATERIAL SEE NOTE		APPLICATION SPEC 114-161404	SIZE A2	RESTRICTED TO -
FINISH SEE NOTE		WEIGHT 0	CAGE CODE 00779	DRAWING NO G-2499542
		CUSTOMER DRAWING	SCALE 1:1	SHEET 2 OF 10
			REV A	

2499542

REVISIONS					
P	LTR	DESCRIPTION	DATE	DWN	APVD
-	-	SEE SHEET 1	-	-	-

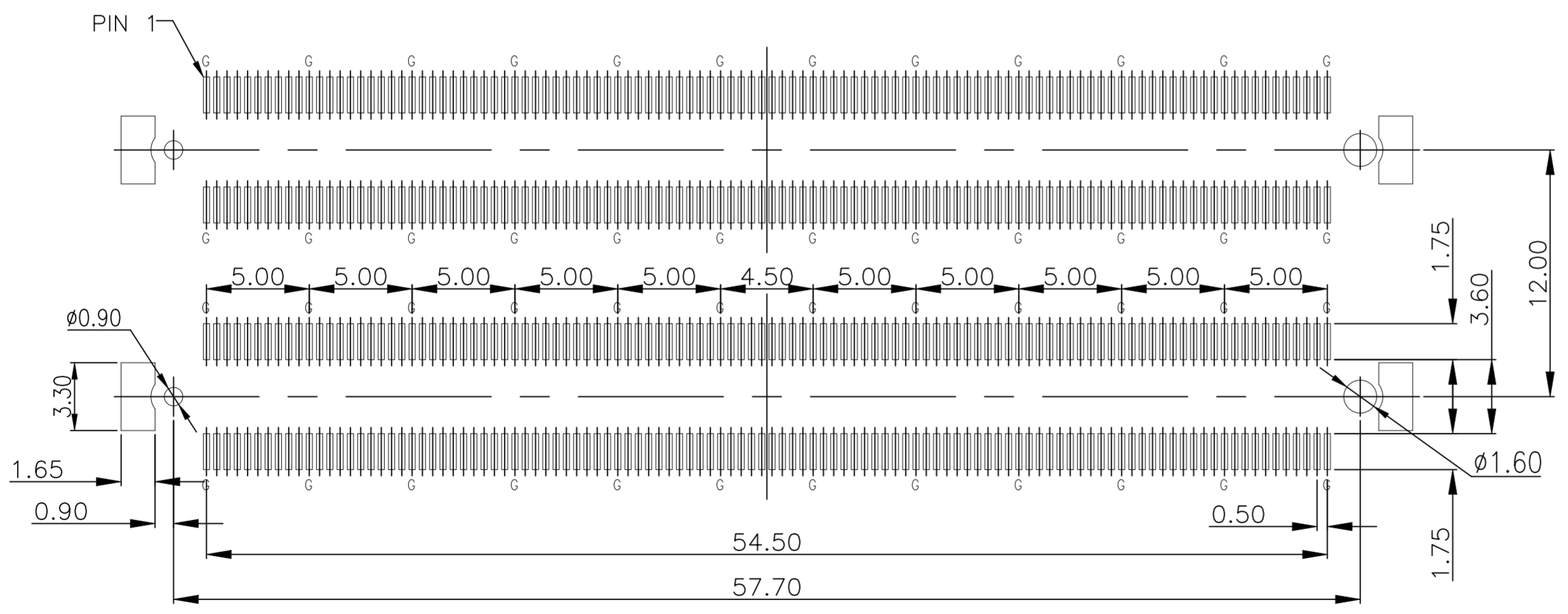
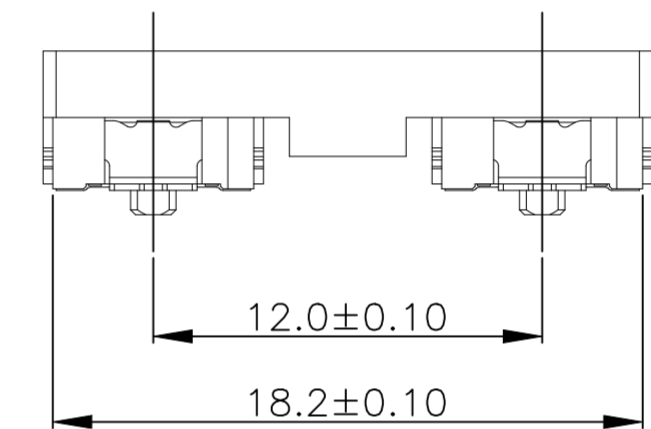
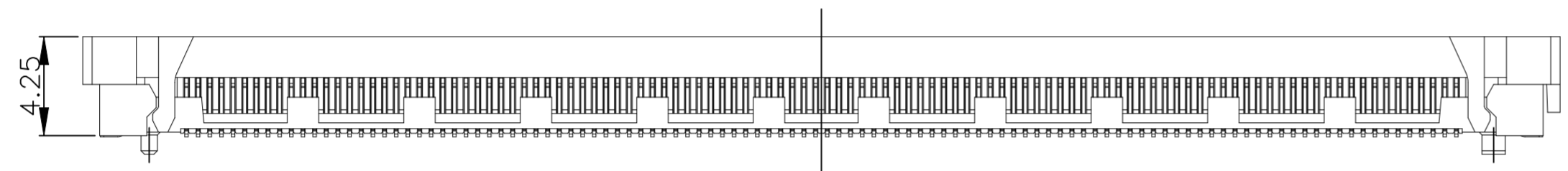
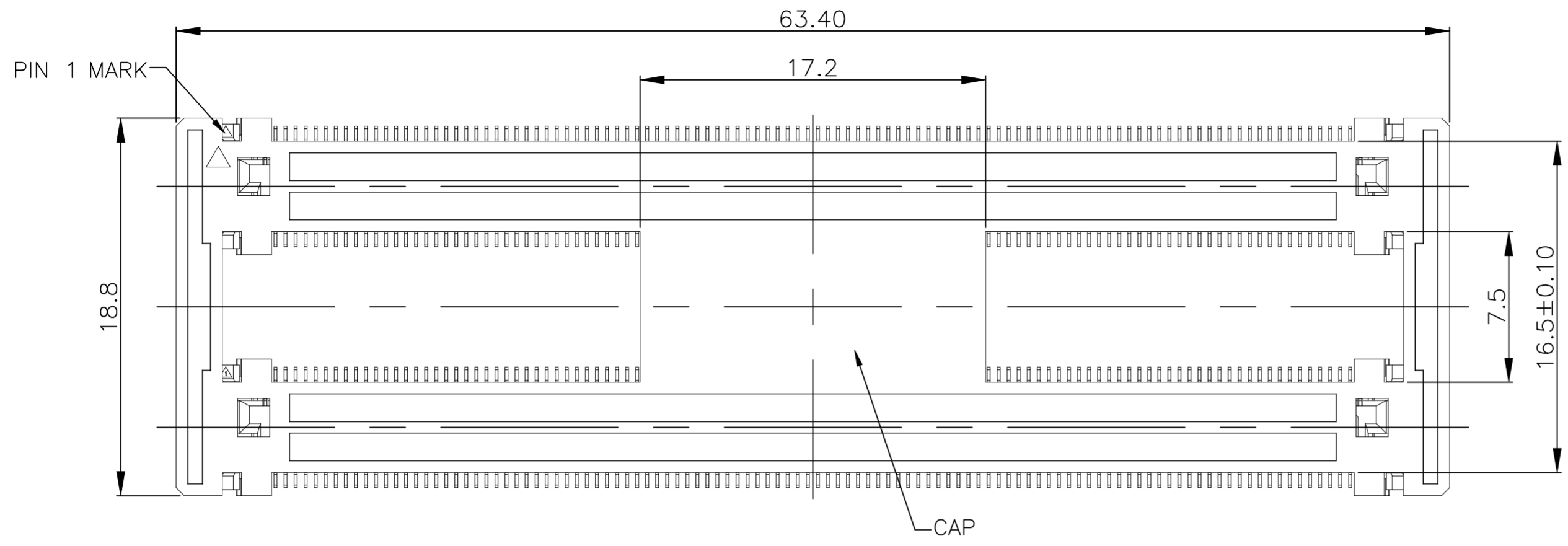

REFERENCE P.C.B LAYOUT

ABOVE SHOWN 440PINS(2499542-6)

THIS DRAWING IS A CONTROLLED DOCUMENT.		DWN MANOJ K 18DEC2024		
		CHK GOWTHAM CHITTY 18DEC2024		
		APVD JAGRUTI MOHANTY 18DEC2024	NAME	
		PRODUCT SPEC 108-161908	-	
		APPLICATION SPEC 114-161404	0.5 BTB Receptacle H3.25	
		WEIGHT 0	SIZE A2	CAGE CODE 00779
		CUSTOMER DRAWING	DRAWING NO 2499542	RESTRICTED TO -
		SCALE 1:1	SHEET 3 OF 10	REV A

2499542

REVISIONS				
P	LTR	DESCRIPTION	DATE	APVD
-	-	SEE SHEET 1	-	-

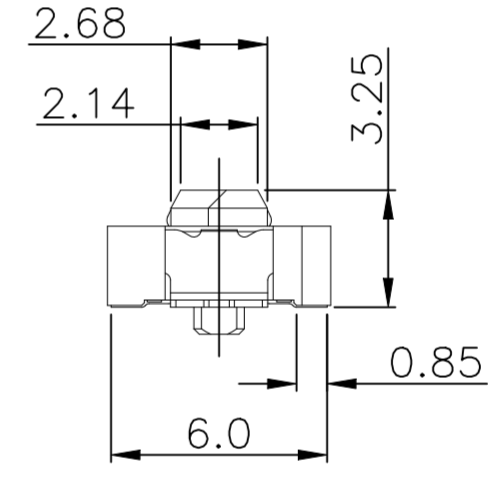
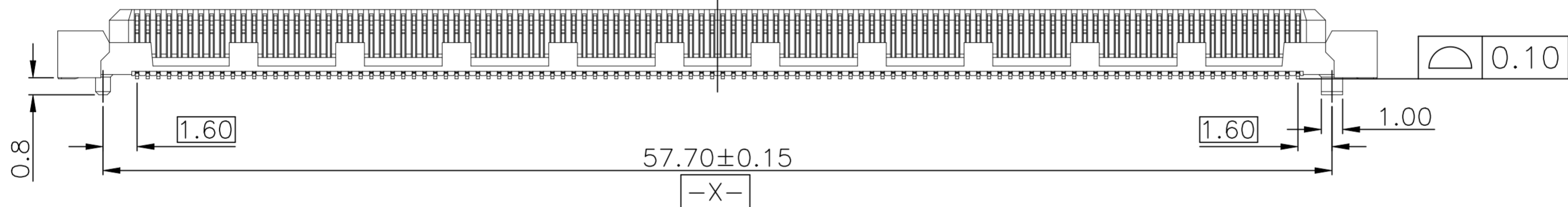
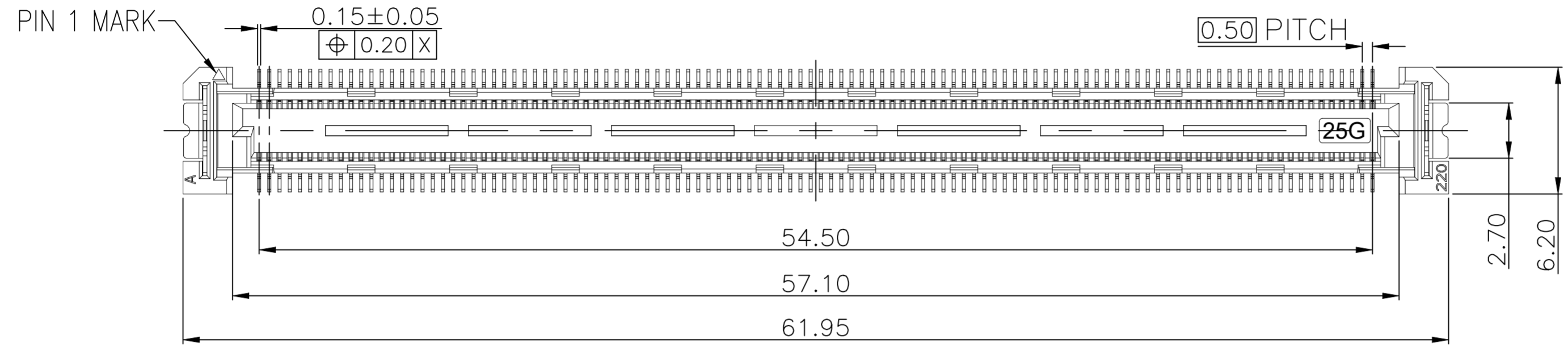

ABOVE SHOWN 440PINS(2499542-6)

THIS DRAWING IS A CONTROLLED DOCUMENT.		DWN MANOJ K 18DEC2024	TE Connectivity	
DIMENSIONS: mm		CHK GOWTHAM CHITTY 18DEC2024		
TOLERANCES UNLESS OTHERWISE SPECIFIED:		APVD JAGRUTI MOHANTY 18DEC2024	NAME -	
0 PLC ± 0.50 1 PLC ± 0.20 2 PLC ± 0.10 3 PLC ± 0.05 4 PLC ± 0.05 ANGLES ± 3°		PRODUCT SPEC 108-161908	0.5 BTB Receptacle H3.25	
MATERIAL SEE NOTE		APPLICATION SPEC 114-161404	SIZE A2	RESTRICTED TO -
FINISH SEE NOTE		WEIGHT 0	CAGE CODE 00779	DRAWING NO 2499542
		CUSTOMER DRAWING	SCALE 1:1	SHEET 4 OF 10
			REV A	

REVISIONS				
P	LTR	DESCRIPTION	DATE	APVD
-	-	SEE SHEET 1	-	-

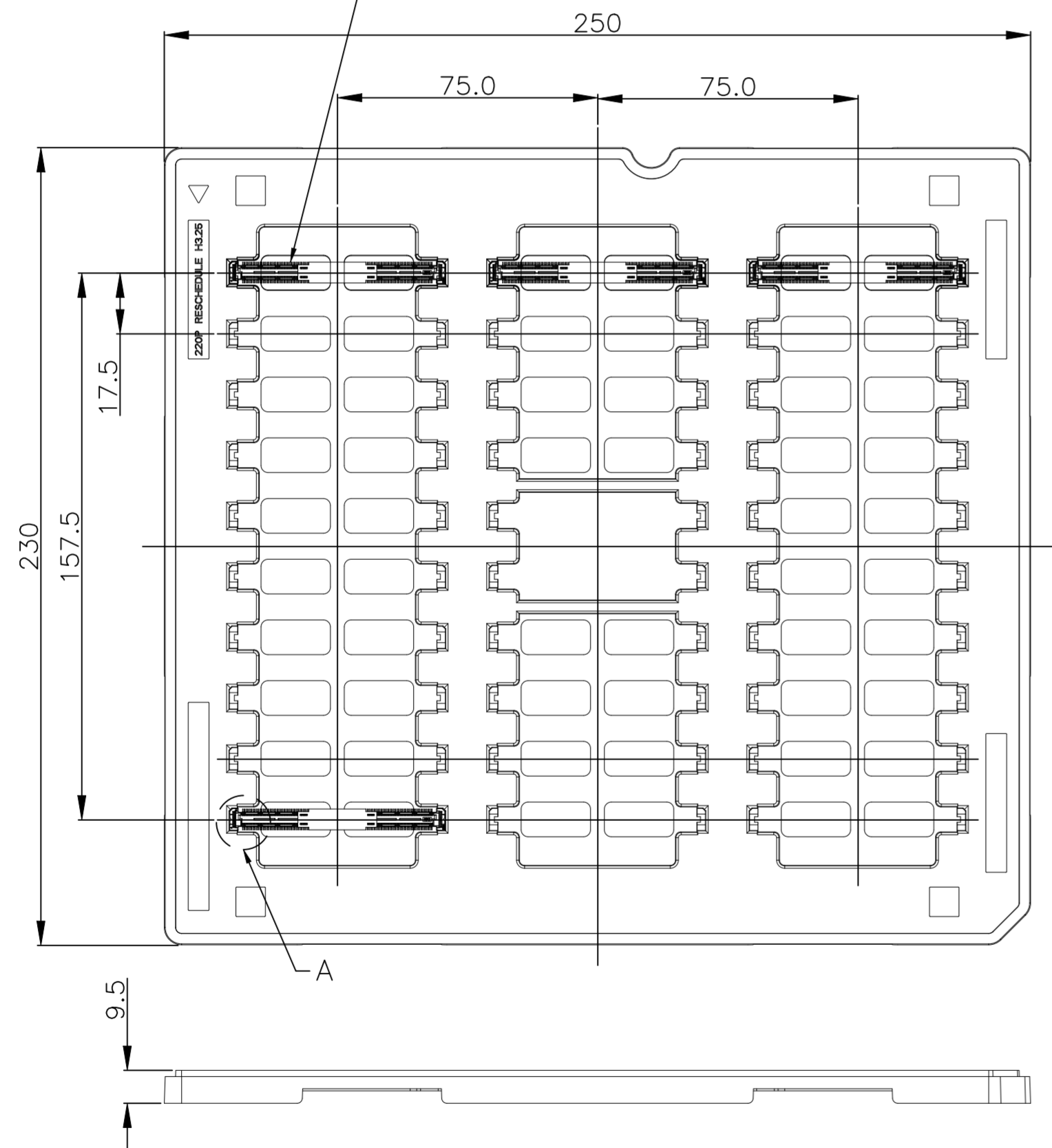

FIGURE 1

- NOTES:
- CORRECTLY PLACED, THE TRIANGLE SYMBOL OF THE TRAY DISK IS PLACED IN THE UPPER LEFT CORNER; THE TRIANGLE SYMBOL ON THE PRODUCT IS PIN 1, WHICH CORRESPONDS TO THE TRIANGLE IN THE UPPER LEFT CORNER OF THE TRAY DISK IN THE SAME DIRECTION, AND THE ANTI MISOPERATION PORT IS IN THE SAME DIRECTION AS THE TRAY ANTI MISOPERATION PORT.
  - THE ENTIRE TRAY IS FILLED WITH PRODUCTS, AND THE TRAY IS STACKED IN THE SAME DIRECTION. 20 TRAYS OF PRODUCTS PLUS 1 EMPTY TRAY FORM 1 BUNDLE, WITH LABELS ATTACHED TO THE EMPTY TRAYS. PE FILM IS USED TO CROSS WRAP AT LEAST 2 TURNS (WIDTH 60MM) AS SHOWN IN FIGURE 2

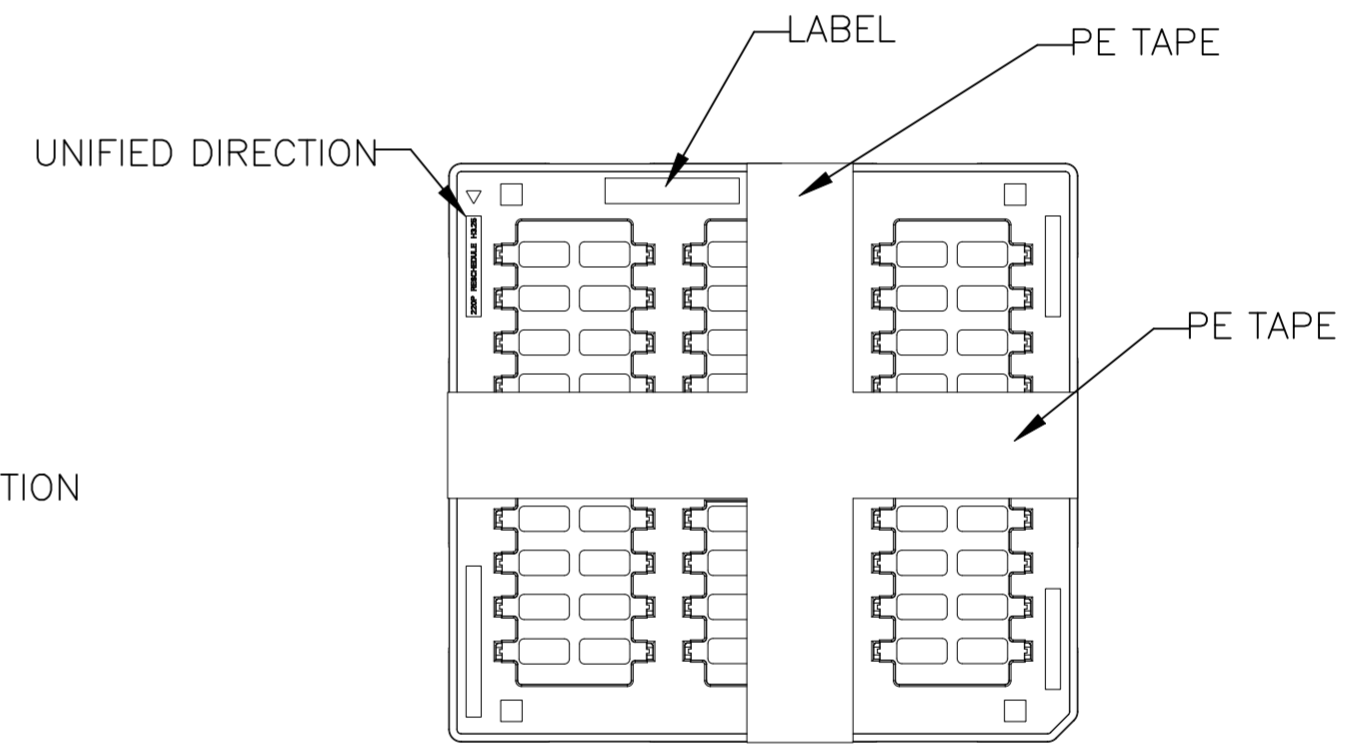
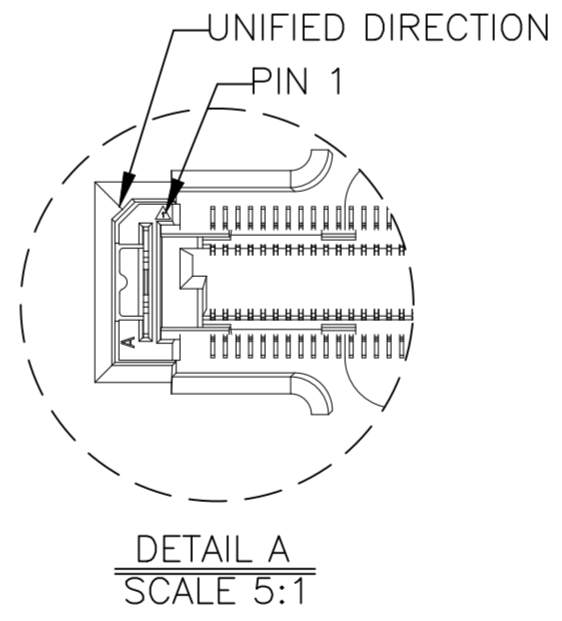

FIGURE 2

THIS DRAWING IS A CONTROLLED DOCUMENT.		DWN MANOJ K 18DEC2024	TE Connectivity													
		CHK GOWTHAM CHITTY 18DEC2024														
		APVD JAGRUTI MOHANTY 18DEC2024	NAME													
		PRODUCT SPEC 108-161908	-													
		APPLICATION SPEC 114-161404	0.5 BTB Receptacle H3.25													
DIMENSIONS: mm		TOLERANCES UNLESS OTHERWISE SPECIFIED:	SIZE A2	CAGE CODE 00779												
<table border="0"> <tr><td>0 PLC</td><td>± 0.50</td></tr> <tr><td>1 PLC</td><td>± 0.20</td></tr> <tr><td>2 PLC</td><td>± 0.10</td></tr> <tr><td>3 PLC</td><td>± 0.05</td></tr> <tr><td>4 PLC</td><td>± 0.05</td></tr> <tr><td>ANGLES</td><td>± 3'</td></tr> </table>		0 PLC	± 0.50	1 PLC	± 0.20	2 PLC	± 0.10	3 PLC	± 0.05	4 PLC	± 0.05	ANGLES	± 3'	FINISH	DRAWING NO 2499542	RESTRICTED TO -
0 PLC	± 0.50															
1 PLC	± 0.20															
2 PLC	± 0.10															
3 PLC	± 0.05															
4 PLC	± 0.05															
ANGLES	± 3'															
MATERIAL SEE NOTE		WEIGHT 0	SCALE 1:1	SHEET 5 OF 10												
		CUSTOMER DRAWING	REV A													

2499542

REVISIONS				
P	LTR	DESCRIPTION	DATE	APVD
-	-	SEE SHEET 1	-	-

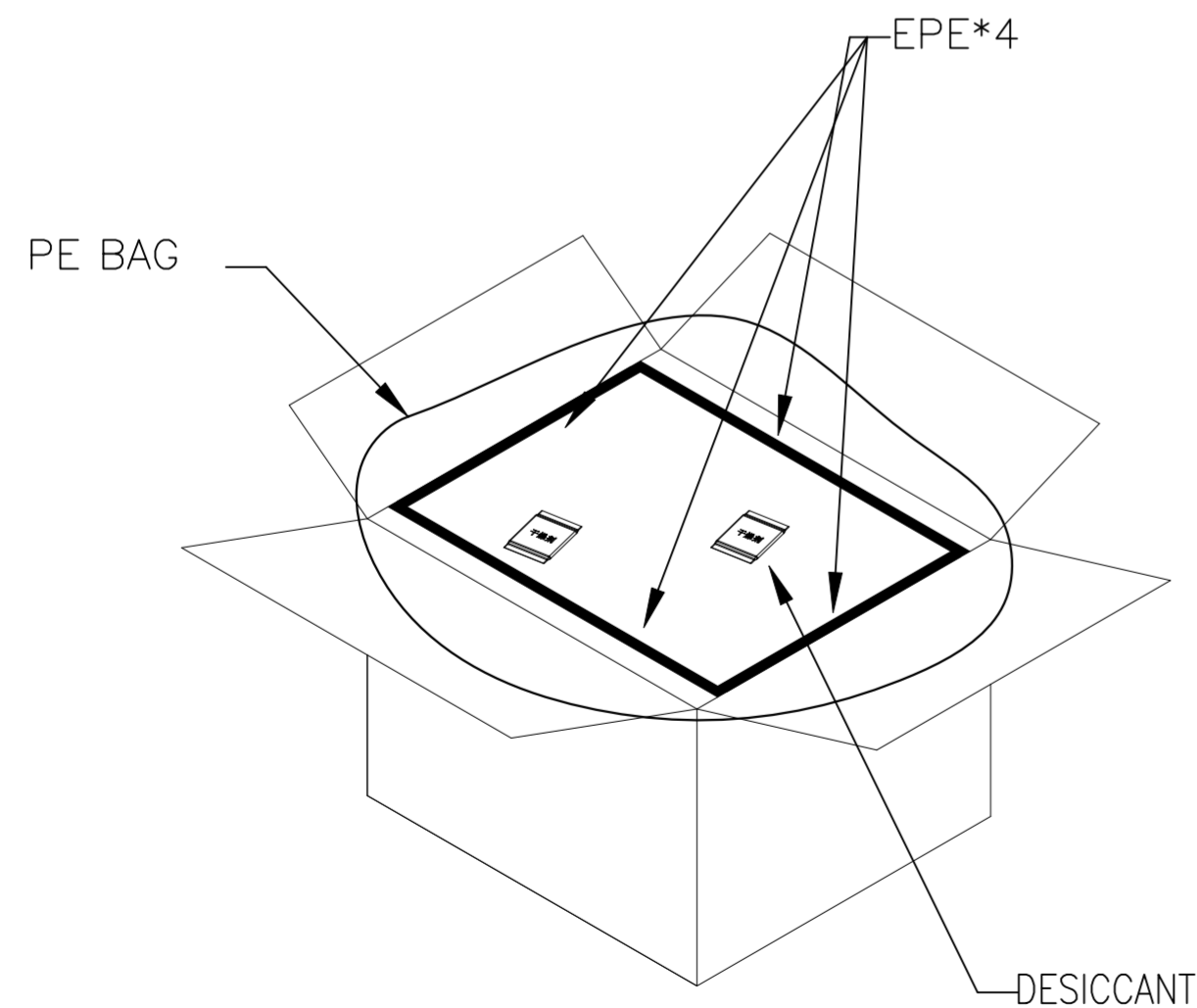
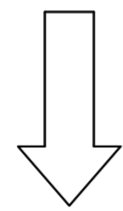
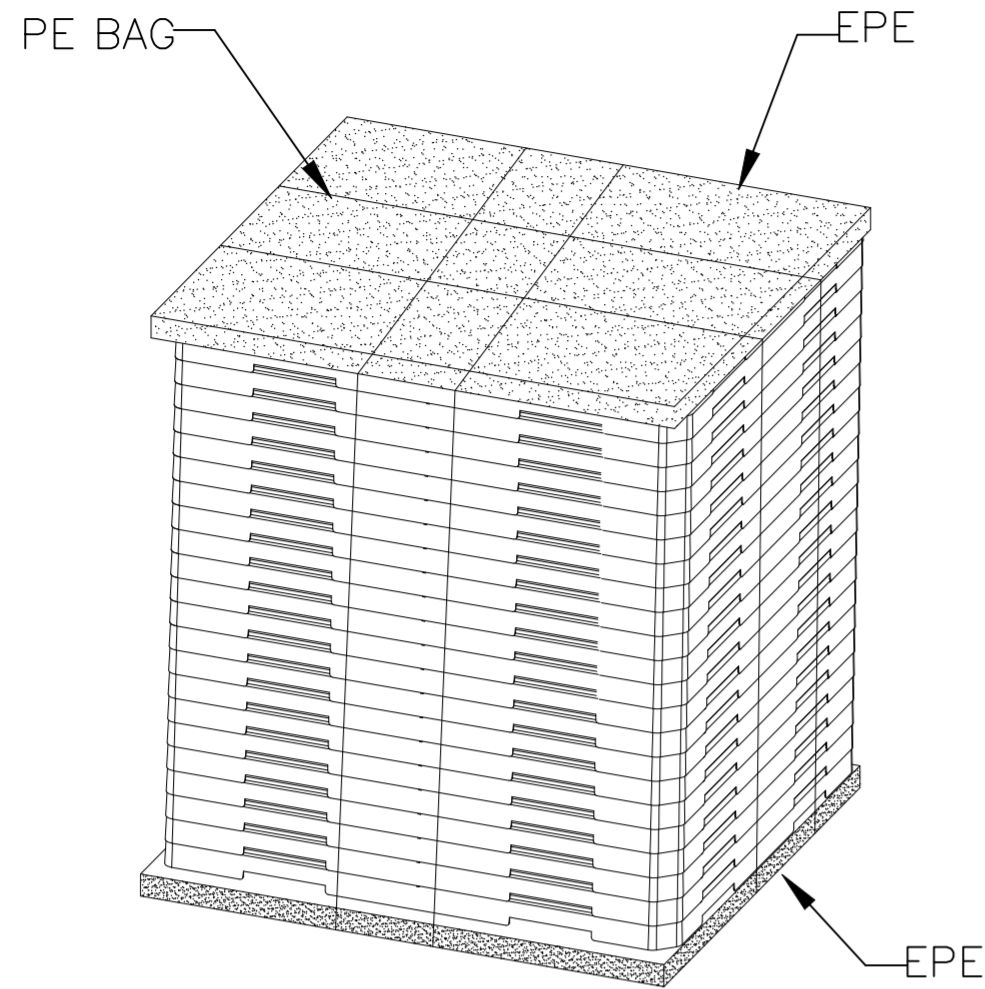

FIGURE 3

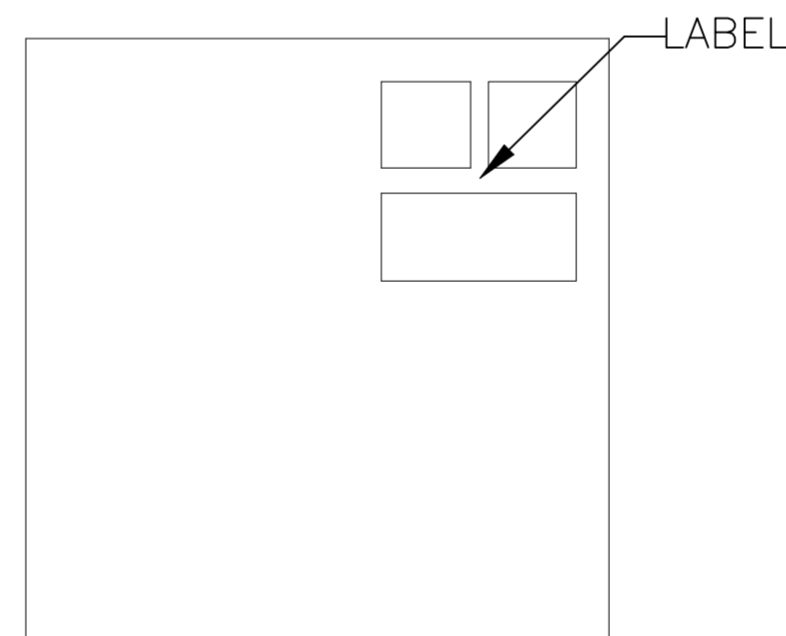

FIGURE 4

NOTES:

1. WATERPROOF BAGS NEED TO BE TAPED TIGHTLY AND SEALED.  
IF THERE ARE ANY UNFILLED BOXES, THEY MUST BE FILLED WITH CUSHIONING MATERIALS
2. FILL THE OUTER BOX WITH FINISHED PRODUCTS, MAXIMUM NUMBER OF STACKED BOXES: 5 BOXES.
3. WRAP THE WHOLE BUNDLE OF PRODUCTS FIRMLY WITH PE FILM;
4. PLACE ONE PEARL AT THE BOTTOM OF THE BOX, AND ONE PEARL COTTON ON EACH SIDE OF THE INNER BOX;  
WRAP THE PRODUCT IN THE THIRD STEP AND PUT IT IN A PE BAG, THEN PLACE A DESICCANT INSIDE. PUT IT INTO A CARDBOARD BOX AND SEAL THE PE BAG WITH ADHESIVE TAPE (WITH THE BOTTOM OF THE TRAY FACING DOWNWARDS). PLACE A PIECE OF PEARL COTTON ON TOP OF IT; (AS SHOWN IN FIGURE 3)
5. THE CARDBOARD BOX IS SEALED WITH A "WORKER" AND A LABEL IS ATTACHED AT THE LABEL STICKING POINT; (AS SHOWN IN FIGURE 4)

TRAY	250*230*9.5
Pcs/TRAY	30
TRAY/CARTON	20
Pcs/CARTON	600
CARTON SIZE	300*280*220

SPEC.	PART NO.	Pcs/CARTON	600
25G	2499542-5	CARTON SIZE	300*280*220

THIS DRAWING IS A CONTROLLED DOCUMENT.		DWN MANOJ K 18DEC2024	TE Connectivity	
DIMENSIONS: mm		CHK GOWTHAM CHITTY 18DEC2024	NAME -	
TOLERANCES UNLESS OTHERWISE SPECIFIED:		APVD JAGRUTI MOHANTY 18DEC2024	PRODUCT SPEC -	
0 PLC ± 0.50 1 PLC ± 0.20 2 PLC ± 0.10 3 PLC ± 0.05 4 PLC ± 0.05 ANGLES ± 3°		APPLICATION SPEC 108-161908	0.5 BTB Receptacle H3.25	
MATERIAL SEE NOTE	FINISH SEE NOTE	WEIGHT 0	SIZE A2	CAGE CODE 00779
CUSTOMER DRAWING		DRAWING NO G-2499542	RESTRICTED TO -	SCALE 1:1
		SHEET 6 OF 10	REV A	

REVISIONS				
P	LTR	DESCRIPTION	DATE	APVD
-	-	SEE SHEET 1	-	-

1. 22 SPACES ARE RESERVED AT THE BEGINNING OF THE PACKAGING, AND THE CARRIER TAPE AND SELF-ADHESIVE FILM ARE CUT FLAT WITH THE CARRIER TAPE AND TAPED TOGETHER ADHERE TIGHTLY TO THE AXIS OF THE REEL, ALIGN THE PRODUCT DIRECTION, AND PLACE THEM IN SEQUENCE, AS SHOWN IN FIGURE 1.

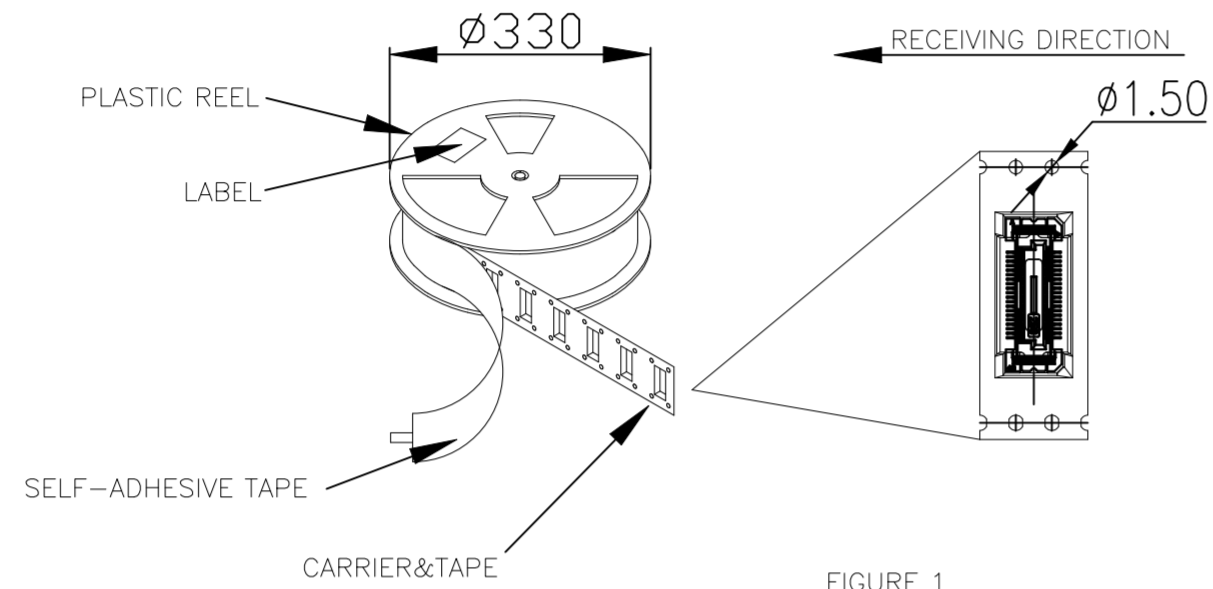

FIGURE 1

2. 22 SPACES SHOULD BE RESERVED FOR THE FINAL CARRIER TAPE OF THE PACKAGING, AND THE LAST END SHOULD BE SELF-ADHESIVE FILM AND CARRIER TAPE CUT IT FLAT AND FIX IT WITH ADHESIVE TAPE. THE EDGE OF THE REEL ALSO NEEDS TO BE FIXED WITH ADHESIVE TAPE. STICK IT ON THE REEL PRODUCT PACKAGING LABEL (ATTACHED TO ONE SIDE OF THE SMALL HOLE ON THE REEL), INDICATING THE PART NUMBER, QUANTITY, AND MANUFACTURING DATE, AS SHOWN IN FIGURE 2 (IF THE CUSTOMER HAS SPECIAL REQUIREMENTS, FOLLOW THE CUSTOMER'S REQUIREMENTS).

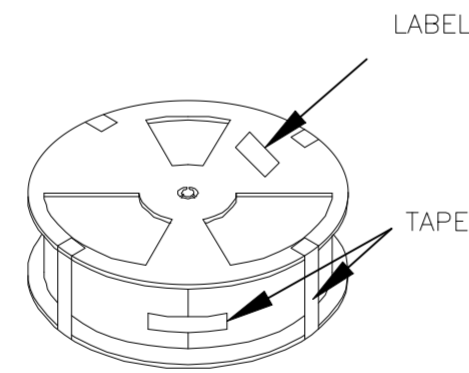

FIGURE 2

3.
  - a). PACKAGING AS SHOWN IN THE DIAGRAM: THE REEL IS PACKED IN A WATERPROOF BAG, WITH 2PCS DESICCANT PLACED ON TOP AND BOTTOM, AND PADDING PLACED ON TOP AND BOTTOM 1PCS PEARL COTTON. THE TAPE SHALL NOT BE BROKEN, AND THE REEL THAT IS NOT FULLY ROLLED SHALL BE PACKED INTO ZERO BOXES AND SEALED WITH TAPE.
  - b). PLEASE REFER TO THE NEXT PAGE FOR THE QUANTITY OF PACKAGING IN ONE ROLL.
  - c). PLEASE REFER TO THE NEXT PAGE FOR THE QUANTITY OF PACKAGING IN ONE CARDBOARD BOX.

4. STICK THE LABEL ON THE TOP SIDE OF THE CARDBOARD BOX. IF THE CUSTOMER HAS SPECIAL REQUIREMENTS, FOLLOW THEM.

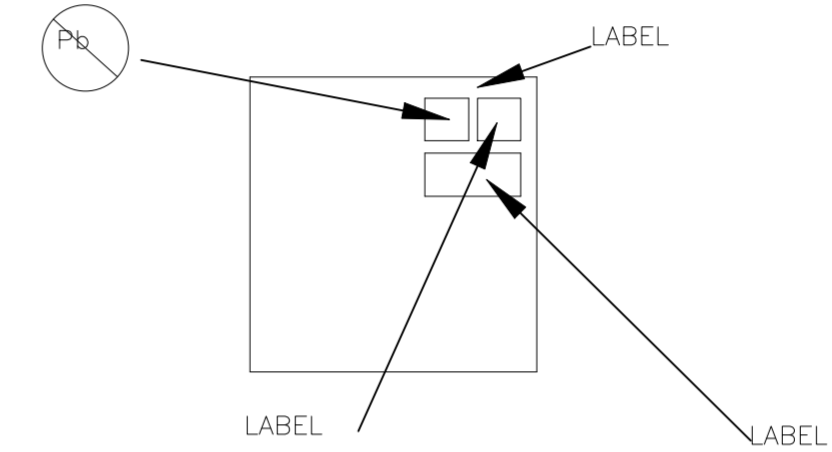

FIGURE 4

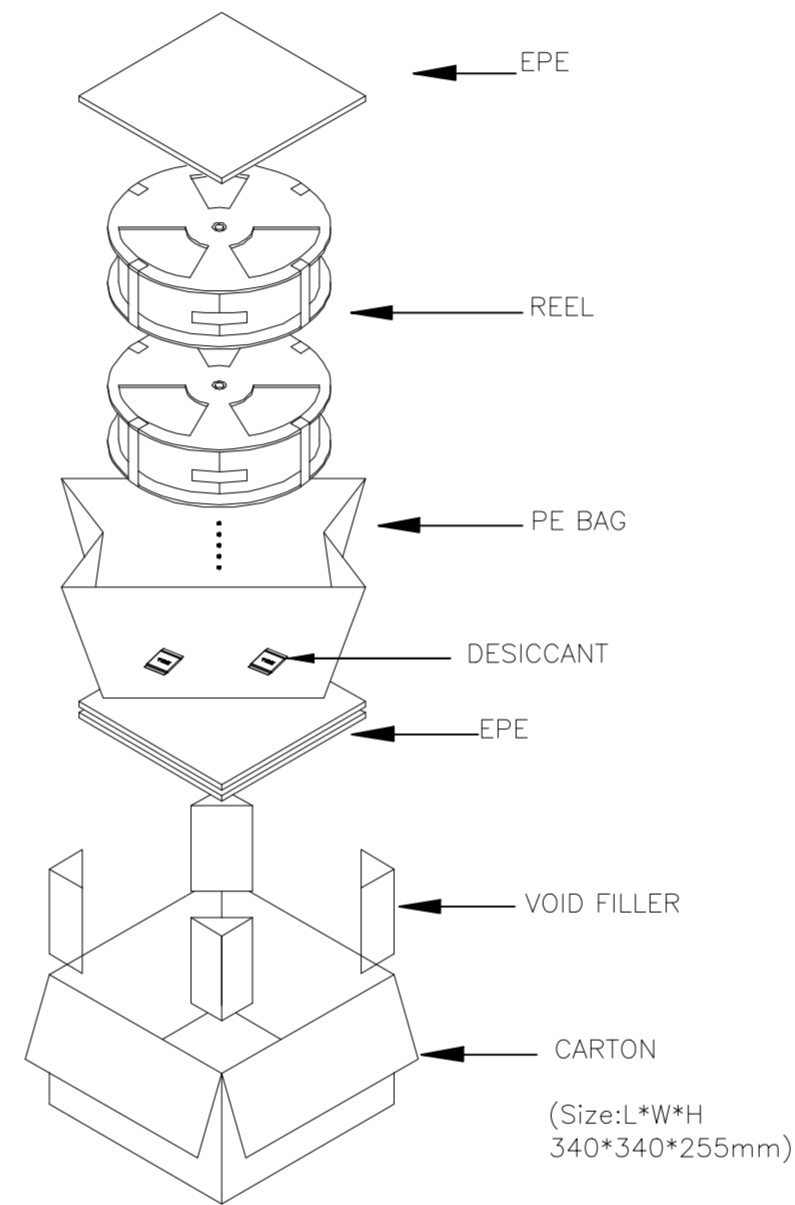
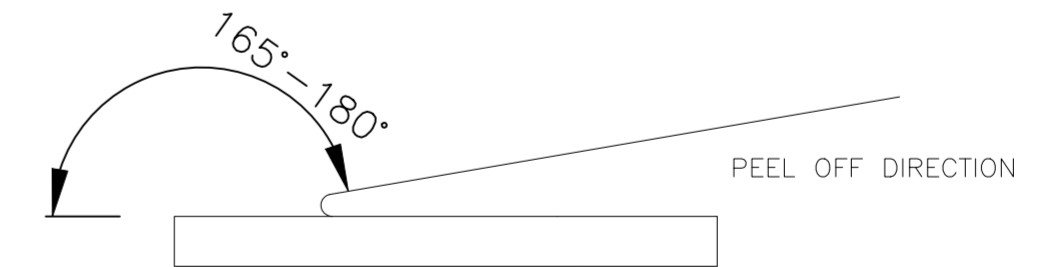

FIGURE 3

5. THE REQUIREMENT FOR UPPER TAPE PEELING FORCE IS:  
 CARRIER TAPE WIDTH  $\leq 56\text{MM}$ :10-130GF  
 CARRIER TAPE WIDTH  $\geq 72\text{MM}$ :10-150GF



THIS DRAWING IS A CONTROLLED DOCUMENT.		DWN MANOJ K 18DEC2024		
		CHK GOWTHAM CHITTY 18DEC2024		
		APVD JAGRUTI MOHANTY 18DEC2024	NAME -	
		PRODUCT SPEC 108-161908	0.5 BTB Receptacle H3.25	
		APPLICATION SPEC 114-161404	-	
MATERIAL SEE NOTE		FINISH SEE NOTE	SIZE A2	CAGE CODE 00779
		WEIGHT 0	DRAWING NO G-2499542	RESTRICTED TO -
		CUSTOMER DRAWING		SCALE 1:1
		SHEET 7 OF 10		REV A

REVISIONS				
P	LTR	DESCRIPTION	DATE	APVD
-	-	SEE SHEET 1	-	-

- NOTES:
1. THERE ARE EMPTY BOXES THAT MUST BE FILLED WITH CUSHIONING MATERIALS
  2. PACKAGING MATERIALS CAN BE FOUND ON THIS PAGE
  3. WATERPROOF BAGS NEED TO BE TAPED TIGHTLY AND SEALED
  4. FILL THE OUTER BOX WITH FINISHED PRODUCTS, MAXIMUM NUMBER OF STACKED BOXES: 5 BOXES

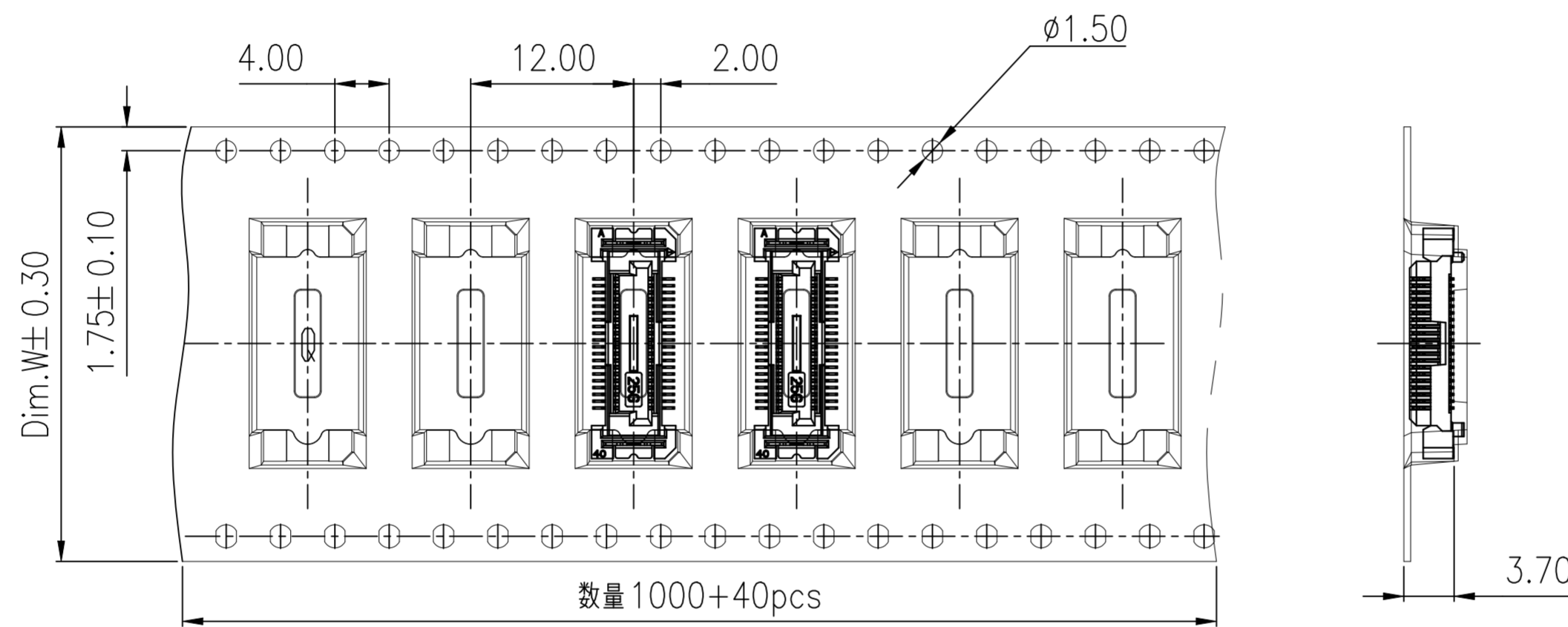

ITEM	QTY
CARTON	1 Pcs
PE BAG	1 Pcs
EPE	2 Pcs
DESICCANT	2 Pcs
CARRIER&TAPE	X/R(See table)
PLASTIC REEL	X/R(See table)
SELF-ADHESIVE TAPE	A/R
VOID FILLER	4 Pcs

PIN NO.	PRODUCT NO.	PACKING CAPACITY			
		DIM.W	Pcs/REEL	REELS/CARTON	Pcs/CARTON
160	2499542-4	72mm	1000	3R	3000
120	2499542-3	56mm	1000	4R	4000
80	2499542-2	44mm	1000	5R	5000
40	2499542-1	32mm	1000	6R	6000

THIS DRAWING IS A CONTROLLED DOCUMENT.		DWN MANOJ K 18DEC2024	TE Connectivity													
		CHK GOWTHAM CHITTY 18DEC2024														
		APVD JAGRUTI MOHANTY 18DEC2024	NAME													
		PRODUCT SPEC 108-161908	-													
		APPLICATION SPEC 114-161404	0.5 BTB Receptacle H3.25													
DIMENSIONS: mm		TOLERANCES UNLESS OTHERWISE SPECIFIED:	SIZE A2	CAGE CODE 00779												
<table border="0"> <tr> <td>0 PLC</td> <td>± 0.50</td> </tr> <tr> <td>1 PLC</td> <td>± 0.20</td> </tr> <tr> <td>2 PLC</td> <td>± 0.10</td> </tr> <tr> <td>3 PLC</td> <td>± 0.05</td> </tr> <tr> <td>4 PLC</td> <td>± 0.05</td> </tr> <tr> <td>ANGLES</td> <td>± 3'</td> </tr> </table>		0 PLC	± 0.50	1 PLC	± 0.20	2 PLC	± 0.10	3 PLC	± 0.05	4 PLC	± 0.05	ANGLES	± 3'	WEIGHT 0	DRAWING NO C-2499542	RESTRICTED TO -
0 PLC	± 0.50															
1 PLC	± 0.20															
2 PLC	± 0.10															
3 PLC	± 0.05															
4 PLC	± 0.05															
ANGLES	± 3'															
MATERIAL SEE NOTE		FINISH SEE NOTE	CUSTOMER DRAWING													
		SCALE 1:1	SHEET 8 of 10	REV A												

REVISIONS					
P	LTR	DESCRIPTION	DATE	DWN	APVD
-	-	SEE SHEET 1	-	-	-

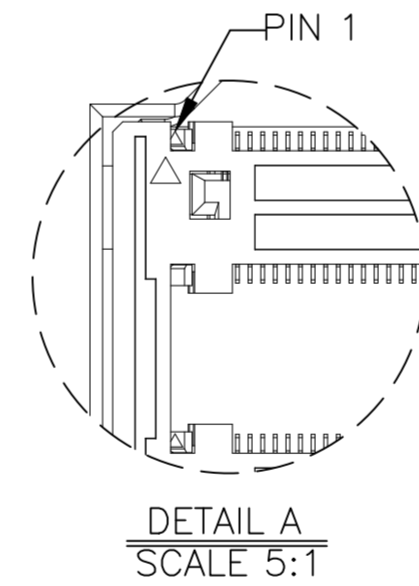
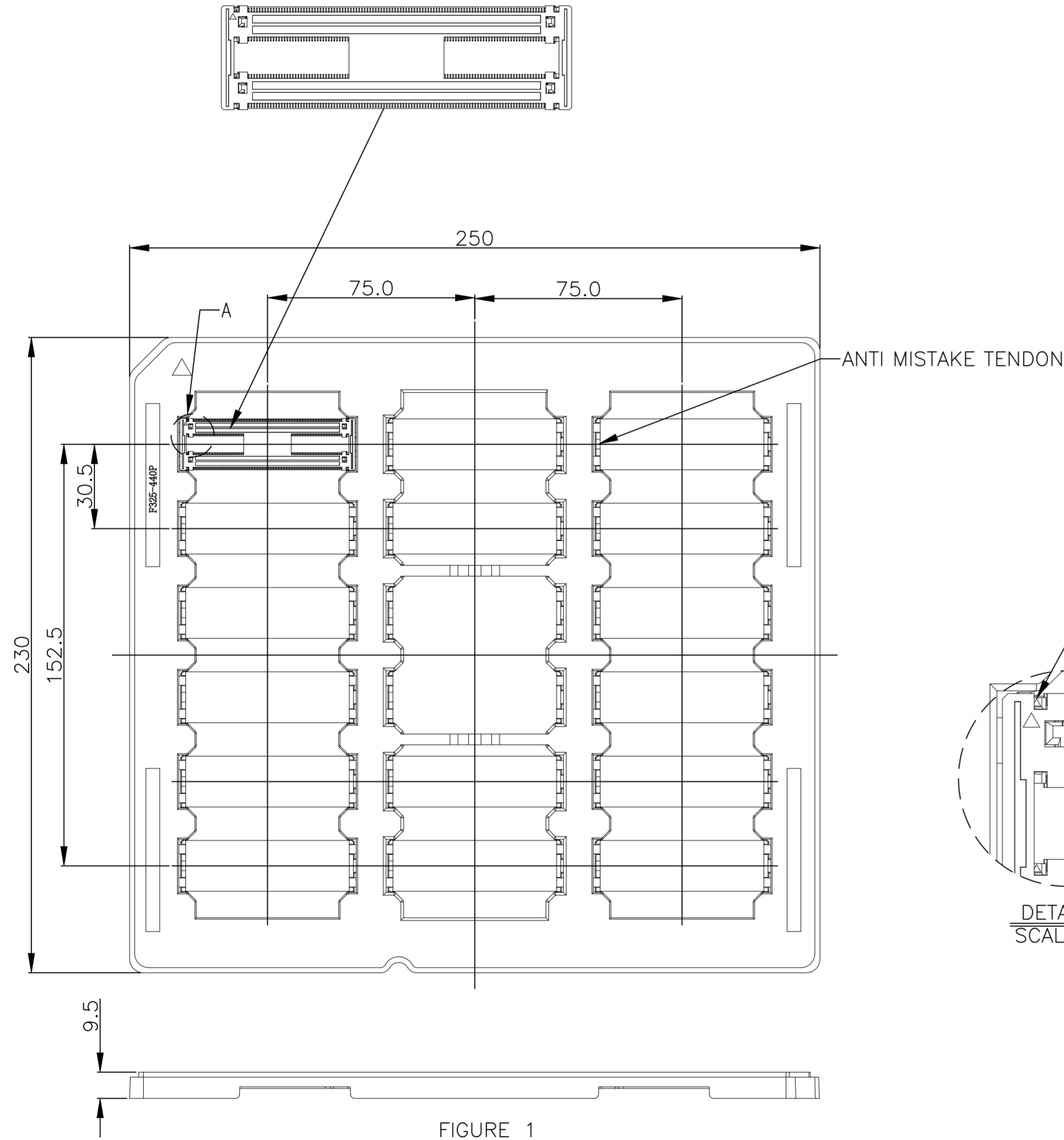

- NOTES:
1. CORRECTLY PLACED, THE TRIANGLE SYMBOL OF THE TRAY DISK IS PLACED IN THE UPPER LEFT CORNER; THE TRIANGLE SYMBOL ON THE PRODUCT IS PIN 1, WHICH CORRESPONDS TO THE TRIANGLE IN THE UPPER LEFT CORNER OF THE TRAY DISK IN THE SAME DIRECTION, AND THE ANTI MISOPERATION PORT IS IN THE SAME DIRECTION AS THE TRAY ANTI MISOPERATION PORT.
  2. THE ENTIRE TRAY IS FILLED WITH PRODUCTS, AND THE TRAY IS STACKED IN THE SAME DIRECTION. 20 TRAYS OF PRODUCTS PLUS 1 EMPTY TRAY FORM 1 BUNDLE, WITH LABELS ATTACHED TO THE EMPTY TRAYS. PE TAPE IS USED TO CROSS WRAP AT LEAST 2 TURNS (WIDTH 60MM) AS SHOWN IN FIGURE 2

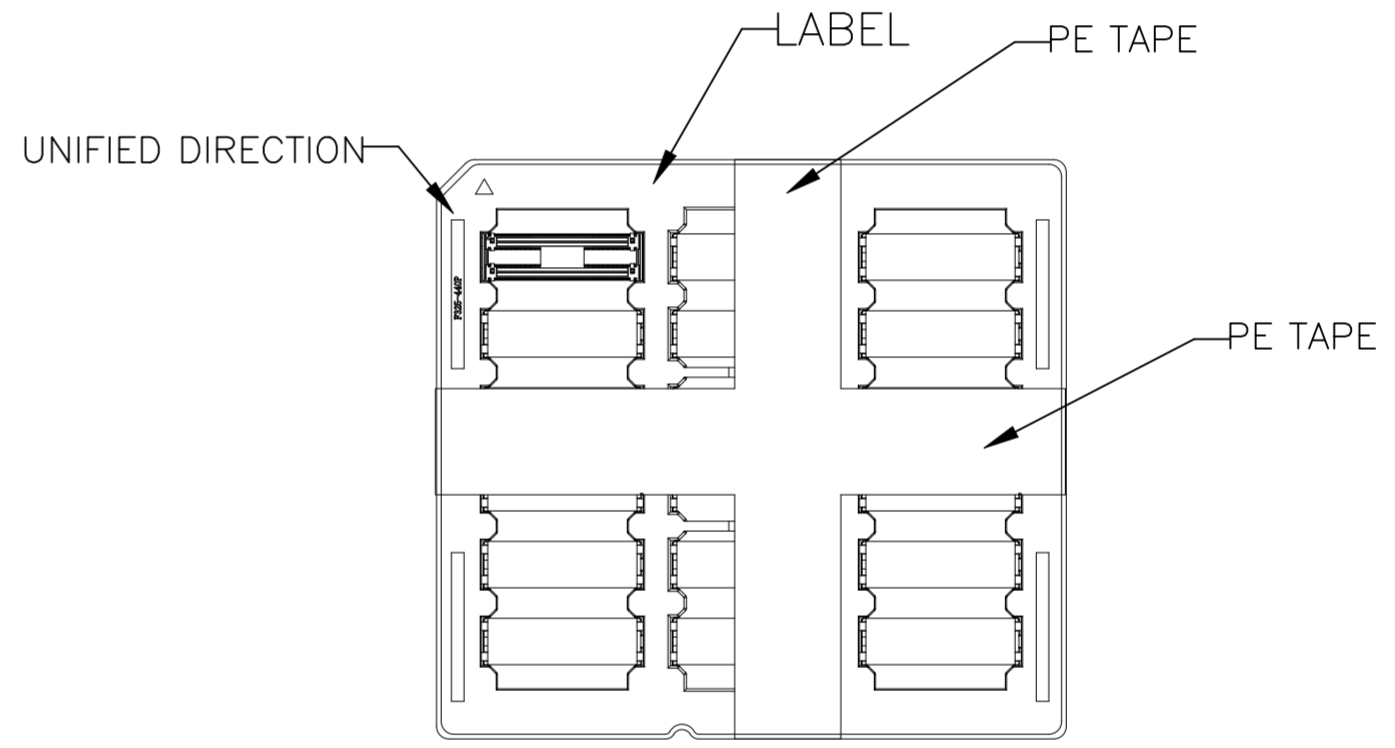

FIGURE 2

FOR PART:2499542-6

THIS DRAWING IS A CONTROLLED DOCUMENT.		DWN MANOJ K 18DEC2024	TE Connectivity	
		CHK GOWTHAM CHITTY 18DEC2024		
		APVD JAGRUTI MOHANTY 18DEC2024	NAME -	
DIMENSIONS: mm		PRODUCT SPEC 108-161908		0.5 BTB Receptacle H3.25
TOLERANCES UNLESS OTHERWISE SPECIFIED:		APPLICATION SPEC 114-161404		RESTRICTED TO -
0 PLC ± 0.50 1 PLC ± 0.20 2 PLC ± 0.10 3 PLC ± 0.05 4 PLC ± ANGLES ± 3°		SIZE A2	CAGE CODE 00779	DRAWING NO 2499542
MATERIAL SEE NOTE		WEIGHT 0		SCALE 1:1
		CUSTOMER DRAWING		SHEET 9 OF 10
				REV A

2499542

REVISIONS				
P	LTR	DESCRIPTION	DATE	APVD
-	-	SEE SHEET 1	-	-

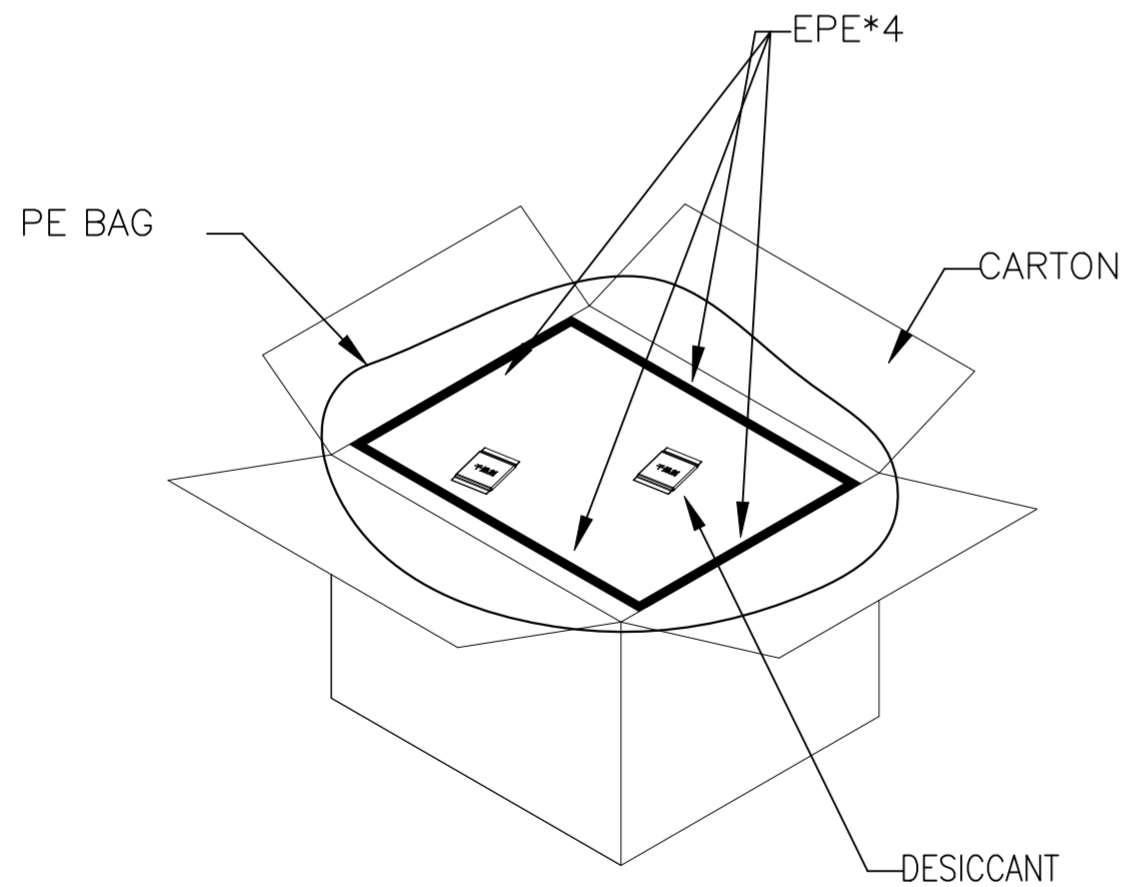
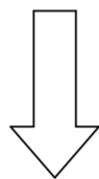
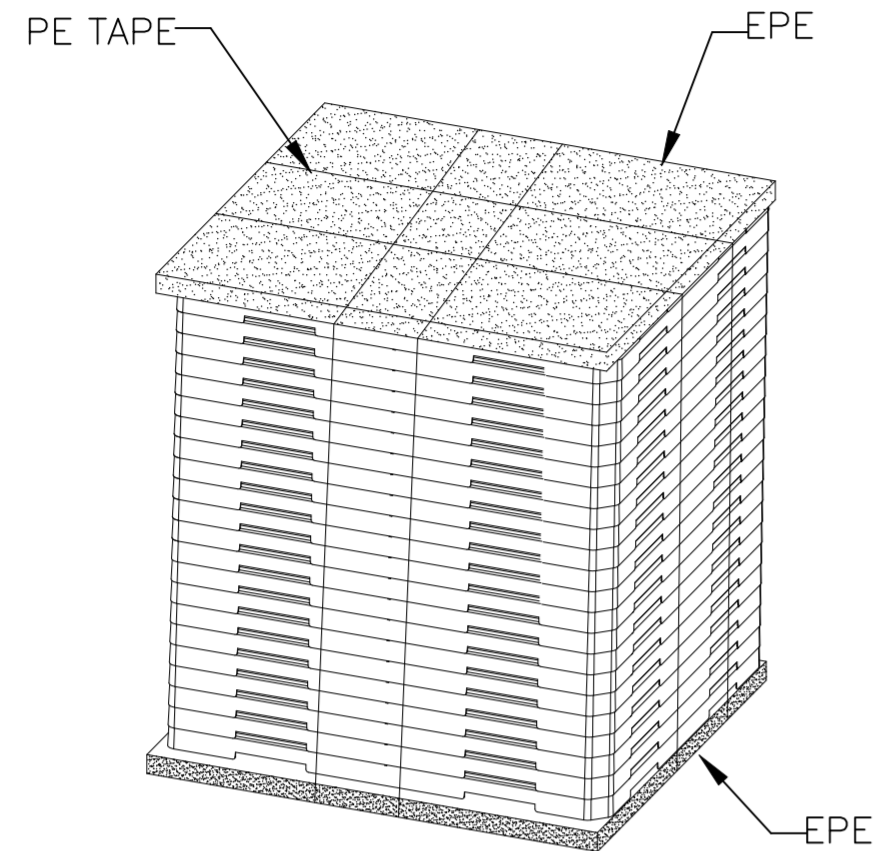

FIGURE 3

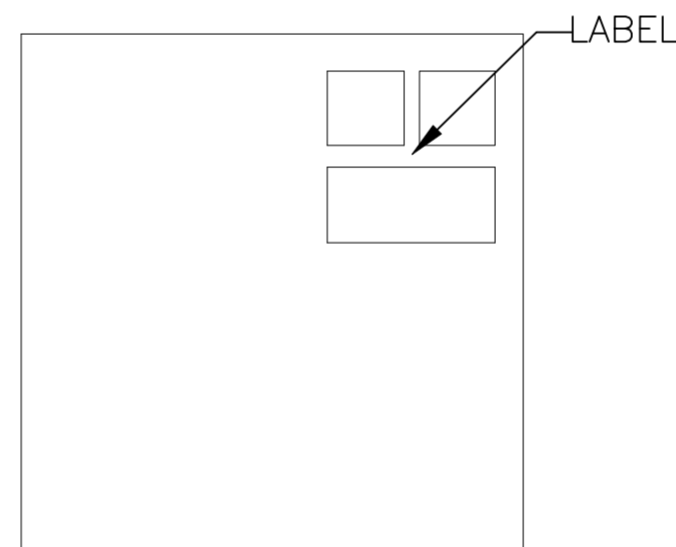

FIGURE 4

NOTES:

1. WATERPROOF BAGS NEED TO BE TAPED TIGHTLY AND SEALED. IF THERE ARE ANY UNFILLED BOXES, THEY MUST BE FILLED WITH CUSHIONING MATERIALS
2. FILL THE OUTER BOX WITH FINISHED PRODUCTS, MAXIMUM NUMBER OF STACKED BOXES: 5 BOXES.
3. WRAP THE WHOLE BUNDLE OF PRODUCTS FIRMLY WITH PE FILM;
4. PLACE ONE PEARL AT THE BOTTOM OF THE BOX, AND ONE PEARL COTTON ON EACH SIDE OF THE INNER BOX; WRAP THE PRODUCT IN THE THIRD STEP AND PUT IT IN A PE BAG, THEN PLACE A DESICCANT INSIDE. PUT IT INTO A CARDBOARD BOX AND SEAL THE PE BAG WITH ADHESIVE TAPE (WITH THE BOTTOM OF THE TRAY FACING DOWNWARDS). PLACE A PIECE OF PEARL COTTON ON TOP OF IT; (AS SHOWN IN FIGURE 3)
5. THE CARDBOARD BOX IS SEALED WITH A "WORKER" AND A LABEL IS ATTACHED AT THE LABEL STICKING POINT; (AS SHOWN IN FIGURE 4)

	TRAY	250*230*9.5	
	Pcs/TRAY	18	
	TRAY/CARTON	20	
SPEC.	PART NO.	Pcs/CARTON	360
25G	2499542-6	CARTON SIZE	300*280*220

THIS DRAWING IS A CONTROLLED DOCUMENT.		DWN MANOJ K 18DEC2024	TE Connectivity	
DIMENSIONS: mm		CHK GOWTHAM CHITTY 18DEC2024		
TOLERANCES UNLESS OTHERWISE SPECIFIED:		APVD JAGRUTI MOHANTY 18DEC2024	NAME -	
0 PLC ± 0.50 1 PLC ± 0.20 2 PLC ± 0.10 3 PLC ± 0.05 4 PLC ± 0.05 ANGLES ± 3'		PRODUCT SPEC 108-161908	0.5 BTB Receptacle H3.25	
MATERIAL SEE NOTE		APPLICATION SPEC 114-161404	SIZE A2	CAGE CODE 00779
		WEIGHT 0	DRAWING NO 2499542	RESTRICTED TO -
		CUSTOMER DRAWING	SCALE 1:1	SHEET 10 OF 10
			REV A	