

Datasheet

Stock No: 136-5282, 136-5283, 136-5284

# RS Pro 4 Pole Stainless Steel Switch Disconnecter



| DATA  |         | Range      | Units | 136-5282<br>25A | 136-5283<br>32A | 136-5284<br>63A | DATA                                | Range               | Units   | 136-5282<br>25A | 136-5283<br>32A | 136-5284<br>63A |      |     |     |     |    |
|---|---------|------------|-------|-----------------|-----------------|-----------------|-------------------------------------|---------------------|---------|-----------------|-----------------|-----------------|------|-----|-----|-----|----|
| <b>Rated operational voltage Ue</b>             |         |            |       |                 |                 |                 | <b>UL Power Rating</b>              |                     |         |                 |                 |                 |      |     |     |     |    |
| IEC & EN  |         | Volts      | V     | 690             | 690             | 690             | DOL                                 | 3 Phase             | 120V    | hp              | 3               | 3               | 7.5  |     |     |     |    |
| UL  |         | Volts      | V     | 600             | 600             | 600             |                                     |                     | 240V    | hp              | 7.5             | 7.5             | 15   |     |     |     |    |
| Main switch: Isolating voltage up to            |         | Volts      | V     | 750             | 750             | 750             |                                     |                     | 480V    | hp              | 15              | 20              | 25   |     |     |     |    |
| Rated impulse withstand voltage Uimp            |         | Volts      | kV    | 6               | 6               | 6               |                                     |                     | 600V    | hp              | 20              | 25              | 30   |     |     |     |    |
| Rated uninterrupted current Iu                  |         | Amps       | A     | 25              | 32              | 63              |                                     |                     | 1 Phase | 120V            | hp              | 1.5             | 2    | 3   |     |     |    |
| <b>Rated operational current Ie</b>             |         |            |       |                 |                 |                 | 240V                                |                     |         |                 |                 |                 | hp   | 2   | 3   | 7.5 |    |
| IEC & EN  | AC-22A  | Up to 690V | A     | 25              | 32              | 63              | <b>UL Short Circuit Ratings</b>     |                     |         |                 |                 |                 |      |     |     |     |    |
|   | AC-21A  | Up to 690V | A     | 32              | 40              | 80              | Fuse rating, class J                | Amps                | A       | 45              | 45              | 70              |      |     |     |     |    |
|   | AC-1    | Up to 690V | A     | 32              | 40              | 80              | Fuse rating, class RK5              | Amps                | A       | -               | -               | -               |      |     |     |     |    |
| <b>Rated operational power AC-23A (50-60Hz)</b> |         |            |       |                 |                 |                 | Rated Fused short circuit current   |                     |         |                 |                 |                 | Amps | kA  | 10  | 10  | 10 |
| IEC & EN  | 3 Phase | 230(240)V  | kW    | 11              | 15              | 30              | <b>Short Circuit Capacity (IEC)</b> |                     |         |                 |                 |                 |      |     |     |     |    |
|   |         | 400(415)V  | kW    | 15              | 18.5            | 37              | Max fuse size (Type gl)             | Amps                | A       | 32              | 32              | 63              |      |     |     |     |    |
|   |         | 690V       | kW    | 22              | 22              | 45              | Rated Fused short circuit current   | Amps                | kA      | 30              | 30              | 30              |      |     |     |     |    |
| <b>Rated operational power AC-3 (50-60Hz)</b>   |         |            |       |                 |                 |                 | <b>Terminal Specification</b>       |                     |         |                 |                 |                 |      |     |     |     |    |
| IEC & EN  | 3 Phase | 230(240)V  | kW    | 7.5             | 11              | 22              | Single/ Multiple strand wire        | Min-mm <sup>2</sup> | 2.5     | 2.5             | 2.5             |                 |      |     |     |     |    |
|   |         | 400(415)V  | kW    | 11              | 11              | 22              |                                     | Max-mm <sup>2</sup> | 10      | 10              | 25              |                 |      |     |     |     |    |
|   |         | 690V       | kW    | 15              | 15              | 30              | Fine strand with sleeve             | Min-mm <sup>2</sup> | 0.75    | 0.75            | 2.5             |                 |      |     |     |     |    |
|   |         |            |       |                 |                 |                 | Max-mm <sup>2</sup>                 |                     |         |                 |                 |                 | 6    | 6   | 10  |     |    |
|   |         |            |       |                 |                 |                 | American wire gauge                 |                     |         |                 |                 |                 | AWG  | 10  | 10  | 6   |    |
|   |         |            |       |                 |                 |                 | Recommended Tightening Torque       |                     |         |                 |                 |                 | Nm   | 1.7 | 1.7 | 2.0 |    |

Dimensions

25A / 32A

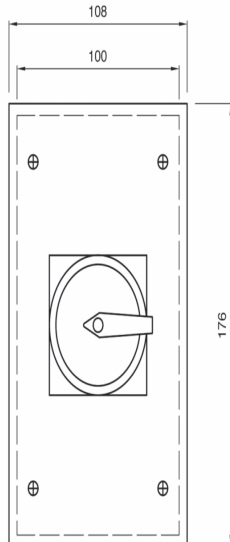
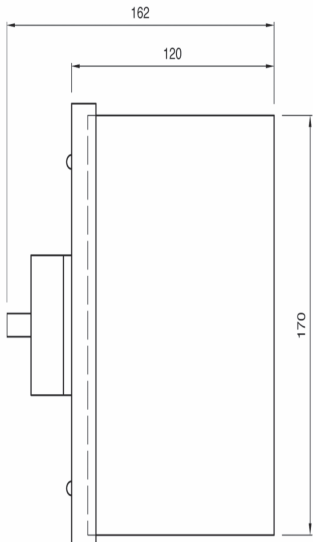

63A

