



Image may differ from product. See technical specification for details.

305702 C-2Z

Cam roller (yoke-type track roller) with flat outside surface, integral sealing and relubrication feature

These cam rollers (yoke-type track rollers) are designed to run on all types of tracks and to be used in cam drives, conveyor systems, etc. They are based on double row angular contact ball bearings. They have a thick-walled outer ring with a flat running surface and are supplied greased, sealed and ready-to-mount. A lubrication hole in the inner ring facilitates relubrication.

- High radial load carrying capacity and relatively high speed capability
- Accommodate tilting moments
- Long service life
- Ready to mount
- Integral sealing, for increased reliability, with relubrication feature

Overview

Dimensions

Functional outside diameter	40 mm
Bore diameter	15 mm
Width	15.9 mm

Performance

Basic dynamic load rating	10.8 kN
Basic static load rating	5.7 kN
Limiting speed	13 000 r/min

Properties

Bearing part	Complete track roller
Rolling elements	Balls
Number of rows	2
Outer ring profile	Cylindrical
Axial guidance of outer ring	Yes
Number of flanges, outer ring	0
Cage	With
Axial internal clearance	Normal
Tolerance class	Normal
Material, bearing	Bearing steel
Coating	Without
Sealing	Shield on both sides
Sealing type	Non-contact
Lubricant	Grease
Relubrication feature	With

Logistics

Product net weight	0.103 kg
eClass code	23-05-08-03
UNSPSC code	31171531

Technical specification

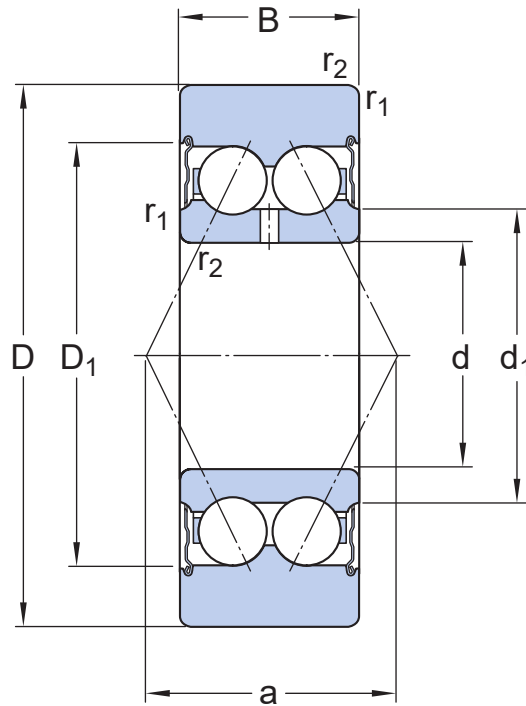

Dimensions

D	40 mm	Outside diameter
d	15 mm	Bore diameter
B	15.9 mm	Width
d ₁	≈ 20.2 mm	Shoulder/recess diameter inner ring
D ₁	≈ 30.7 mm	Recess diameter outer ring
r _{1,2}	min. 0.6 mm	Chamfer dimension
a	21 mm	Distance pressure points

Calculation data

Basic dynamic load rating	C	10.8 kN
Basic static load rating	C ₀	5.7 kN
Fatigue load limit	P _u	0.24 kN
Maximum dynamic radial load	F _r	max. 5.85 kN
Maximum static radial load	F _{0r}	max. 8.5 kN
Limiting speed		13 000 r/min

Tolerances and clearances

GENERAL CAM ROLLER SPECIFICATIONS

- Tolerances: Normal
- Internal clearance: Single row cam rollers, Double row cam rollers

CAM ROLLER INTERFACES

- [Seat tolerances for standard conditions](#)
- [Tolerances and resultant fit](#)



Terms of use