

## Datasheet

### A2 200 Hex Head Series Cable Gland

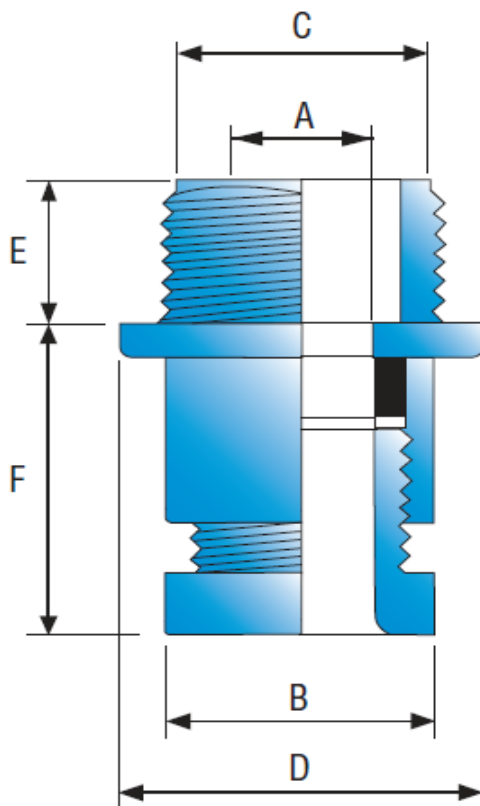

<b>TECHNICAL DATA</b>	
<b>Type</b>	A2 200 Hex Head
<b>Design Specification</b>	EN 50262:1999
<b>Ingress Protection Rating</b>	IP55
<b>Material</b>	Low Smoke & Fume (LSF) Polymeric Material
<b>Continuous Operating Temperature Range</b>	-20°C to +80°C, Intermittent up to 120°C
<b>Available Colours</b>	Black, White, Bright Red to Ral 3020, Light Grey to Ral 7035 and Mid Grey to Ral 7001
<b>Standard Cable Gland Flammability Rating</b>	UL 94 V2
<b>Alternative Cable Gland Flammability Rating</b>	UL 94 V0 (Red Colour Only)
<b>Cable Type</b>	Unarmoured
<b>Sealing Area</b>	Cable Outer Sheath
<b>Accessories</b>	Locknut & Sealing Washer (included)

**Cable Gland Selection Table**

Standard Cable Gland Range								
Ordering Reference	Body Size	Thread Diameter 'C'	Min Thread Length 'E'	Overall Cable Diameter 'A'		Protrusion Length 'F'	Across Flats 'B'	Envelope Diameter 'D'
				Min	Max		Max	
A2 - 248 - X	16	M16	11.0	4.0	7.0	24.0	19.0	22.5
A2 - 250 - X	16	M16	11.0	7.0	10.5	24.0	19.0	22.5
A2 - 249 - X	16	M20	11.0	4.0	7.0	27.0	19.0	25.4
A2 - 251 - X	16	M20	11.0	7.0	10.5	27.0	19.0	25.4
A2 - 252 - X	20	M20	11.0	8.0	13.0	31.0	22.5	26.8
A2 - 264 - X	20	M25	11.0	4.0	7.0	31.0	23.0	32.5
A2 - 265 - X	20	M25	11.0	7.0	10.5	31.0	23.0	32.5
A2 - 253 - X	20	M25	11.0	8.0	13.0	31.0	23.0	32.5
A2 - 254 - X	25	M25	11.0	13.0	18.0	32.5	28.0	32.5
A2 - 255 - X	32	M32	13.0	18.0	24.5	38.0	36.0	42.0

All dimensions in millimetres