



ATHD Series™



Single-Pole Power Connectors

Our **ATHD Series™** of Single-Pole Power Connectors provide an environmentally sealed IP67/69K connection system and viable solution to field splices and terminals in harsh environments. Safety features include an integral latch to prevent inadvertent disconnect and an audible click, tactile feel provide circuit confirmation. Precision machined contact technology maximizes performance and durability while delivering 100A of power. The rugged circular housings can be used as an in-line or easy to install sealed flange mount connection system for heavy-duty applications.



Applications: Heavy Duty, Transportation, Marine, Diagnostic, Military, Alternative Energy and Agricultural

Key Features

- Intermatable with industry standard connectors
- Single-Pole Arrangement
- Machined Contact Size #4 (Wire Size 6AWG)
- Circular, Thermoplastic Housing
- In-line (Wire-to-Wire) or Flange Mount Capability
- Integral Latch Prevents Inadvertent Disconnect

Available Modifications

- Customized project-specific colors
- **-L009** Sealed Flange Receptacle for inside mounting
- **-L013** Sealed Flange Receptacle for outside mounting



-L009



-L013

Current Rating	100A
Voltage Rating	1000V AC/DC
Operating Temperature	-55°C to +125°C
Dielectric Withstand Voltage	Less than 2 Milliamps Current Leakage @ 3000V AC
Insulation Resistance	1000 Megohms Minimum @ 25°C
Mating Cycle Durability	100 Cycles
Insulation O.D.	7.1mm Min, 7.4mm Max
Wire Size	6AWG (13.0mm ²)









A Series™ Family



Standard products. Custom solutions
Customer Service +1 800 394 7732

ATHD Series™ Single-Pole Power Connectors

Image	Part Number	Description	Contact Size	Amp/Volt
	ATHD06-1-4S	1 Pin, Plug (IP69K mated), Black	4	100A/1000V
	ATHD04-1-4P	1 Pin, Receptacle (IP69K mated), Black	4	100A/1000V
	ATHD04-1-4P-L009	1 Pin, Receptacle, Flange Mount, Black *Flange sealing limited to IP67	4	100A/1000V
	ATHD04-1-4P-L013	1 Pin, Receptacle, Flush Flange Mount, Black *Flange sealing limited to IP67	4	100A/1000V
	AT60-204-0490	Pin, Solid, Size 4, 6AWG, Nickel	4	100A
	AT62-203-04141	Socket, Solid, Size 4, 6AWG, Nickel	4	100A

ATHD06-1-4S Plug Dimensions

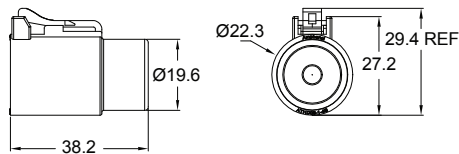

ATHD04-1-4P Receptacle Dimensions

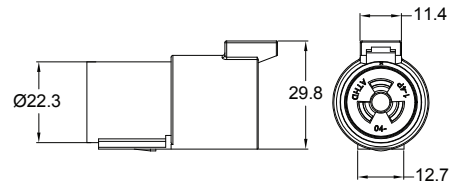

ATHD04-1-4P-L013 Receptacle Dimensions

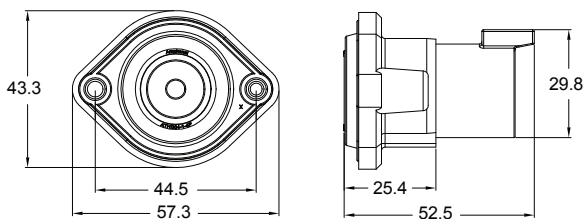

Panel Cutout Dimensions

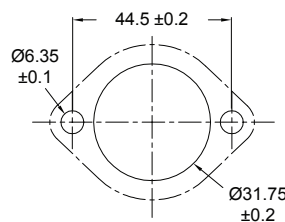

ATHD04-1-4P-L009 Receptacle Dimensions

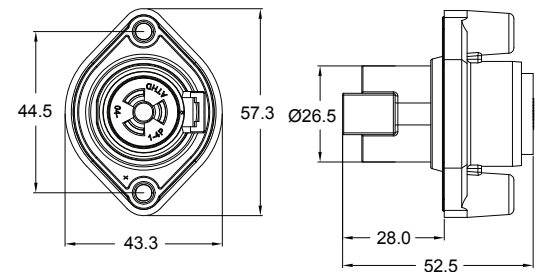

For more information, contact: Customer Service, +1 800 394 7732, csr@amphenol-sine.com