

THIS DRAWING IS UNPUBLISHED. RELEASED FOR PUBLICATION
 © COPYRIGHT BY TYCO ELECTRONICS CORPORATION. ALL RIGHTS RESERVED.

LOC		DIST		REVISIONS			
P	LTR	DESCRIPTION	DATE	DWN	APVD		
FT	0	L	REVISED PER 0G3B-0168-05	3/10/05	SS	GS	

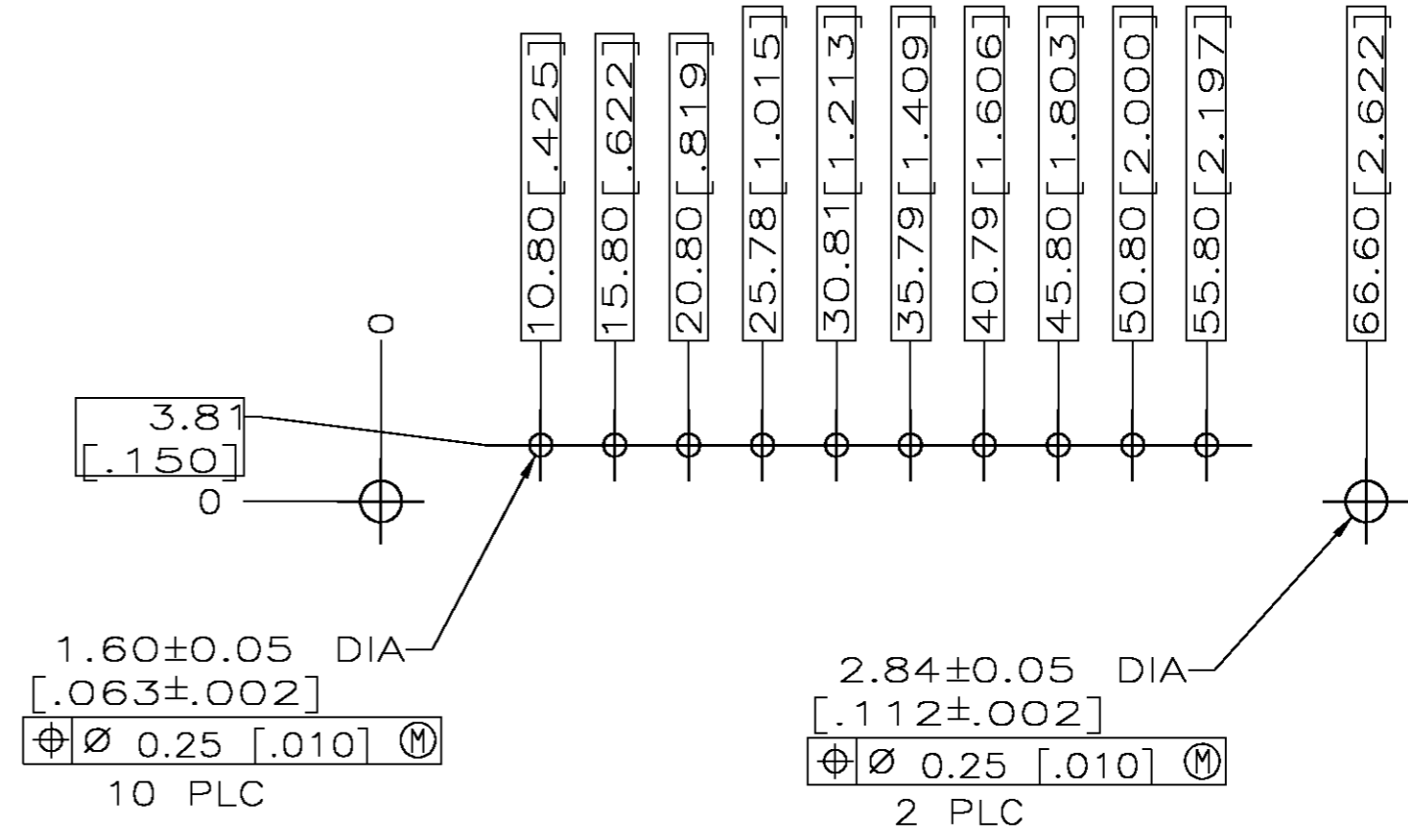

RECOMMENDED PC BOARD LAYOUT

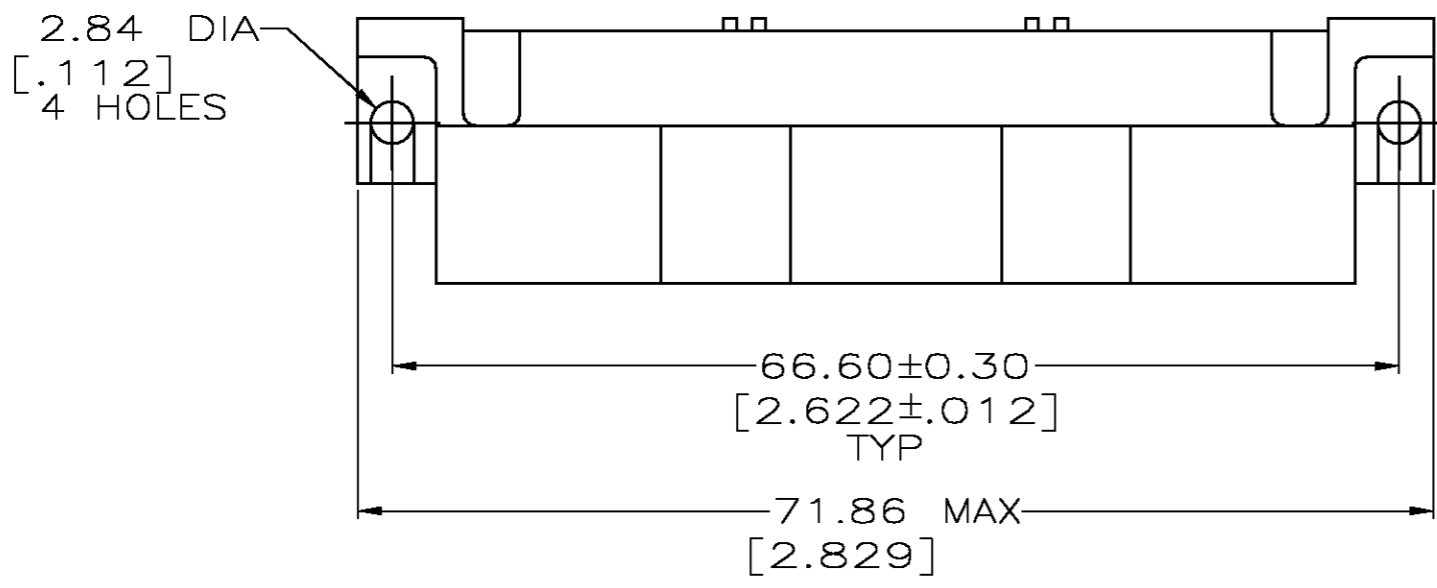
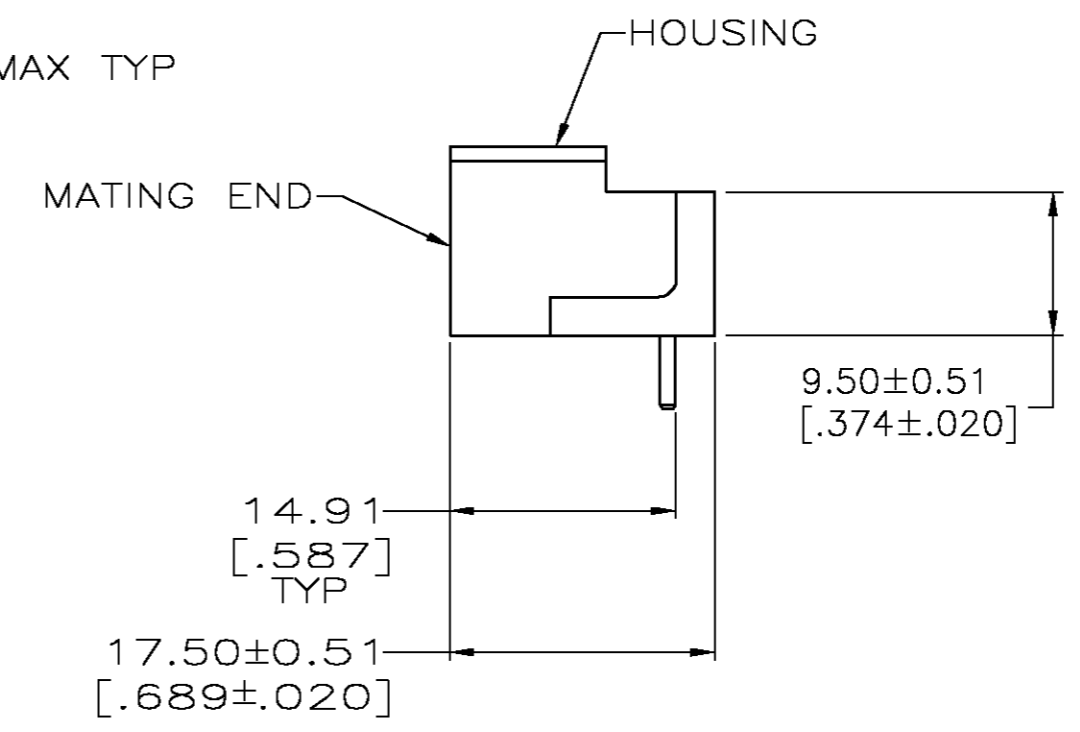
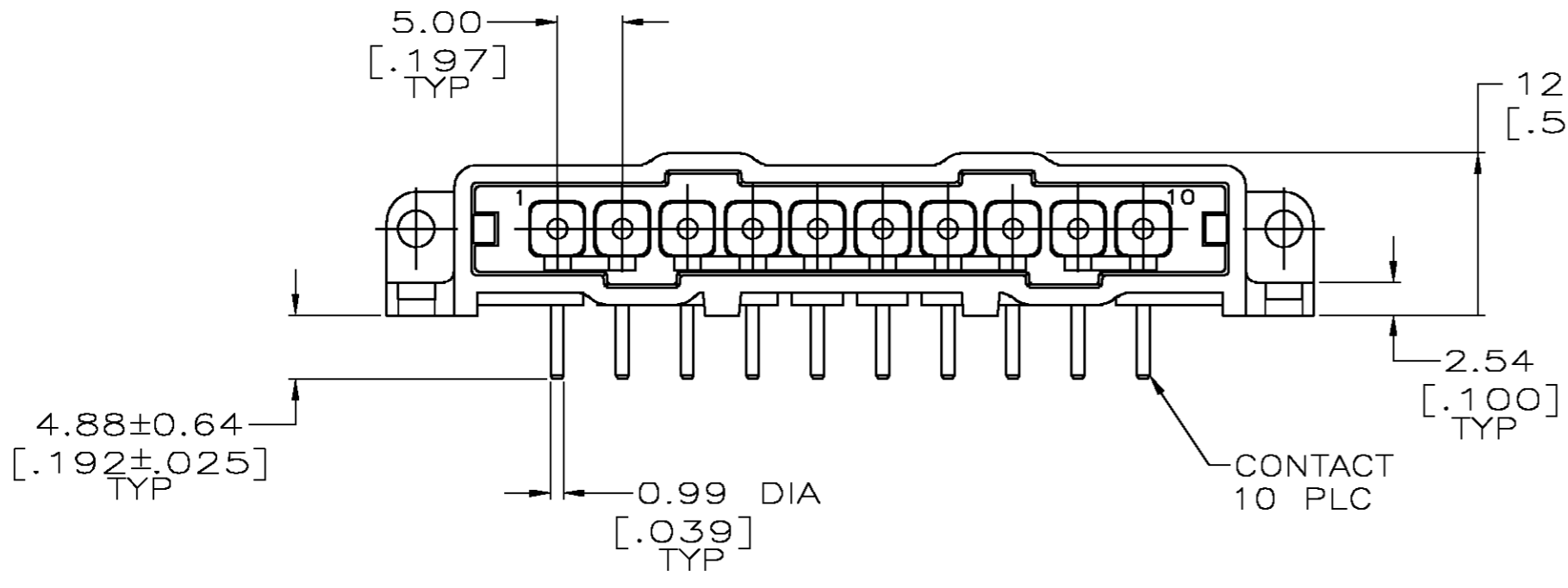

- ① NYLON, RED.
- ② BRASS PER ASTM B36.
- ③ 3.81um [0.000150] MIN TIN-LEAD OVER 2.54um [0.000100] MIN COPPER OR 1.27um [0.000050] MIN NICKEL.
- ④ 0.76um [0.000030] MIN GOLD FOR A LENGTH OF 5.08 [0.200] MIN FROM MATING END, 3.81um [0.000150] MIN TIN-LEAD FOR A LENGTH OF 5.36 [0.211] MIN FROM OPPOSITE END, BOTH OVER 1.27um [0.000050] MIN NICKEL.
- ⑤ .000150 MIN LEAD FREE TIN OVER .000100 MIN COPPER, OR .000050 MIN NICKEL.
- ⑥ 0.76um [0.000030] MIN GOLD FOR A LENGTH OF 5.08 [0.200] MIN FROM MATING END, 3.81um [0.000150] MIN TIN FOR A LENGTH OF 5.36 [0.211] MIN FROM OPPOSITE END, BOTH OVER 1.27um [0.000050] MIN NICKEL.

FINISH	PART NO
⑥	207398-7
⑤	207398-6
④	207398-3
③	207398-1

THIS DRAWING IS A CONTROLLED DOCUMENT.		DWN L.SIPE 07/07/92	Tyco Electronics Corporation	
DIMENSIONS: mm [INCHES]		CHK R.STONE 7-24-92	Harrisburg, Pa 17105-3608	
TOLERANCES UNLESS OTHERWISE SPECIFIED:		APVD A.TRAVIS 7-24-92	NAME	
0 PLC ± -		PRODUCT SPEC	PIN HEADER ASSEMBLY, 10 POSN, IN-LINE, RIGHT ANGLE, SMALL METRIC CONNECTOR, METRIMATE	
1 PLC ± -		APPLICATION SPEC	SIZE CAGE CODE DRAWING NO RESTRICTED TO	
2 PLC ± 0.25 [0.010]			A2 00779 C=207398	
3 PLC ± -			SCALE 2:1 SHEET 1 OF 1 REV L	
4 PLC ± -				
ANGLES ± -				
MATERIAL HOUSING: ①	CONTACTS: ②	WEIGHT -	CUSTOMER DRAWING	
FINISH CONTACTS: SEE TABLE				