



ENGLISH

Datasheet

RS Pro Damper 350daN

Stock No: 811-2410



RS Stop Buffer - Male

Operation and Assembly

The elastic buffers can be used in these two possibilities:

As buffers:

The impact takes place as an end of stroke, taking into account the maximum deflection the stop may give.

As Elastic Mounts:

When installed as elastic mounts, the buffers may be screwed to the base of the machine so that its flat surface rests directly on the floor or ground.

RS, Professionally Approved Products, gives you professional quality parts across all products categories. Our range has been testified by engineers as giving comparable quality to that of the leading brands without paying a premium price.



Technical data

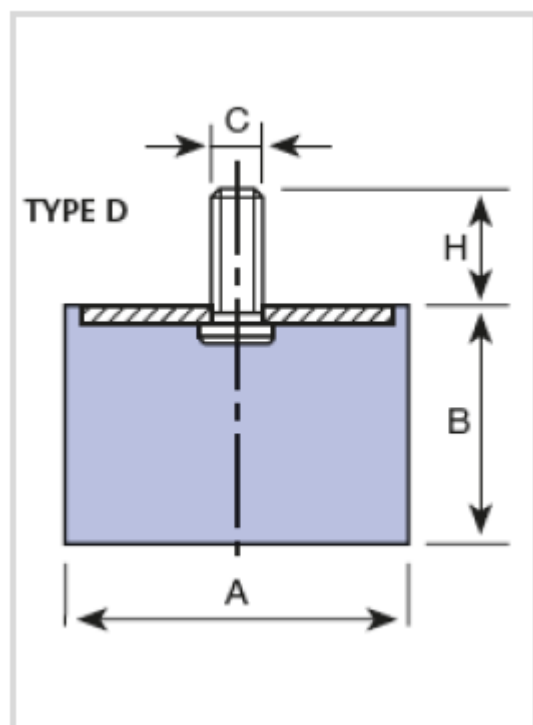

| RS Ref: | A | B | C | H | COMPRESSION | |
|---------|------|----|------|------|------------------|----------------|
| | | | | | LOAD max. daN | DEFLECT. mm |
| 8112312 | 12,5 | 10 | M-5 | 10 | 12 | 2 |
| 8112316 | 16 | 10 | M-5 | 12 | 20 | 1,5 |
| 8112331 | 20 | 15 | M-6 | 16,5 | 35 | 4 |
| 8112338 | 20 | 25 | M-6 | 16,5 | 30 | 5,5 |
| 8112369 | 25,5 | 15 | M-8 | 20 | 60 | 3,5 |
| 8112362 | 25,5 | 19 | M-8 | 20 | 55 | 4,5 |
| 8112372 | 30 | 15 | M-8 | 20 | 90 | 3 |
| 8112381 | 30 | 22 | M-8 | 20 | 80 | 5 |
| 8112404 | 30 | 30 | M-8 | 20 | 70 | 8 |
| 8112407 | 40 | 20 | M-10 | 25 | 160 | 5 |
| 8112527 | 40 | 25 | M-10 | 25 | 150 | 6 |
| 8112394 | 60 | 36 | M-10 | 25 | 300 | 9 |
| 8112410 | 70 | 50 | M-10 | 25 | 350 | 11 |