

SOLID-STATE TWO-WIRE TIME RELAY SETTING RANGE
 0.5 S...10 S,
 AC/DC 90...240 V, OFF-DELAY,
 W. VARISTOR FOR MOUNTING ONTO CONTACTORS
 SIZES00



| General technical data: | | |
|--|----|------------------------------------|
| product brand name | | SIRIUS |
| product designation | | timing relay |
| Design of the product | | off-delayed with auxiliary voltage |
| type of voltage | | AC |
| Size of the contactor / can be combined / company-specific | | S00 |
| Product function | | |
| <ul style="list-style-type: none"> star-delta circuit | | No |
| <ul style="list-style-type: none"> at the relay outputs / changeover delayed/without delay | | No |
| Product component / semi-conductor output | | Yes |
| Product extension / optional / remote control | | No |
| Product extension / strictly required / remote control | | No |
| Adjustable time | s | 0.5 ... 10 |
| Ambient temperature | | |
| <ul style="list-style-type: none"> during operating | °C | -25 ... +60 |
| Item designation | | |
| <ul style="list-style-type: none"> according to DIN 40719 extendable after IEC 204-2 / according to IEC 750 | | K |
| <ul style="list-style-type: none"> according to DIN EN 61346-2 | | K |

Switching Function:

| | | |
|---|--|-----|
| Switching function | | |
| • slow-operating | | No |
| • making pulse contact | | No |
| • firmly clocked beginning with pulse | | No |
| • firmly clocked beginning with pause | | No |
| • relapse delayed | | Yes |
| • variably clocked start with impulse | | No |
| • impuls variably clocked start with pause | | No |
| • with auxiliary voltage | | |
| • in an additive way slow-operating | | No |
| • temporary line fault | | No |
| • relapse delayed | | Yes |
| • without auxiliary voltage / relapse delayed | | No |

Auxiliary circuit:

| | | |
|---|----|------------|
| Supply voltage frequency / for auxiliary and control current circuit | | |
| • rated value | Hz | 50 ... 60 |
| Supply voltage / strictly required / auxiliary voltage | | Yes |
| Control supply voltage | | |
| • at 50 Hz / at AC | | |
| • rated value | V | 90 ... 240 |
| • at 60 Hz / at AC | | |
| • rated value | V | 90 ... 240 |

Installation/mounting/dimensions:

| | | |
|---------------|----|----|
| Width | mm | 45 |
| Height | mm | 38 |
| Depth | mm | 38 |

Connections:

| | | |
|---|--|----------------------|
| Design of the electrical connection | | |
| • jumper socket | | No |
| • for auxiliary and control current circuit | | screw-type terminals |

Certificates/approvals:

General Product Approval

**Functional Safety /
Safety of
Machinery**

Test Certificates



[ROSTEST](#)



[SUVA](#)

[Manufacturer](#)

Shipping Approval



Shipping Approval

other



[Manufacturer](#)

[other](#)

Further information:

Information- and Downloadcenter (Catalogs, Brochures,...)

<http://www.siemens.com/industrial-controls/catalogs>

Industry Mall (Online ordering system)

<http://www.siemens.com/industrial-controls/mall>

CAX-Online-Generator

<http://www.siemens.com/cax>

Service&Support (Manuals, Certificates, Characteristics, FAQs,...)

<http://support.automation.siemens.com/WW/view/en/3RT1916-2DH21/all>

Image database (product images, 2D dimension drawings, 3D models, device circuit diagrams, ...)

http://www.automation.siemens.com/bilddb/cax_en.aspx?mlfb=3RT1916-2DH21

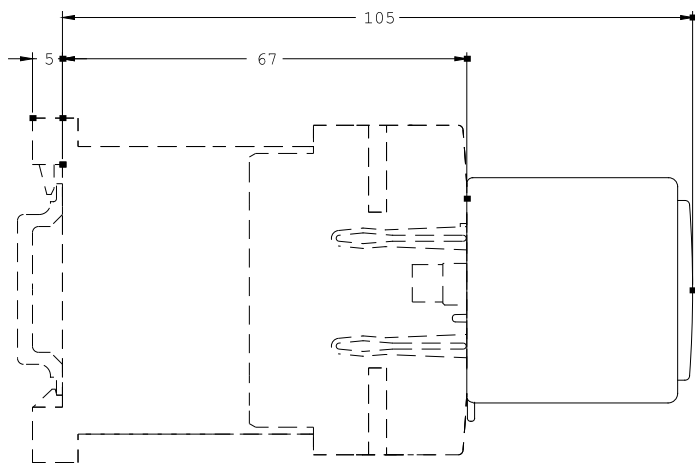
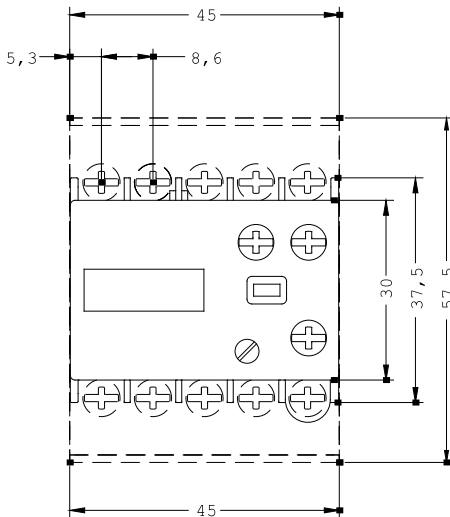

last change:

Jan 30, 2012