

PC card drilling dimensions (after plating)
(thickness 1.60±0.20mm)

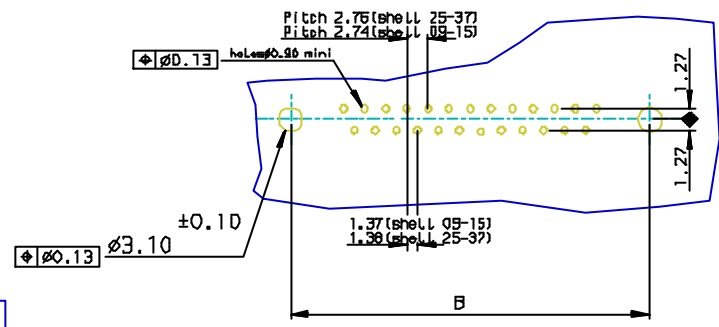

PART NUMBER									
SHELL	A±0.38	B±0.12	C±0.10	D±0.25	Plating: 0.76µ AU	Plating: Flash AU			
09	30.81	24.99	16.96	16.21	D09S13B6G*00**	D09S13B4G*00**			
15	39.14	33.32	25.18	24.54	D15S13B6G*00**	D15S13B4G*00**			
25	53.03	47.04	39.12	38.25	D25S13B6G*00**	D25S13B4G*00**			
37	69.32	63.50	55.68	54.71	D37S13B6G*00**	D37S13B4G*00**			

REQUIREMENTS

Technical characteristics
 Shell: steel tin/Zinc Cr3 plated
 Insulators: self-extinguishing black polyester, UL Class 94V0
 Contacts size 20: brass, gold 0.76µ on mating end, bright tin on termination end and over nickel on entire contact
 Cycles: 200 for plating 4
 500 for plating 6
 Harpoons: phosphor bronze, tin plated
 Metal plate for electrical continuity: brass, tin/Zinc Cr3 plated
 Nuts: brass, tin/Zinc Cr3 plated

Electrical characteristics
 max. current rating: 5A
 Test voltage: 1000V
 Rated voltage: 300V
 Contact resistance: <15mΩ
 Shell resistance: <5mΩ
 Insulation resistance: >5000MΩ

Climatic characteristics
 Operating temperature range: -55°C +125°C

Dimensions
 In accordance with MIL-C-24308

Threaded ØT M3 = L
 Threaded ØT 4.40 = X
 LF FOR LEAD FREE

FOR ROHS DETAILS REFER DWG. NO: C01-8646-0000

REV	ECN NO	DR	DATE
D	105-0124	JS	2005/07/27
E	105-0074	SK	2005/05/08
-	-	-	-
-	-	-	-
-	-	-	-
-	-	-	-

www.fciconnect.com			surface	tolerance std	projection	mm	
			ISO 1302 ✓	ISO 406 ISO 1101		← →	
			TOLERANCES UNLESS OTHERWISE SPECIFIED				
Dr	JOHN SLEEBA	1994/08/01	ANGULAR	0.X	±D.1	size	Scale
Eng	GEORGE VJ	1994/08/01	L LINEAR	0.XX	±D.1	A3	1:1
Chr	GEORGE VJ	2005/07/27	0.XX ±1*	0.XXX	±D.1	ECN	-
Appr	KVSD	2005/07/27	Product family		D-SUB	Spec ref	-
FCI			SOCKET CONNECT. DELTA D RIGHT ANGLED			dwg no	Rev.
			WITH NUT, HARPOON & METAL PLATE			C01-8646-0295	E
			catalog no	DELTA-D	CUSTOMER	sheet 1 of 1	