

1 to 1 M.2 NVMe Drive Duplicator Dock

Product ID
M2-HDD-DUPPLICATOR-N1

Top

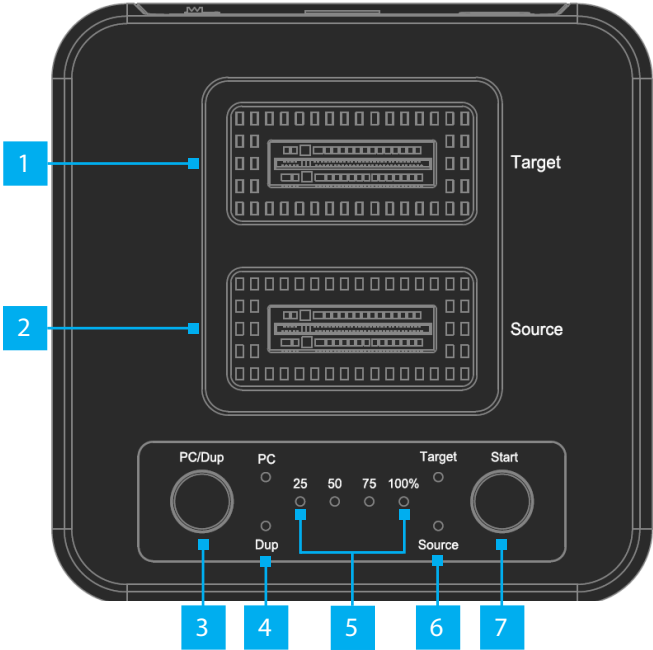

Rear

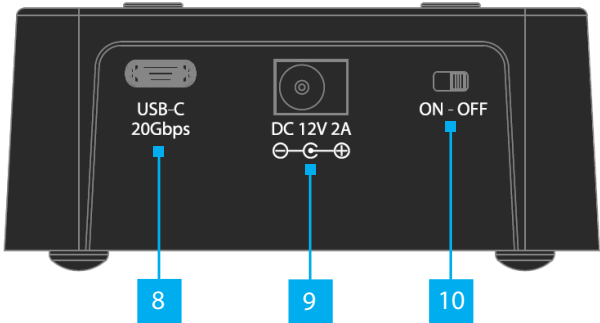

Component		Function
1	Target Drive Bay	• Insert the Target M.2 NVMe Drive to Copy to
2	Source Drive Bay	• Insert the Source M.2 NVMe Drive to Copy from
3	Mode Selector Switch	• Press and Hold to change between PC or Duplicator Mode
4	Mode LED Indicators	• Solid Green: PC Mode • Solid Blue: Duplicator Mode
5	Progress LED Indicators	• Indicates progress from 25% to 100% during the Duplication process
6	Drive LEDs	• Solid Blue: Indicates the M.2 Drive is detected • Flashing Red: There is an error reading the M.2 Drive or the M.2 Drive was removed during duplication • Solid Purple: Indicates the Target M.2 Drive is too small to duplicate to
7	Start Button	• Starts the Drive Duplication process • See Operation section for more information
8	USB-C Host Connection	• Connect the Drive Duplicator Dock to an available USB-C Port on a Host Computer • Only required for PC Mode
9	DC Power Input	• Connect the included Universal Power Adapter
10	Power Switch	• Turn the M.2 Drive Duplicator Dock On or Off

Requirements

For the latest product information, technical specifications, and declarations of conformance, please visit: www.StarTech.com/M2-HDD-DUPPLICATOR-N1

Package Contents

- M.2 Drive Duplicator Dock x 1
- 3.3ft (1m) USB-C to USB-C Cable x 1
- 3.3ft (1m) USB-A to USB-C Cable x 1
- Universal Power Adapter (NA/EU/UK/ANZ) x 1
- Quick-Start Guide x 1

Installation

Power the Drive Duplicator Dock

1. Connect the **Universal Power Adapter** to the appropriate **Regional Power Tip**.
2. Connect the **Universal Power Adapter** to the **DC Power Input**, located on the rear of the **M.2 Drive Duplicator Dock**.
3. Toggle the **Power Switch** , located on the rear of the **M.2 Drive Duplicator Dock**, to the **ON** position.

Note: The M.2 Drive Duplicator Dock should be powered off before removing or adding drives to the Target/Source Drive Bays.

Operation

Warning! M.2 Drives can become hot during duplication or prolonged data transfer sessions. Avoid touching the M.2 Drives immediately after use to prevent burns or damage. Allow the drives to cool down before removing/handling.

Connect to a Computer

1. Insert a **M.2 NVMe Drive** into the **Source** and/or **Target Drive Bay**.
2. Press the **Mode Selector Button** until the **PC Mode LED** is **Solid Green**.
3. Connect the included **USB-C Cable** from the **USB-C Port**, located on the rear of the **Drive Duplicator Dock**, to an available **USB-C Port** on the **Host Computer**.
4. The **Host Computer** will automatically detect and install the required **Drivers**.

Regulatory Compliance

FCC - Part 15

This equipment has been tested and found to comply with the limits for a Class B digital device, pursuant to part 15 of the FCC Rules. These limits are designed to provide reasonable protection against harmful interference in a residential installation. This equipment generates, uses and can radiate radio frequency energy and, if not installed and used in accordance with the instructions, may cause harmful interference to radio communications. However, there is no guarantee that interference will not occur in a particular installation. If this equipment does cause harmful interference to radio or television reception, which can be determined by turning the equipment off and on, the user is encouraged to try to correct the interference by one or more of the following measures:

- Connect the equipment into an outlet on a circuit different from that to which the receiver is connected.
- Consult the dealer or an experienced radio/TV technician for help

This device complies with part 15 of the FCC Rules. Operation is subject to the following two conditions:

(1) This device may not cause harmful interference, and (2) this device must accept any interference received, including interference that may cause undesired operation. Changes or modifications not expressly approved by StarTech.com could void the user's authority to operate the equipment.

Industry Canada Statement

This Class B digital apparatus complies with Canadian ICES-003.

Cet appareil numérique de la classe [B] est conforme à la norme NMB-003 du Canada.

CAN ICES-3 (B)/NMB-3(B)

This device complies with Industry Canada licence-exempt RSS standard(s). Operation is subject to the following two conditions:

(1) This device may not cause interference, and (2) This device must accept any interference, including interference that may cause undesired operation of the device.

Le présent appareil est conforme aux CNR d'Industrie Canada applicables aux appareils radio exempts de licence. L'exploitation est autorisée aux deux conditions suivantes:

(1) l'appareil ne doit pas produire de brouillage, et (2) l'utilisateur de l'appareil doit accepter tout brouillage radioélectrique subi, même si le brouillage est susceptible d'en compromettre le fonctionnement.

Copy a Drive

1. Press the **Mode Selector Button** until the **Duplicator Mode LED** is **Solid Blue**.
2. Ensure the **Source** and **Target Drives** are in the correct **Drive Bays**.
3. Press and Hold the **Start Button** until the **Progress LED Indicators** begin to flash. Immediately release and press the **Start Button** once more. The **25% LED** will begin to flash to indicate the duplication process is in progress.

Warning! Do not disconnect either drive or interrupt the process until the duplication process has completed. Doing so may result in damage to the drive or lost data.

Note: As each 25% segment of the duplication process finishes, the corresponding LED will turn solid, while the subsequent LED will begin to flash

4. When **All Progress LED Indicators** are no longer flashing and have become solid, the duplication process is complete.

Warranty Information

This product is backed by a two-year warranty.

For further information on product warranty terms and conditions, please refer to www.startech.com/warranty.

Limitation of Liability

In no event shall the liability of StarTech.com Ltd. and StarTech.com USA LLP (or their officers, directors, employees or agents) for any damages (whether direct or indirect, special, punitive, incidental, consequential, or otherwise), loss of profits, loss of business, or any pecuniary loss, arising out of or related to the use of the product exceed the actual price paid for the product. Some states do not allow the exclusion or limitation of incidental or consequential damages. If such laws apply, the limitations or exclusions contained in this statement may not apply to you.



StarTech.com Ltd.
45 Artisans Cres
London, Ontario
N5V 5E9
Canada

StarTech.com LLP
4490 South Hamilton
Road
Groveport, Ohio
43125
U.S.A.

StarTech.com Ltd.
Unit B, Pinnacle 15
Gowerton Rd,
Brackmills
Northampton
NN4 7BW
United Kingdom

StarTech.com Ltd.
Siriusdreef 17-27
2132 WT Hoofddorp
The Netherlands

FR: startech.com/fr
DE: startech.com/de
ES: startech.com/es
NL: startech.com/nl
IT: startech.com/it
JP: startech.com/jp