



D 20 L

SOCKET 1/4" bi-hexagon UD profile, long pattern

- Square drive as per DIN 3120 - C 6.3, ISO 1174, with ball retaining groove
- Hand-operated, knurled grip
- GEDORE vanadium steel 31CrV3, polished, chrome-plated

6.3

1/4"



AF

Code	No.	AF	L	d ₁	d ₂	t	↺↻	⊞	£
1965433	D 20 L 3/16AF	3/16	50	7.8	12.0	3.7	17	1	
1965476	D 20 L 7/32AF	7/32	50	8.8	12.0	4.5	19	1	
1965417	D 20 L 1/4AF	1/4	50	9.8	12.0	5.2	17	1	
1965484	D 20 L 9/32AF	9/32	50	11.0	12.0	6.0	43	1	
1965441	D 20 L 5/16AF	5/16	50	12.0	12.0	7.5	24	1	
1965492	D 20 L 11/32AF	11/32	50	13.0	13.0	7.5	43	1	
1965425	D 20 L 3/8AF	3/8	50	14.0	14.0	9.0	35	1	
1965468	D 20 L 7/16AF	7/16	50	16.0	16.0	10.5	43	1	
1965409	D 20 L 1/2AF	1/2	50	18.0	18.0	12.0	54	1	

ITX 20 IP

SCREWDRIVER BIT SOCKET 1/4" for recessed TORX PLUS® head screws

- Square drive as per DIN 3120 - C 6.3, ISO 1174, with ball retaining groove
- Hand-operated, knurled grip
- Chrome-plated
- With pressed-in pin in GEDORE vanadium special steel, gun-metal finish
- TORX PLUS® = reg. trademark of Acument Intellectual Properties, LLC. USA

6.3

1/4"

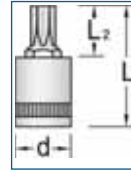

Code	No.	✳	□ mm	✳ mm	L ₁	L ₂	d	↺↻	⊞	£
1815431	ITX 20 6IP	6IP	M2	2.31	30.5	14.5	12	13	1	
1815458	ITX 20 8IP	8IP	M2,5 - M3	2.50	30.5	14.5	12	13	1	
1815466	ITX 20 10IP	10IP	M3 - M3,5	2.74	30.5	14.5	12	13	1	
1815474	ITX 20 15IP	15IP	M3,5 - M4	3.27	30.5	14.5	12	13	1	
1815482	ITX 20 20IP	20IP	M4 - M5	3.86	30.5	14.5	12	14	1	
1815490	ITX 20 25IP	25IP	M4,5 - M5	4.43	30.5	14.5	12	14	1	
1827898	ITX 20 27IP	27IP	M5 - M6	4.99	30.5	14.5	12	14	1	
1815504	ITX 20 30IP	30IP	M6	5.52	30.5	14.5	12	15	1	
1815512	ITX 20 40IP	40IP	M7 - M8	6.65	33.5	14.0	14	25	1	

ITX 20 K

SCREWDRIVER BIT SOCKET 1/4" with ball end, for recessed TORX® head screws

- Square drive as per DIN 3120 - C 6.3, ISO 1174, with ball retaining groove
- Hand-operated, knurled grip
- Chrome-plated
- With pressed-in pin in GEDORE vanadium special steel, gun-metal finish
- Swivel angle approx. 15-20°
- Optimum transfer of power, also at places which are difficult of access
- TORX® = reg. trademark of Acument Intellectual Properties, LLC. USA

6.3

1/4"

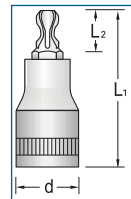

Code	No.	✳	□ mm	✳ mm	L ₁	L ₂	d	↺↻	⊞	£
6120220	ITX 20 K T10	T10	M3 - M3,5	2.74	30.5	14.5	12	15	10	
6120300	ITX 20 K T15	T15	M3,5 - M4	3.27	30.5	14.5	12	15	10	
6120490	ITX 20 K T20	T20	M4 - M5	3.86	30.5	14.5	12	15	10	
6120570	ITX 20 K T25	T25	M4,5 - M5	4.43	30.5	14.5	12	15	10	
6120650	ITX 20 K T27	T27	M4,5 - M6	4.99	30.5	14.5	12	15	10	
6120730	ITX 20 K T30	T30	M6 - M7	5.52	30.5	14.5	12	15	10	
6120810	ITX 20 K T40	T40	M7 - M8	6.65	33.5	14.0	14	25	10	

TX 20

SOCKET 1/4" for protruding TORX® head screws

- Square drive as per DIN 3120 - C 6.3, ISO 1174, with ball retaining groove
- Hand-operated, knurled grip
- GEDORE vanadium steel 31CrV3, polished, chrome-plated
- TORX® = reg. trademark of Acument Intellectual Properties, LLC. USA

6.3

1/4"

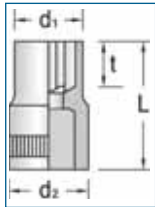

Code	No.	✳	□ mm	✳ mm	L	d ₁	d ₂	t	↺↻	⊞	£
6193880	TX 20 E4	E4	M3	3.86	25	5.5	12	4.5	8	5	
6187640	TX 20 E5	E5	M4	4.73	25	7.0	12	5.0	9	5	
6187720	TX 20 E6	E6	M5	5.74	25	8.0	12	5.0	10	5	
6187800	TX 20 E7	E7	M6	6.16	25	9.5	12	6.0	11	5	
6187990	TX 20 E8	E8	M6 - M7	7.52	25	10.5	12	6.5	14	5	
6193960	TX 20 E10	E10	M8	9.42	25	13.0	13	7.0	18	5	

ITX 20

SCREWDRIVER BIT SOCKET 1/4" for recessed TORX® head screws

- Square drive as per DIN 3120 - C 6.3, ISO 1174, with ball retaining groove
- Hand-operated, knurled grip
- Chrome-plated
- With pressed-in pin in GEDORE vanadium special steel, gun-metal finish
- TORX® = reg. trademark of Acument Intellectual Properties, LLC. USA

Code	No.	✳	□ mm	✳ mm	L ₁	L ₂	d	↺↻	⊞	£
6190430	ITX 20 T8	T8	M2,5	2.31	30.5	14.5	12	13	10	
6190510	ITX 20 T9	T9	M3	2.50	30.5	14.5	12	13	10	
6190780	ITX 20 T10	T10	M3 - M3,5	2.74	30.5	14.5	12	14	10	
6190860	ITX 20 T15	T15	M3,5 - M4	3.27	30.5	14.5	12	14	10	
6190940	ITX 20 T20	T20	M4 - M5	3.86	30.5	14.5	12	14	10	
6191080	ITX 20 T25	T25	M4,5 - M5	4.43	30.5	14.5	12	14	10	
6191160	ITX 20 T27	T27	M4,5 - M6	4.99	30.5	14.5	12	14	10	
6191240	ITX 20 T30	T30	M6 - M7	5.52	30.5	14.5	12	15	10	
6265890	ITX 20 T40	T40	M7 - M8	6.65	33.5	14.0	14	25	10	

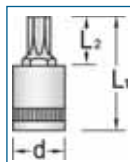

6.3

1/4"



IS 20

SCREWDRIVER BIT SOCKET 1/4" for slotted head screws

- ▶ Square drive as per DIN 3120 - C 6.3, ISO 1174, with ball retaining groove
- ▶ Hand-operated, knurled grip
- ▶ Chrome-plated
- ▶ Bit in GEDORE vanadium special steel, manganese-phosphated
- ▶ Bit as per DIN ISO 2380-1 Form B

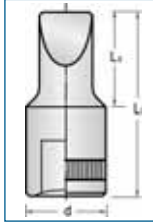

Code	No.	mm±0.1	mm±0.1	L ₁	L ₂	d	±0.05	±0.05	£
6171560	IS 20 4x0,8	0.8	4.0	28	14.5	12	11	10	
6171640	IS 20 5,5x1	1.0	5.5	28	14.5	12	12	10	
6174230	IS 20 6,5x1,2	1.2	6.5	28	14.5	12	12	10	
6174310	IS 20 8x1,6	1.6	8.0	28	14.5	12	12	10	

IN 20

SCREWDRIVER BIT SOCKET 1/4" for in-hex screws

- ▶ Acc. to DIN 7422
- ▶ Square drive as per DIN 3120 - C 6.3, ISO 1174, with ball retaining groove
- ▶ Hand-operated, knurled grip
- ▶ Chrome-plated
- ▶ Bit in GEDORE vanadium special steel, manganese-phosphated
- ▶ * not standardised

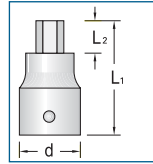

Code	No.	*	mm	L ₁	L ₂	d	±0.05	±0.05	£
1812556	IN 20 2	*	2.0	28	3.0	12	10	10	
1707736	IN 20 2,5	*	2.5	28	3.5	12	10	10	
6176010	IN 20 3		3.0	28	5.5	12	11	10	
6176280	IN 20 4		4.0	28	7.0	12	11	10	
6176360	IN 20 5		5.0	28	8.0	12	12	10	
6178490	IN 20 6		6.0	28	8.5	12	13	10	
6178570	IN 20 8	*	8.0	28	10.0	12	16	10	

IKS 20

SCREWDRIVER BIT SOCKET 1/4" for cross-slotted head screws PH

- ▶ Square drive as per DIN 3120 - C 6.3, ISO 1174, with ball retaining groove
- ▶ Hand-operated, knurled grip
- ▶ Chrome-plated
- ▶ Bit in GEDORE vanadium special steel, manganese-phosphated
- ▶ Tip as per DIN ISO 8764-1 PH

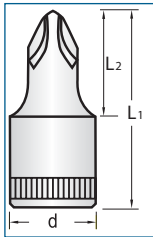

Code	No.	PH	L ₁	L ₂	d	±0.05	±0.05	£
6174580	IKS 20 1	1	28	14.5	12	11	10	
6174660	IKS 20 2	2	28	14.5	12	12	10	
6174740	IKS 20 3	3	28	14.5	12	12	10	
6174820	IKS 20 4	4	28	14.5	12	14	10	

IN 20 L

SCREWDRIVER BIT SOCKET 1/4" for in-hex screws, long pattern

- ▶ Acc. to DIN 7422
- ▶ Square drive as per DIN 3120 - C 6.3, ISO 1174, with ball retaining groove
- ▶ Hand-operated, knurled grip
- ▶ Chrome-plated
- ▶ Bit in GEDORE vanadium special steel, manganese-phosphated

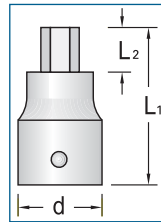

Code	No.	mm	L ₁	L ₂	d	±0.05	±0.05	£
1933256	IN 20 L 3-60	3	60	32	12	24	1	
1933264	IN 20 L 4-60	4	60	32	12	25	1	
1933272	IN 20 L 5-60	5	60	32	12	27	1	
1933280	IN 20 L 6-60	6	60	32	12	29	1	
1933299	IN 20 L 8-60	8	60	32	14	50	1	

IKS 20 PZD

SCREWDRIVER BIT SOCKET 1/4" for cross-slotted head screws PZ

- ▶ Square drive as per DIN 3120 - C 6.3, ISO 1174, with ball retaining groove
- ▶ Hand-operated, knurled grip
- ▶ Chrome-plated
- ▶ Bit in GEDORE vanadium special steel, manganese-phosphated
- ▶ Tip as per DIN ISO 8764-1 PZ

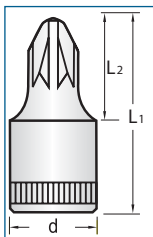

Code	No.	PZ	L ₁	L ₂	d	±0.05	±0.05	£
6187130	IKS 20 PZD 1	1	28	14.5	12	12	10	
6187210	IKS 20 PZD 2	2	28	14.5	12	13	10	
6187480	IKS 20 PZD 3	3	28	14.5	12	14	10	
6187560	IKS 20 PZD 4	4	28	14.5	12	15	10	

IN 20 K

SCREWDRIVER BIT SOCKET 1/4" with ball end, for in-hex screws

- ▶ Square drive as per DIN 3120 - C 6.3, ISO 1174, with ball retaining groove
- ▶ Hand-operated, knurled grip
- ▶ Chrome-plated
- ▶ With pressed-in pin, manganese-phosphated
- ▶ Total swivel angle approx. 15-20°

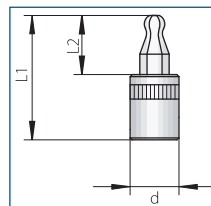

Code	No.	mm	L ₁	L ₂	d	±0.05	±0.05	£
2219409	IN 20 K 4	4	30.5	14.5	12	10	1	
2219417	IN 20 K 5	5	30.5	14.5	12	10	1	
2219468	IN 20 K 6	6	30.5	14.5	12	13	1	