

# Actuator

61-1250.0

Distribution by  
Rs-online<https://rs-online.eao.com/p/61-1250.0>

Your product:

---



## 61-1250.0 Actuator

### FRONT

Front dimension:	24 mm x 24 mm
Front form:	Square
Front bezel colour:	Black
Front bezel material:	Plastic

### MOUNTING

Mounting cut-out:	Ø 16 mm
Mounting type:	Panel mounting

### OPERATING-/INDICATION PART

Lens illumination:	Illuminated
--------------------	-------------

### MECHANICAL CHARACTERISTIC

Switching action:	Maintained
Mechanical lifetime:	According to DIN/IEC 60512-5-6 and EN/IEC 60947-5-1, 1 Mil. cycles of operation
Operating force:	3 N ... 5 N snap-action switching element, 3.5 ... 11 N slow-make switching element
Operating Travel:	3 mm
Tightening torque:	Max. 0.5 Nm
Weight:	0.005 kg

### AMBIENT CONDITION

IP Protection:
----------------

IP40 rear side, according to EN IEC 60529, IP67 front side, according to EN IEC 60529

**Operating temperature:** – 25 °C ... + 55 °C

**Storage temperature:** – 40 °C ... + 85 °C

## CERTIFICATE

**REACH:** REACH compliant

**RoHS:** RoHS compliant

## OTHER

**Short Description:** Actuator, Ø 16 mm, 24 mm x 24 mm, Illuminated, Square, Black, Plastic, Maintained

**Internal size:** 20 mm x 20 mm

**Housing colour:** Black

**Housing material:** Plastic, according to UL 94 V0, self-extinguishing

**Wiring diagrams:**

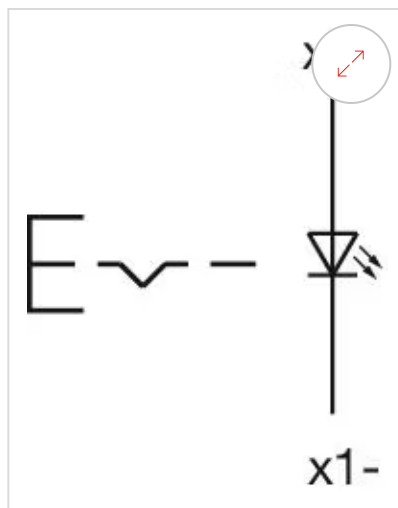

**Mounting cut-outs:**

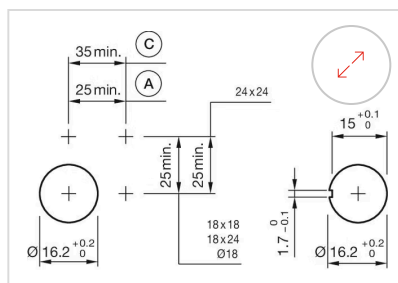

A = Solder/Plug-in terminal 2.8 mm x 0.5 mm

C = Screw terminal

**Dimension drawings:**

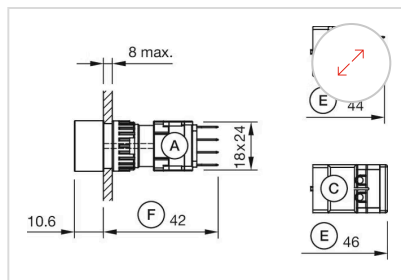

A = Plug-in terminal 2.8 mm x 0.5 mm  
 C = Screw terminal  
 E = Slow-make switching element  
 F = Snap-action switching element