

Drawing of Component

Unit: mm Unless otherwise specified, tolerance: ± 0.5 mm

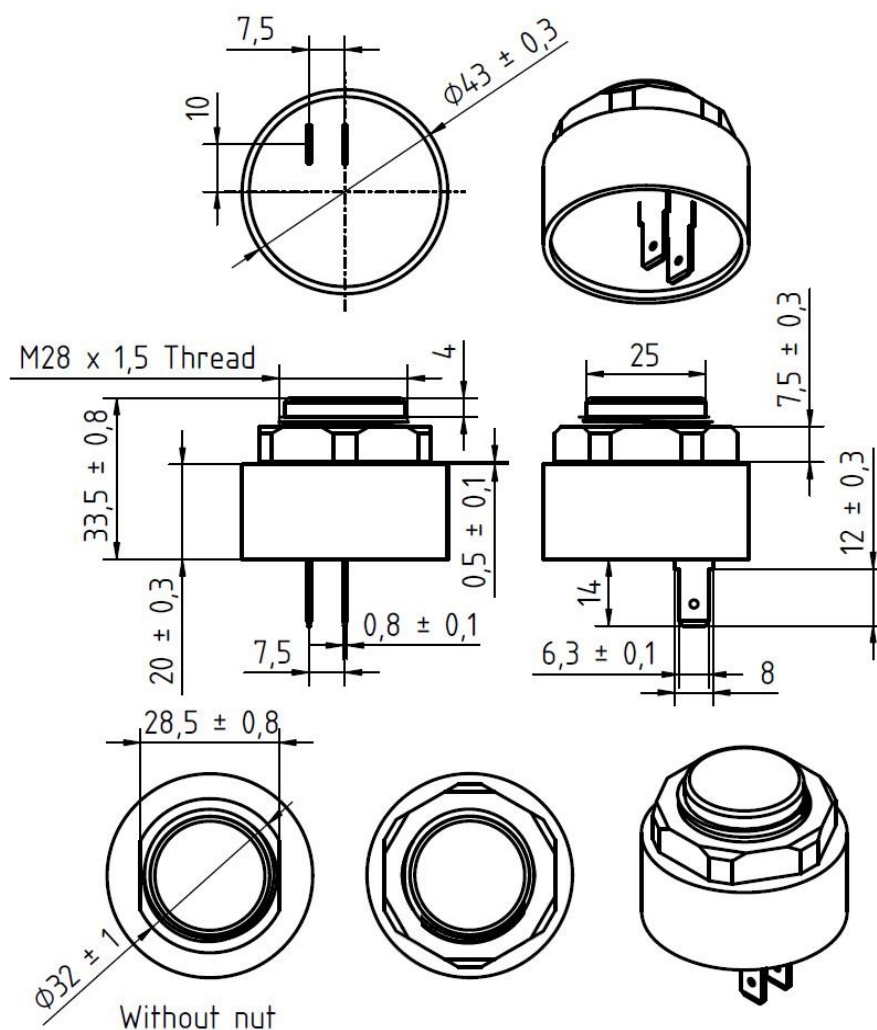

B/C28 BLACK

Dimension
 $\phi 43 \times 33,5$ mm

Operating Voltage
5 - 28 VDC

Tone
Continuous Tone

IP Rating
IP65

Rated Voltage
12 VDC

Sound Pressure Level
85 ± 3 dB(A) at 1 m

Operating Temperature
-20 to +75 °C

Oscillator Frequency
2900 ± 500 Hz