

Connector assembly frame - HC-CIF-B16-BFWD-FH-AL - 1404217

Please be informed that the data shown in this PDF Document is generated from our Online Catalog. Please find the complete data in the user's documentation. Our General Terms of Use for Downloads are valid (<http://phoenixcontact.com/download>)



HEAVYCON plug assembly frame, lower part with double locking latch, for sleeve housing without double locking latch or HC-CIF-..HFFD.. upper part, for type B16 contact inserts, for NS35/7,5 DIN rails

Why buy this product

- Sturdy metal version
- Open base, pre-assembled cable harnesses can be used
- Standardized design; both PE sheets for inserts are connected conductively
- Safe capacitive PE even when connected slightly askew



Key commercial data

| | |
|--------------------------------------|---|
| Packing unit | 1 pc |
| GTIN |  4 046356 681896 |
| Weight per Piece (excluding packing) | 193.59 g |
| Custom tariff number | 85389099 |
| Country of origin | Poland |

Technical data

Dimensions

| | |
|--------|---------|
| Length | 93.5 mm |
| Width | 56 mm |

Ambient conditions

| | |
|---------------------------------|-------------------|
| Ambient temperature (operation) | -40 °C ... 125 °C |
|---------------------------------|-------------------|

General

| | |
|------------------------|--|
| Type | For B16 |
| Material | Cast aluminum, uncoated |
| Locking latch material | High-grade steel, handle: PA-GF |
| Assembly instructions | A double locking latch is not mounted, which means that an assembled cable set can be used more easily |

Connector assembly frame - HC-CIF-B16-BFWD-FH-AL - 1404217

Classifications

eCl@ss

| | |
|------------|----------|
| eCl@ss 4.0 | 27140816 |
| eCl@ss 4.1 | 27140816 |
| eCl@ss 5.0 | 27143424 |
| eCl@ss 5.1 | 27143424 |
| eCl@ss 6.0 | 27143424 |
| eCl@ss 7.0 | 27440209 |

ETIM

| | |
|----------|----------|
| ETIM 3.0 | EC002310 |
| ETIM 4.0 | EC002310 |
| ETIM 5.0 | EC002310 |

UNSPSC

| | |
|---------------|----------|
| UNSPSC 6.01 | 43172601 |
| UNSPSC 7.0901 | 39121416 |
| UNSPSC 11 | 43172601 |
| UNSPSC 12.01 | 39121408 |
| UNSPSC 13.2 | 39121408 |

Approvals

Approvals

Approvals

EAC

Ex Approvals

Approvals submitted

Approval details

| |
|-----|
| EAC |
|-----|

Drawings

Connector assembly frame - HC-CIF-B16-BFWD-FH-AL - 1404217

Dimensioned drawing

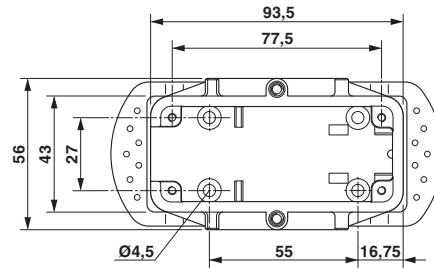

Dimensional drawing top view