

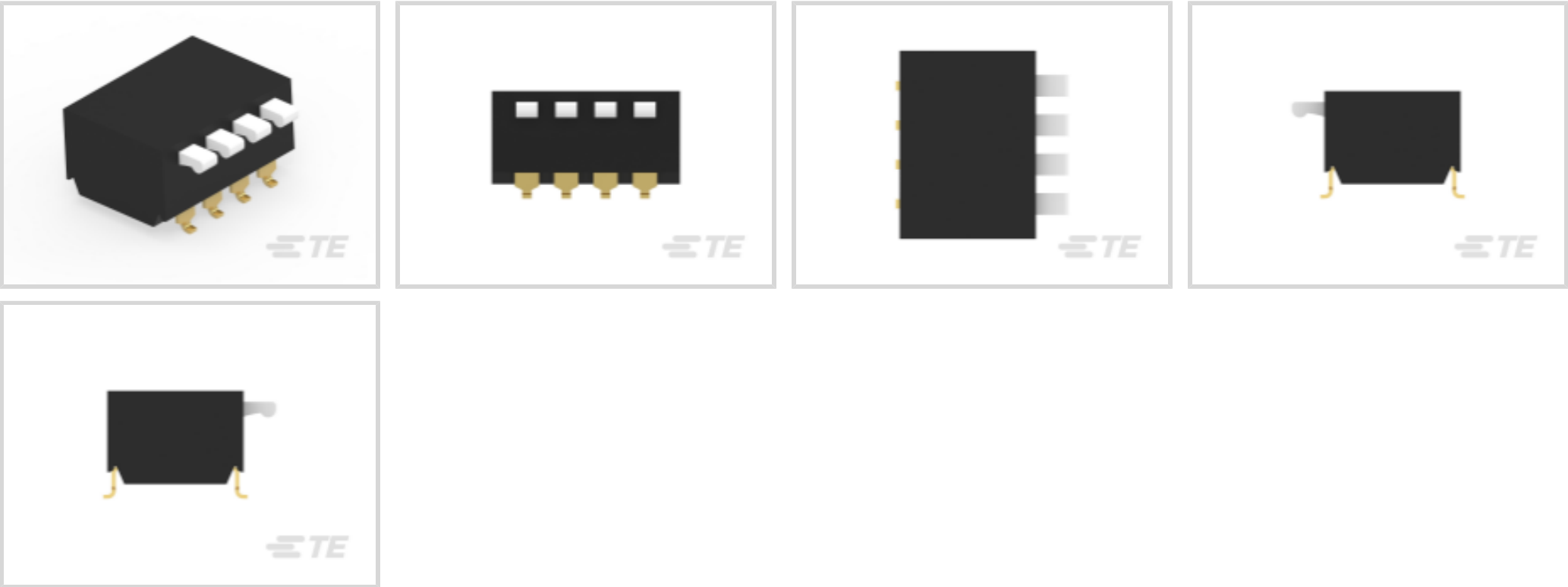

Switches > DIP & SIP Switches



DIP & SIP Switch Type: **DIP**  
Switch Contact Plating Material: **Gold**  
Case Color: **Black**  
Case Material: **Polyphenylene Sulfide (PPS)**  
Sealed Device: **No**

Features

Product Type Features

Leg Style	Gull Wing
DIP & SIP Switch Type	DIP
Sealed Device	No
Actuator Style	Piano (Side Actuated)

Configuration Features

Number of Positions	4
Number of Switches	4
Configuration (Pole-Throw)	Single Pole - Single Throw

Electrical Characteristics

Contact Current Rating	1 A
Operating Voltage	5 VDC

Body Features

Actuator Color	White
Product Orientation	Vertical



Case Color	Black
------------	-------

Case Material	Polyphenylene Sulfide (PPS)
---------------	-----------------------------

Contact Features

Contact Underplating Material	Nickel
-------------------------------	--------

1.2 μin

PCB Contact Termination Area Plating Material	Gold
---	------

Switch Contact Plating Material	Gold
---------------------------------	------

Contact Base Material	Copper Alloy
-----------------------	--------------

Termination Features

Termination Post & Tail Length	4 mm[.157 in]
--------------------------------	---------------

Termination Method to PCB	Surface Mount
---------------------------	---------------

Housing Features

On Position	Lever Down
-------------	------------

Centerline (Pitch)	2.54 mm[.1 in]
--------------------	----------------

Dimensions

Product Length	12.14 mm[.478 in]
----------------	-------------------

Product Height	6 mm[.236 in]
----------------	---------------

Usage Conditions

Operating Temperature Range	-30 – 85 °C
-----------------------------	-------------

Operation/Application

Assembly Process Feature	Auto-Insert Packaging
--------------------------	-----------------------

Industry Standards

UL Flammability Rating	UL 94V-0
------------------------	----------

Packaging Features

Packaging Method	Box & Tube, Tube
------------------	------------------

Packaging Quantity	35
--------------------	----

Product Compliance

For compliance documentation, visit the product page on TE.com>

EU RoHS Directive 2011/65/EU	Compliant
------------------------------	-----------

EU ELV Directive 2000/53/EC	Compliant
-----------------------------	-----------



China RoHS 2 Directive MIIT Order No 32, 2016	No Restricted Materials Above Threshold
EU REACH Regulation (EC) No. 1907/2006	Current ECHA Candidate List: JAN 2025 (247) Candidate List Declared Against: JUNE 2024 (241) Does not contain REACH SVHC
Halogen Content	Not Low Halogen - contains Br or Cl > 900 ppm.
Solder Process Capability	Reflow solder capable to 260°C

Product Compliance Disclaimer

This information is provided based on reasonable inquiry of our suppliers and represents our current actual knowledge based on the information they provided. This information is subject to change. The part numbers that TE has identified as EU RoHS compliant have a maximum concentration of 0.1% by weight in homogenous materials for lead, hexavalent chromium, mercury, PBB, PBDE, DBP, BBP, DEHP, DIBP, and 0.01% for cadmium, or qualify for an exemption to these limits as defined in the Annexes of Directive 2011/65/EU (RoHS2). Finished electrical and electronic equipment products will be CE marked as required by Directive 2011/65/EU. Components may not be CE marked. Additionally, the part numbers that TE has identified as EU ELV compliant have a maximum concentration of 0.1% by weight in homogenous materials for lead, hexavalent chromium, and mercury, and 0.01% for cadmium, or qualify for an exemption to these limits as defined in the Annexes of Directive 2000/53/EC (ELV). Regarding the REACH Regulation, the information TE provides on SVHC in articles for this part number is based on the latest European Chemicals Agency (ECHA) 'Guidance on requirements for substances in articles' posted at this URL: <https://echa.europa.eu/guidance-documents/guidance-on-reach>

Compatible Parts

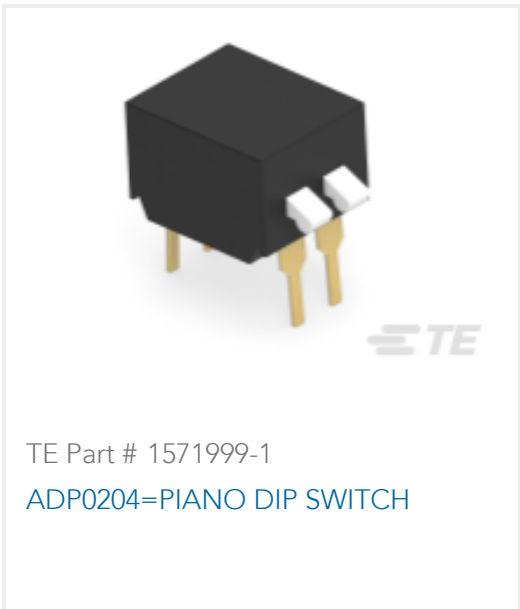

TE Part # 1571999-1  
ADP0204=PIANO DIP SWITCH

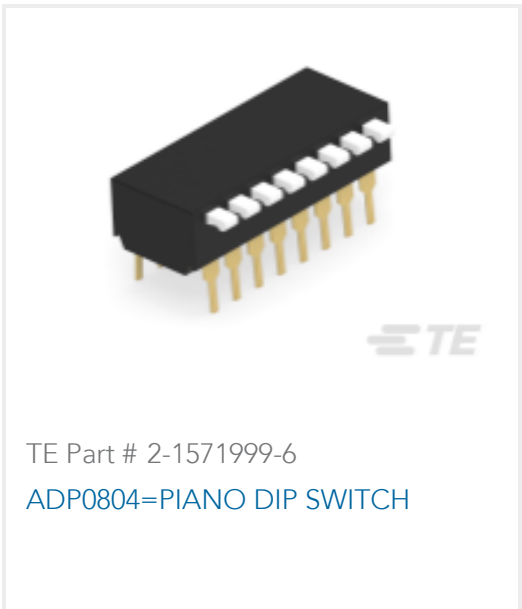

TE Part # 2-1571999-6  
ADP0804=PIANO DIP SWITCH



TE Part # 2-1571999-9  
ADP08STR04=PIANO DIP SWITCH

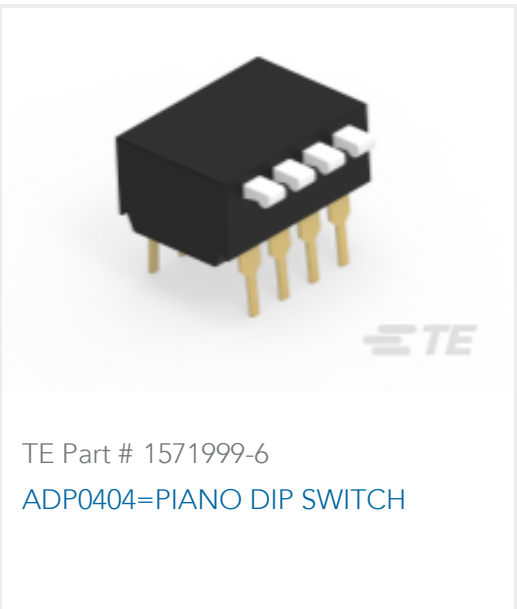

TE Part # 1571999-6  
ADP0404=PIANO DIP SWITCH

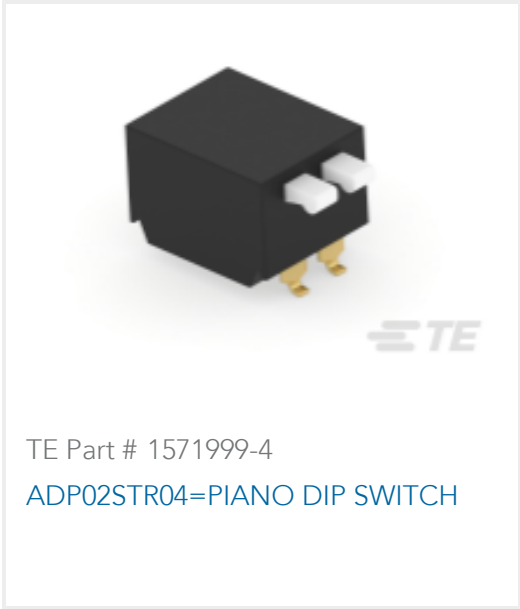

TE Part # 1571999-4  
ADP02STR04=PIANO DIP SWITCH

Also in the Series | [Alcoswitch DIP ADP & ADPA](#)

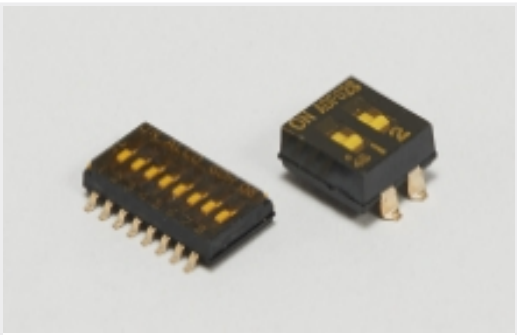

DIP & SIP Switches(160)

Also in the Series | [Alcoswitch DIP](#)

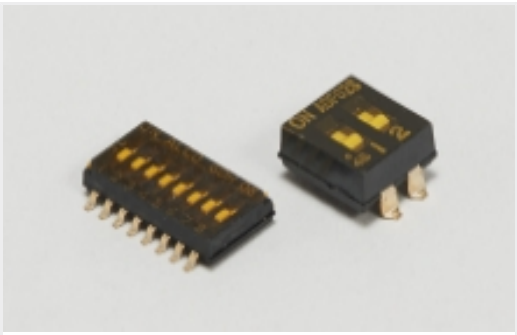

DIP & SIP Switches(160)



Rotary Switches(16)

Customers Also Bought



TE Part #DTF13-12PA  
HDR, 12P, GRY, RA, SN/NI/CU, A



TE Part #234478-E  
SRCA 1,27 12 M 1 SMD 137 E1 094 \* GURT \*



TE Part #2339978-7  
SFP56 STACKED 2X4 RECEPTACLE ASSEMBLY

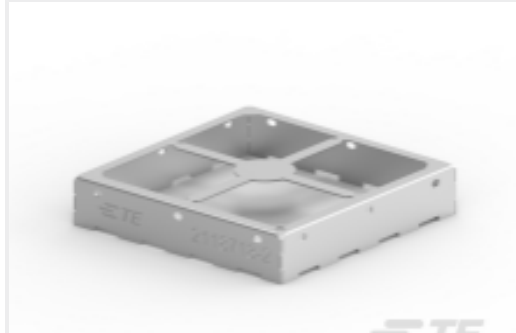

TE Part #2118718-2  
STD SHIELD FRAME, CRS-26.21X26. 21X5.08MM



TE Part #5745783-5  
25 MSFL RCPT RA 318 (SL,FM)



TE Part #225454-E  
M12 MALE, A CODE,RA, 8P THR REAR MOUNT

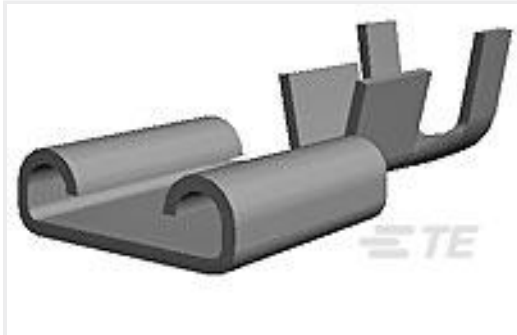

TE Part #5-160506-8  
250 FASTON REC 20-16 AWG TPBZ



TE Part #2118717-2  
STD SHIELD COVER, CRS-26.71X26. 71X2.00MM

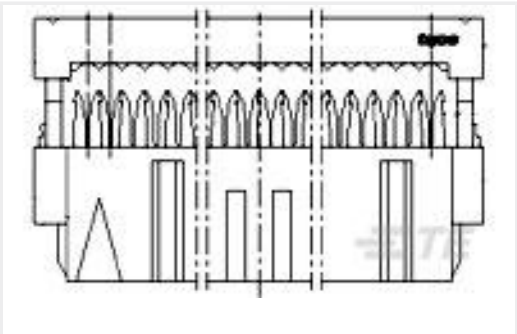

TE Part #6-215882-4  
64 WAY GREY MK II RECP



TE Part #CSI-SGFB-200-UFFR  
SMA to U.FL/MHF1 200mm 1.13 OD



Documents

Product Drawings

ADP04S04=PIANO DIP SWITCH

English

CAD Files

Customer View Model

ENG\_CVM\_CVM\_1571999-7\_E.3d\_igs.zip

English

Customer View Model

ENG\_CVM\_CVM\_1571999-7\_E.3d\_stp.zip

English

Customer View Model

ENG\_CVM\_CVM\_1571999-7\_E.2d\_dxf.zip

English

3D PDF

3D

By downloading the CAD file I accept and agree to the [Terms and Conditions](#) of use.

Datasheets & Catalog Pages

SWITCHES\_CORE\_PROGRAM\_CATALOG

English

ADE\_ADP\_ADF\_Datasheet

English