

| REVISIONS |             |            |      |      |
|-----------|-------------|------------|------|------|
| SYM       | DESCRIPTION | REVISED BY | DATE | APPR |
|           |             |            |      |      |

FULL SECTION

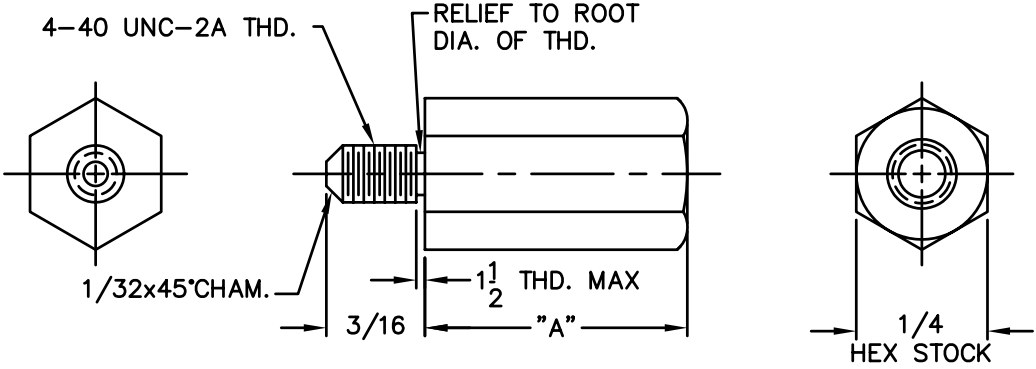
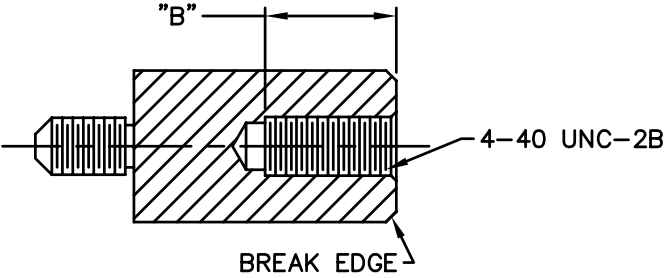

| STANDOFF |       |      |          |
|----------|-------|------|----------|
| PART NO. | "A"   | "B"  | NO. THDS |
| 8216     | .250  | .133 | 5-6      |
| 8217     | .375  | .250 | 8-9      |
| 8218     | .500  | .250 | 10-11    |
| 8219     | .625  | .250 | 10-11    |
| 8220     | .750  | .250 | 10-11    |
| 8221     | .875  | .250 | 10-11    |
| 8222     | 1.000 | .250 | 10-11    |
| 8223     | 1.125 | .250 | 10-11    |
| 8224     | 1.250 | .250 | 10-11    |
| 8225     | 1.375 | .250 | 10-11    |
| 8226     | 1.500 | .250 | 10-11    |
| 8227     | 1.625 | .250 | 10-11    |
| 8228     | 1.750 | .250 | 10-11    |
| 8229     | 2.000 | .250 | 10-11    |
| 8230     | 2.500 | .250 | 10-11    |
| 8231     | 3.000 | .250 | 10-11    |

|   |     |                        |                                |   |      |                |       |
|---|-----|------------------------|--------------------------------|---|------|----------------|-------|
| MATERIAL: BRASS-ALLOY 360- 1/2 HARD               |     | FINISH: NICKEL CODE#10 |                                | <h1>ABBATRON</h1> <p>Electronic Connectors and Hardware<br/>632 Arch Street, Meadville, Pa. 16335</p> |      |                |       |
| DIMENSIONAL TOLERANCES UNLESS OTHERWISE SPECIFIED |     |                        | TITLE: 8216-8231               |   |      |                |       |
| XX  | .XX | .XXX                   | BRASS HEX MALE/FEMALE STANDOFF |   |      |                |       |
| ---   | --- | ---                    |                                |   |      |                |       |
| FRACTIONS   |     | ANGLES                 | SCALE                          |   |      |                |       |
| ---   |     | ---                    | 4X                             |   |      |                |       |
| HEAT TREAT: ---                                   |     | DRAWN: T. LORD         |                                | DATE: 01/7/03   | SIZE | DRAWING NUMBER | ISSUE |
| PLOT SCALE: 1=1                                   |     | CHECKED: T. LORD       |                                | DATE: 01/7/03   | B    | SD: 8216-8231  | P     |
|   |     | APPROVED: T.LORD       |                                | DATE: 01/7/03   |      |                |       |