

DO NOT SCALE

DIMENSIONS IN mm

METRIC

THIRD ANGLE PROJECTION

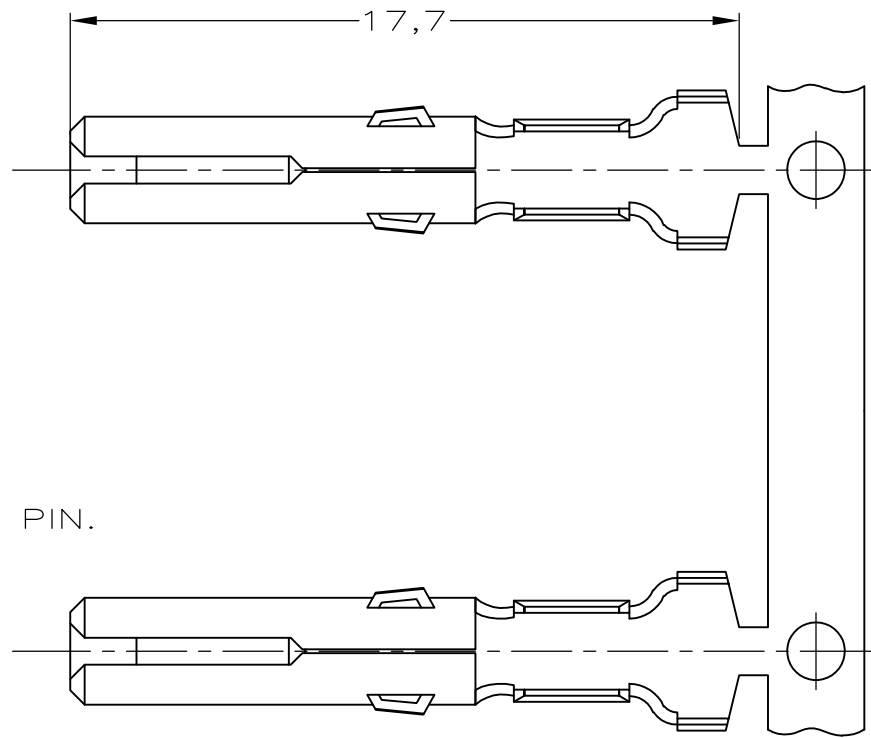
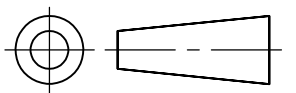

NOTES:

- ① FOR USE ON STANDARD APPLICATORS.(RIGHT-LEFT FEED)
- ② FOR USE ON MINIATURE APPLICATORS.(LEFT-RIGHT FEED)
- ③ FOR USE ON MINIATURE APPLICATORS, AMP O-MATOR APPLICATION.(LEFT-RIGHT FEED)
- ④ OBSOLETE PARTS: OBSOLETE CIS STREAMLINING PER D.RENAUD/D.SINISI

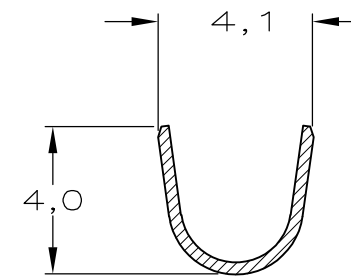

SECTION B-B

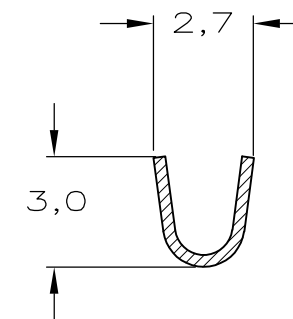

SECTION A-A

WIRE RANGE :
0,5-1,0mm <sup>2</sup> AWG
INSULATION RANGE :
1,8-3,3mm DIA.

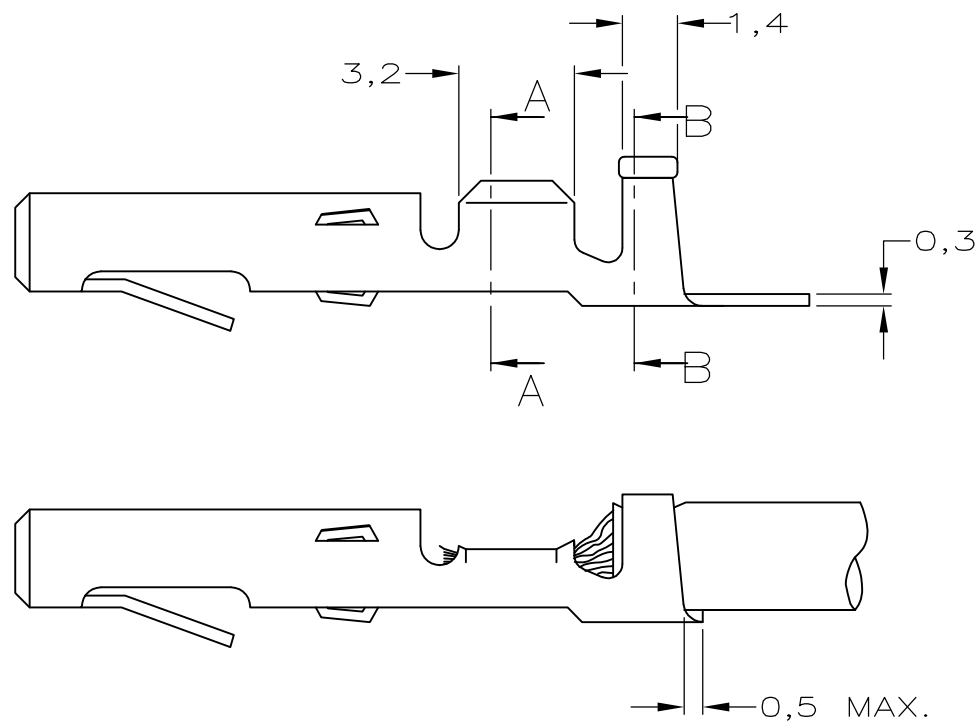

④ OBSOLETE	②	SEL. GOLD	BRASS	-8-163300-1
OBSOLETE	③	PRE-TINPLATED	BRASS	1-163300-5
	②	PRE-TINPLATED	PHOSPHOR BR.	163300-8
	②	UNPLATED	PHOSPHOR BR.	163300-7
	②	PRE-TINPLATED	BRASS	163300-6
	②	UNPLATED	BRASS	163300-5
④ OBSOLETE	①	PRE-TINPLATED	PHOSPHOR BR.	163300-4
	①	UNPLATED	PHOSPHOR BR.	163300-3
	①	PRE-TINPLATED	BRASS	163300-2
	①	UNPLATED	BRASS	163300-1
		PLATING	MATERIAL	PARTNUMBER

—					CUSTOMER DRAWING		FOR REFERENCE ONLY WILL NOT BE UPDATED	
—					©		BY AMP HOLLAND B.V.	
—					ALL		INTERNATIONAL RIGHTS RESERVED.AMP PRODUCTS MAY BE COVERED BY U.S. AND FOREIGN AND/OR PATENTS PENDING.	
—					THIS DRAWING IS UNPUBLISHED		RELEASED FOR PUBLICATION	
—					AMP		AMP HOLLAND B.V. 's-Hertogenbosch, The Netherlands.	
J1	ECO-10-002990	KK	HMR	11-02-10	NAME			
J	H-9701	JvdH	AB	13-04-92	SOCKET MATE-N-LOK.			
LTR.	REVISION RECORD	DR.	CHK.	DATE				
DR.: J.V.D.HEIJDEN.	CHK.: A.BIJNEN.	APP.: L.V.SOEST.	DWG.No.		REV.LTR.	SHEET		
DATE: 10-04-92	DATE: -	DATE: -	163300		J1	1 OF 1	A3	