

Features

- Maximum operating pressure is 12 bar.
- Operating temperature range -20°C to +100°C.
- Material: Brass / Steel / Aluminium Nickel & Zinc Plated Finish
- 2-Stage Security
- DN 7.4 Euro Profile
- ISO 4414
- Compatible with:
 - TST 026
 - PARKER - RECTUS 25, 26
 - CEJN 320
 - JWL 520, 530
 - PARKER PEF
 - LEGRIS

RS PRO Pneumatic Quick Connect Coupling

RS Stock No.: 0325590



RS PRO is the own brand of RS. The RS PRO Seal of Approval is your assurance of professional quality, a guarantee that every part is rigorously tested, inspected, and audited against demanding standards. Making RS PRO the Smart Choice for our customers.

Product Description

RS PRO Series 25S.08 Quick Connect Couplings

Pneumatic quick-connect coupling connectors are found across industry in pneumatic systems as diverse as robotic assembly lines and other equipment.

2 Stage Security System - Security is provided by pressing the button two times or by left-right sleeve twist. First press/twist releases the pressure inside the coupling and the second press/twist ejects the plug for disconnection.

- Maximum operating pressure is 12 bar.
- Operating temperature range -20°C to +100°C.
- Material: Brass / Steel / Aluminium Nickel & Zinc Plated Finish
- 2-Stage Security
- DN 7.4Euro Profile
- ISO 4414
- Compatible with:
 - TST 026
 - PARKER - RECTUS 25, 26
 - CEJN 320
 - JWL 520, 530
 - PARKER PEF
 - LEGRIS

Specifications

Manufacturer Series	025S.08
Coupling Type	Quick Connect Coupling Socket
Connection Standard	DN 7.4 Euro Profile
Connection Standard Compatible With	TST 026; PARKER - RECTUS 25 & 26; CEJN 320; JWL 520 & 530; PARKER PEF; LEGRIS
Minimum Operating Temperature	-20°C
Maximum Operating Temperature	+100°C
Maximum Operating Pressure	12bar
Flow	2 Stage, ISO 4414
Flow Direction & Sealing	Self-sealing coupling
Material	Aluminium, Brass, Steel
Finish	Nickel Plated
Connection Type	Threaded
Thread Size	1/2in
Thread Standard	G
Thread Gender	Female
Coupling Gender	Female
Threaded Connection	G 1/2 Female
Seal material	Nitrile Rubber
Hose Barb Connection	N/A

Specifications

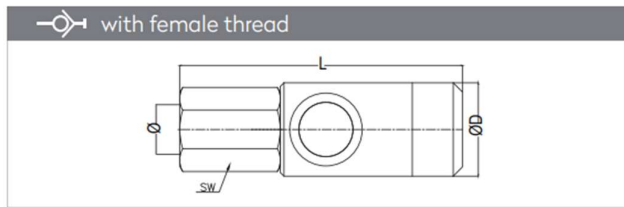

Dimensions (mm)		
SW	L	ØD
24	74.3	26

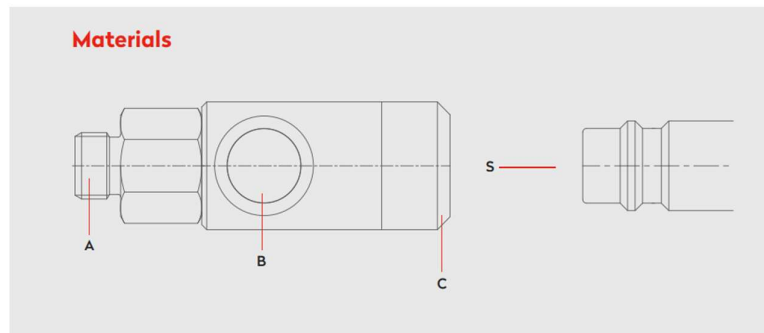

Material Code

A = Brass Nickel Plated

B = Steel Zinc Plated

C = Aluminium

S = Steel Zinc Plated

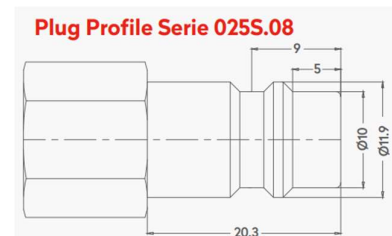
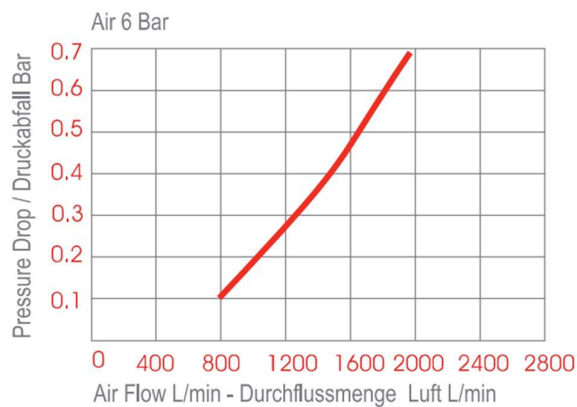

Series 25S.08 Quick Connect Couplings

	0 - 12 bar (0-174 PSI)		-20° to +100°C (NBR) -4° to +212°F	Shut Off Type	
	OM 190 - 00580 OM 178 - 00925 OM 178 - 00975	2 - STAGE ISO 4414		DN	7.4 mm