

Part No.	Cable color
~088*1~	GRAY
~088*2~	BLACK
~088*3~	WHITE

NOTE ① We indicate the length of the harness on the last of product name. 'L' part.

② Tolerance for [ L ]

Length L [mm]	Tolerance [mm]
$35 \leq L \leq 200$	$\pm 4$
$200 < L \leq 500$	$\pm 8$
$500 < L \leq 1000$	$\pm 12$
$1000 < L$	$\pm 1.5\%$

③ Connector rotation angle is within  $\pm 45$  degree from the above image. For long length in the case of  $L > 500$ , the angle is optional.

4. Specifications are subject to change without notice.

【 DIMENSIONS OF CONNECTOR 】

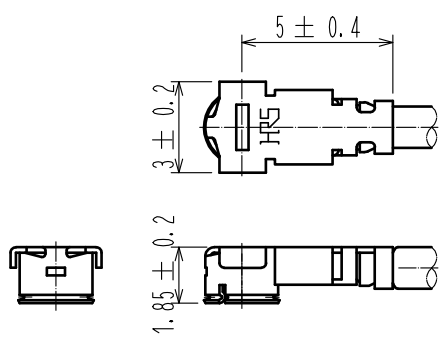

1	U. FL-LP-088	CL331-0454-0	2	1.37 Dia. coaxial cable
NO.	PART NO.	CODE NO.	NO.	PART NO.

UNITS mm	SCALE FREE	COUNT	DESCRIPTION OF REVISIONS	DESIGNED	CHECKED	DATE
<b>HIROSE ELECTRIC CO., LTD.</b>	APPROVED	•NK. NINOMIYA	16. 07. 22	DRAWING NO.		
	CHECKED	•MT. KANEKO	16. 07. 21	PART NO.		
	DESIGNED	•MS. MATSUMOTO	16. 07. 21	U. FL-2LP-088**T-A-L		
	DRAWN	•MS. MATSUMOTO	16. 07. 21	CODE NO.		