

## DETAILS

<b>Product Number</b>	C13254_HELENA-B
<b>Family</b>	Helena
<b>Type</b>	Lens
<b>Color</b>	clear
<b>Diameter</b>	72,8 mm
<b>Height</b>	11,1 mm
<b>Style</b>	round
<b>Optic Material</b>	PC
<b>Holder Material</b>	
<b>Fastening</b>	
<b>Status</b>	ready
<b>ROHS Compliant</b>	Yes
<b>Date Updated</b>	27/02/2013



## OPTICAL PROPERTIES

LED	Viewing Angle	Light Beam	Efficiency	cd/lm	Connector
LUXEON K8	23 deg	Medium	75 %	2.550	-
LUXEON K12	24 deg	Medium	74 %	2.100	-
LUXEON K16	27 deg	Medium	74 %	1.730	-

D

C

B

A

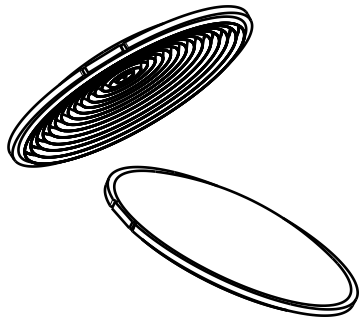

Isometric view  
Scale: 1:2

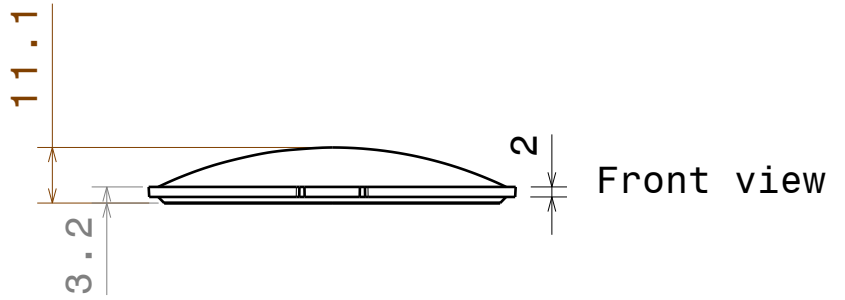

Front view

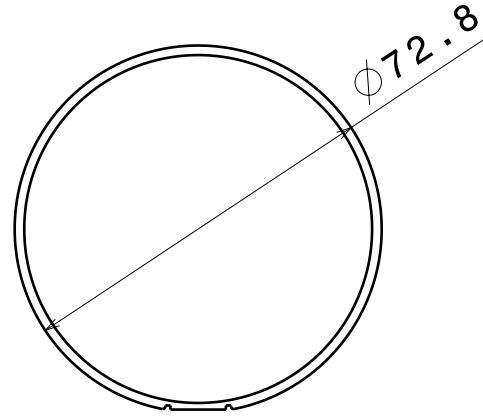

Top view

Tolerances for dimensions:  
 0-20mm tolerance value  $\pm 0.1\text{mm}$   
 21-45mm tolerance value  $\pm 0.2\text{mm}$   
 46-90mm tolerance value  $\pm 0.3\text{mm}$   
 91-100mm tolerance value  $\pm 0.4\text{mm}$   
 101-mm tolerance value  $\pm 0.5\text{mm}$

This drawing is our property.  
 It can't be reproduced  
 or communicated without  
 our written agreement.



Ledil Oy  
 Salorankatu 10  
 FIN 24240 SALO  
 Finland

DRAWING TITLE

Datasheet C13254\_HELENA-B Lens

DRAWN BY		DATE		DRAWING NUMBER				REV	
CHECKED BY		DATE		C13254		1			
DESIGNED BY		DATE		SCALE 1:1		WEIGHT (g)		SHEET 1/1	

D

A

Luminaire: LEDiL Oy C13254\_HELENA-B\_(Luxeon\_K8) Eff. 75,1%  
Lamps: 1 x Luxeon K8 (609lm@250mA)

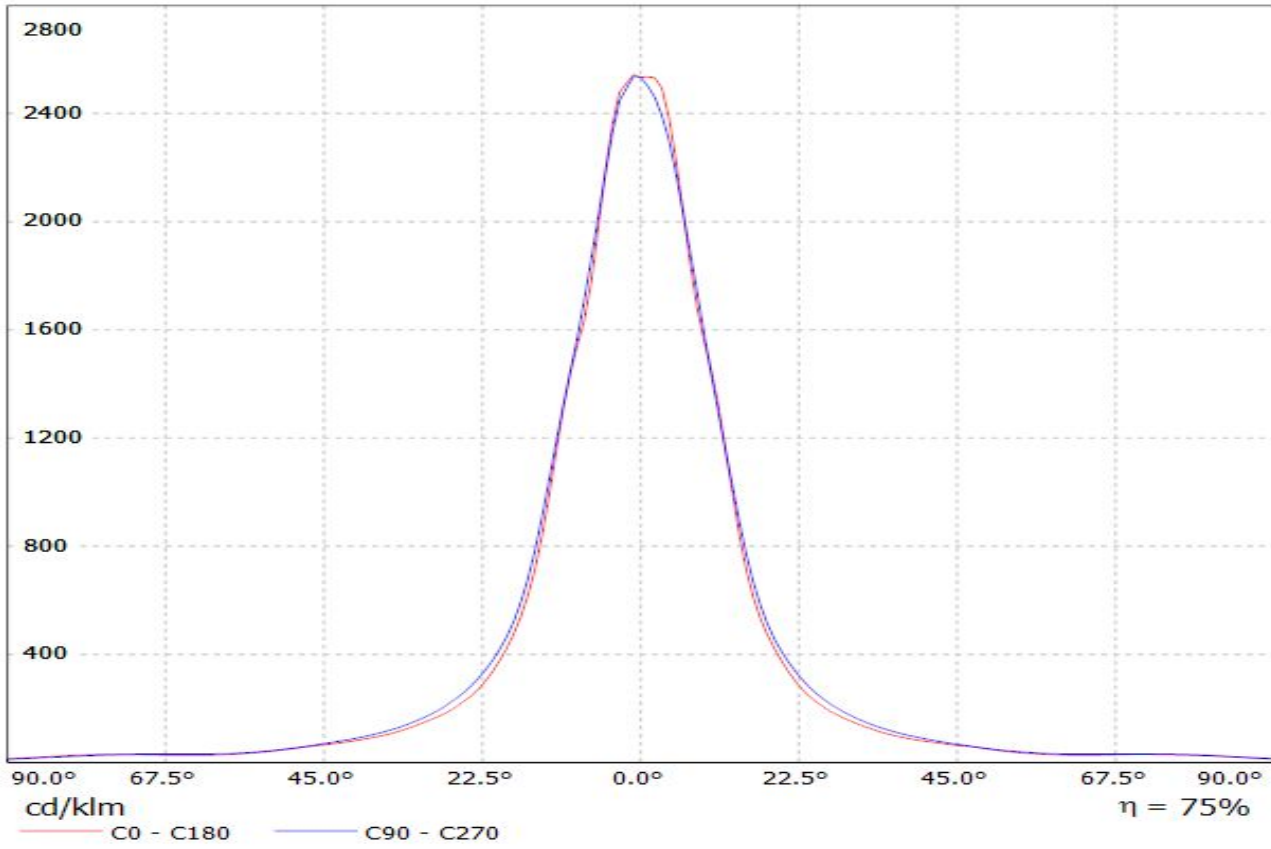

Luminaire: LEDiL Oy C13254\_HELENA-B\_(Luxeon\_K12) Eff. 73,7%  
Lamps: 1 x Luxeon K12 (797lm@250mA)

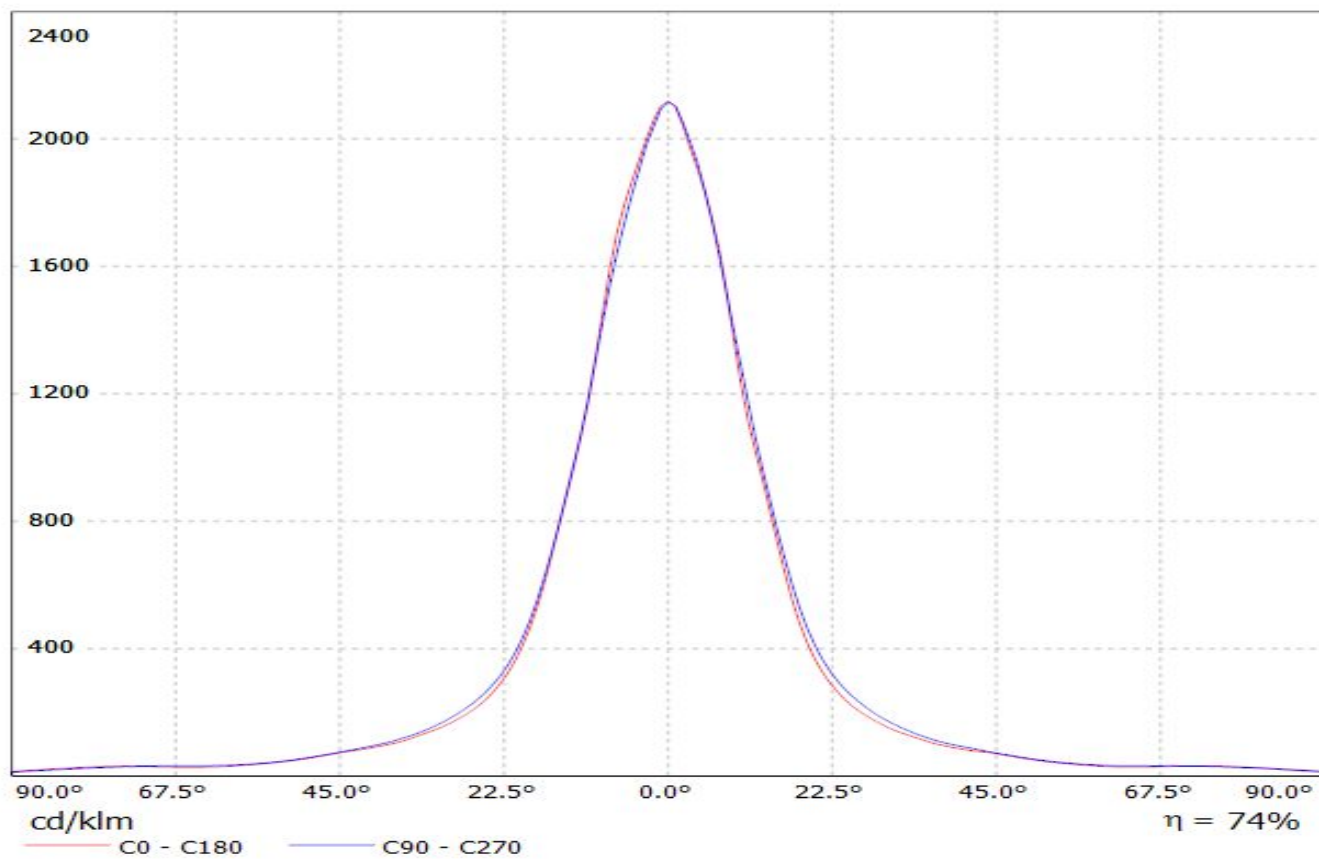

Luminaire: LEDiL Oy C13254\_HELENA-B\_(LUXEON\_K16) Eff.73.6%  
Lamps: 1 x LUXEON K16 (1196.37lm@250mA)

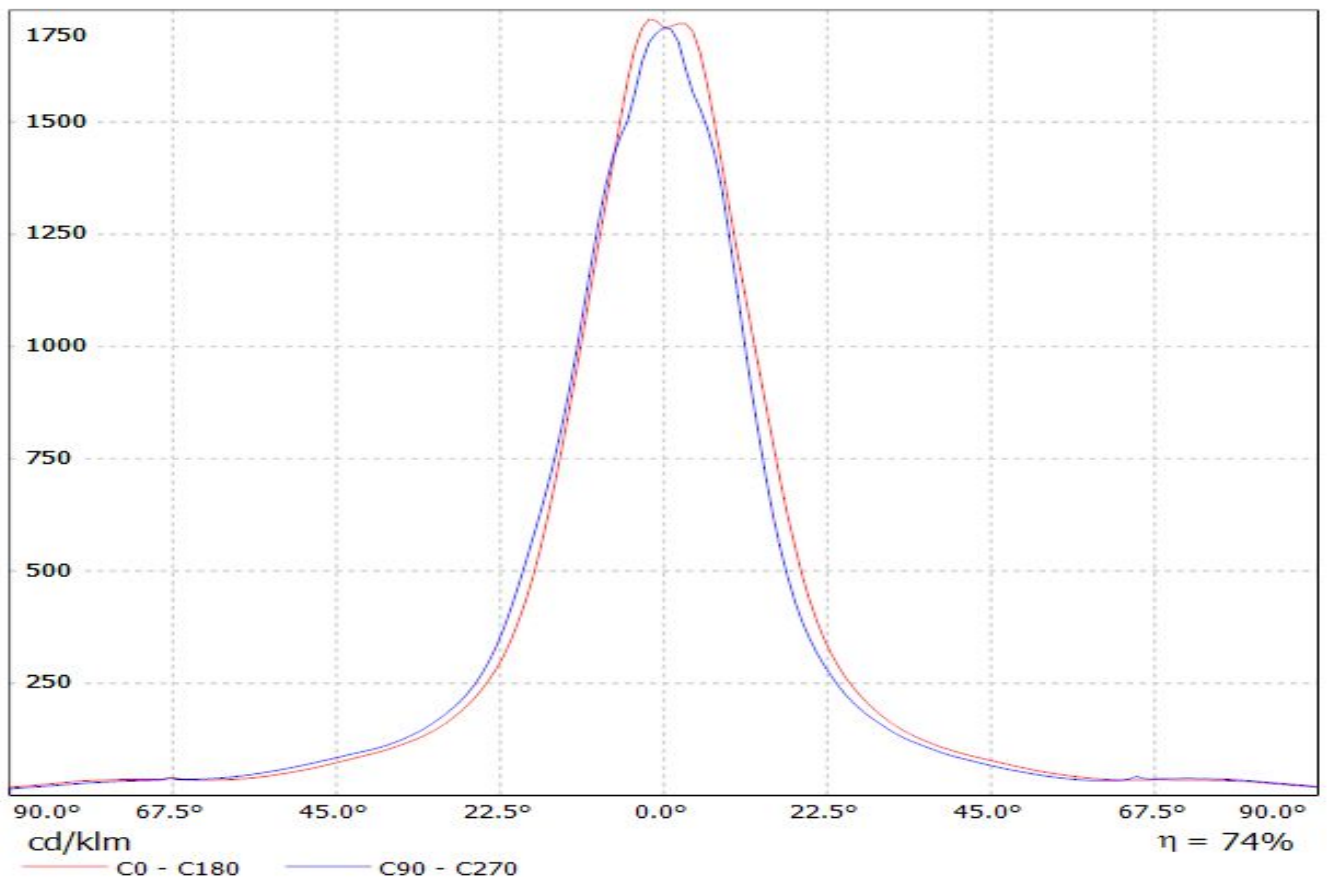

Luminaire: LEDiL Oy C13254\_HELENA-B\_(Luxeon\_K8) Eff. 75,1%  
Lamps: 1 x Luxeon K8 (609lm@250mA)

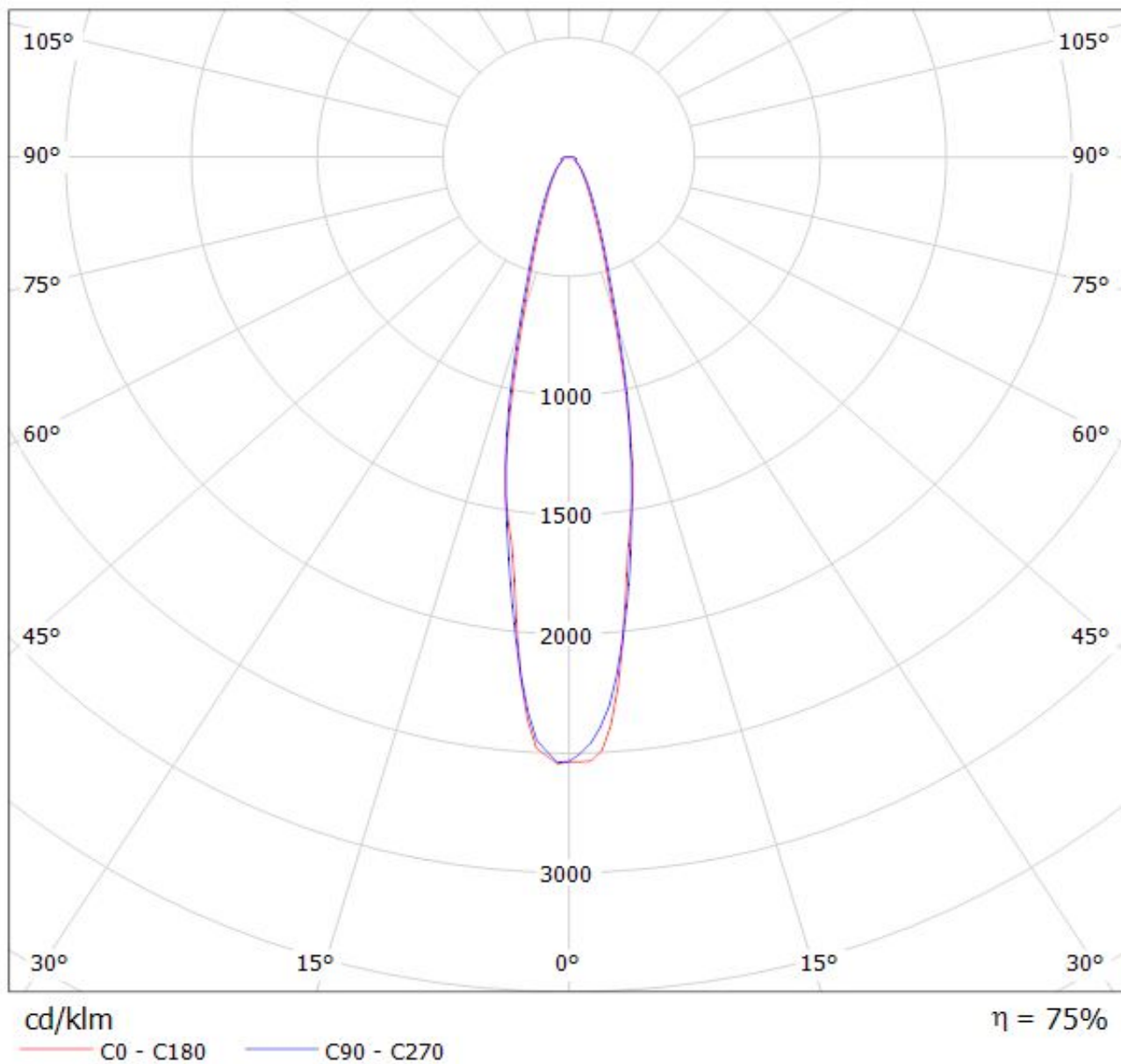

Luminaire: LEDiL Oy C13254\_HELENA-B\_(Luxeon\_K12) Eff. 73,7%  
Lamps: 1 x Luxeon K12 (797lm@250mA)

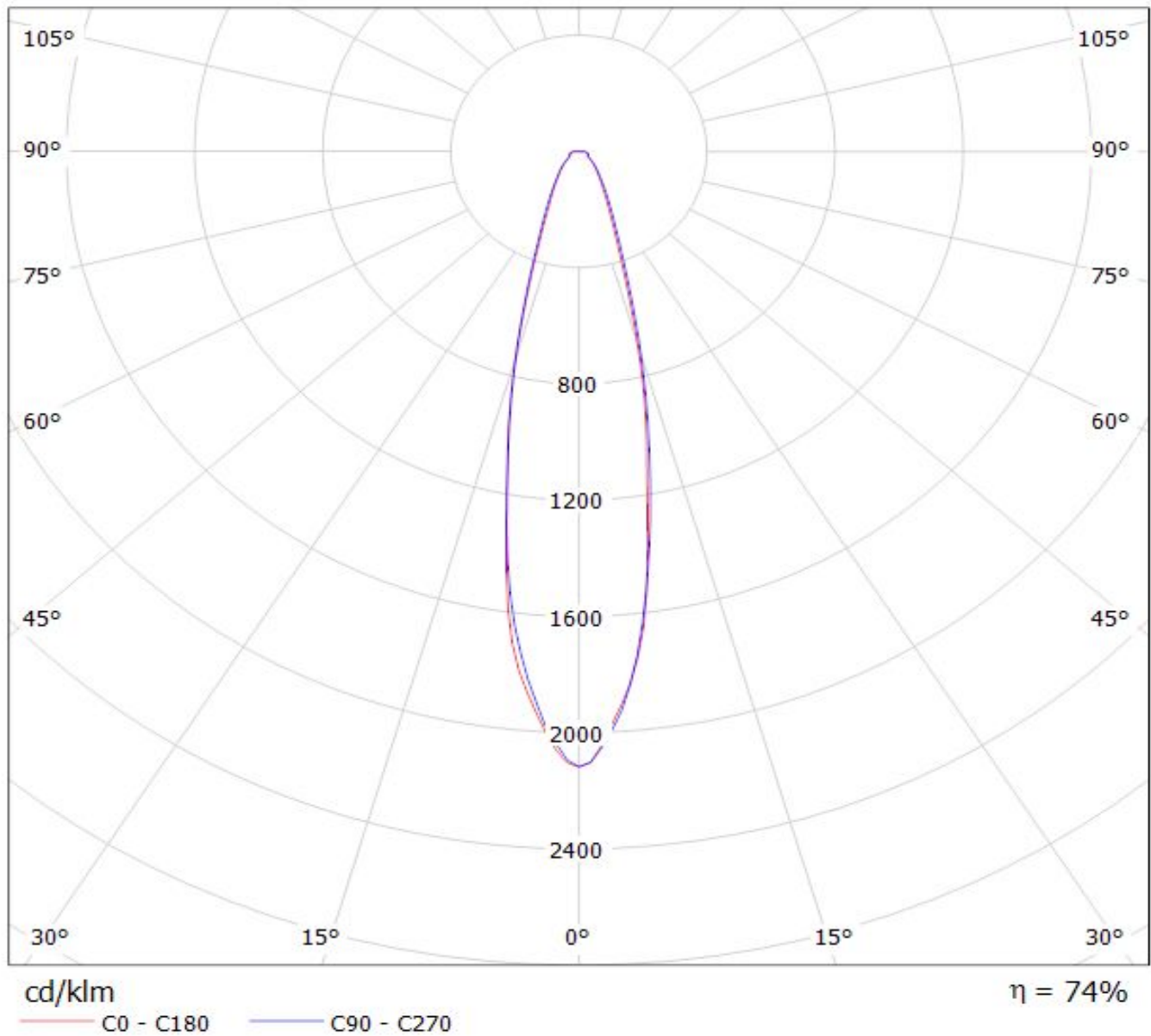

Luminaire: LEDiL Oy C13254\_HELENA-B\_(LUXEON\_K16) Eff.73.6%  
Lamps: 1 x LUXEON K16 (1196.37lm@250mA)

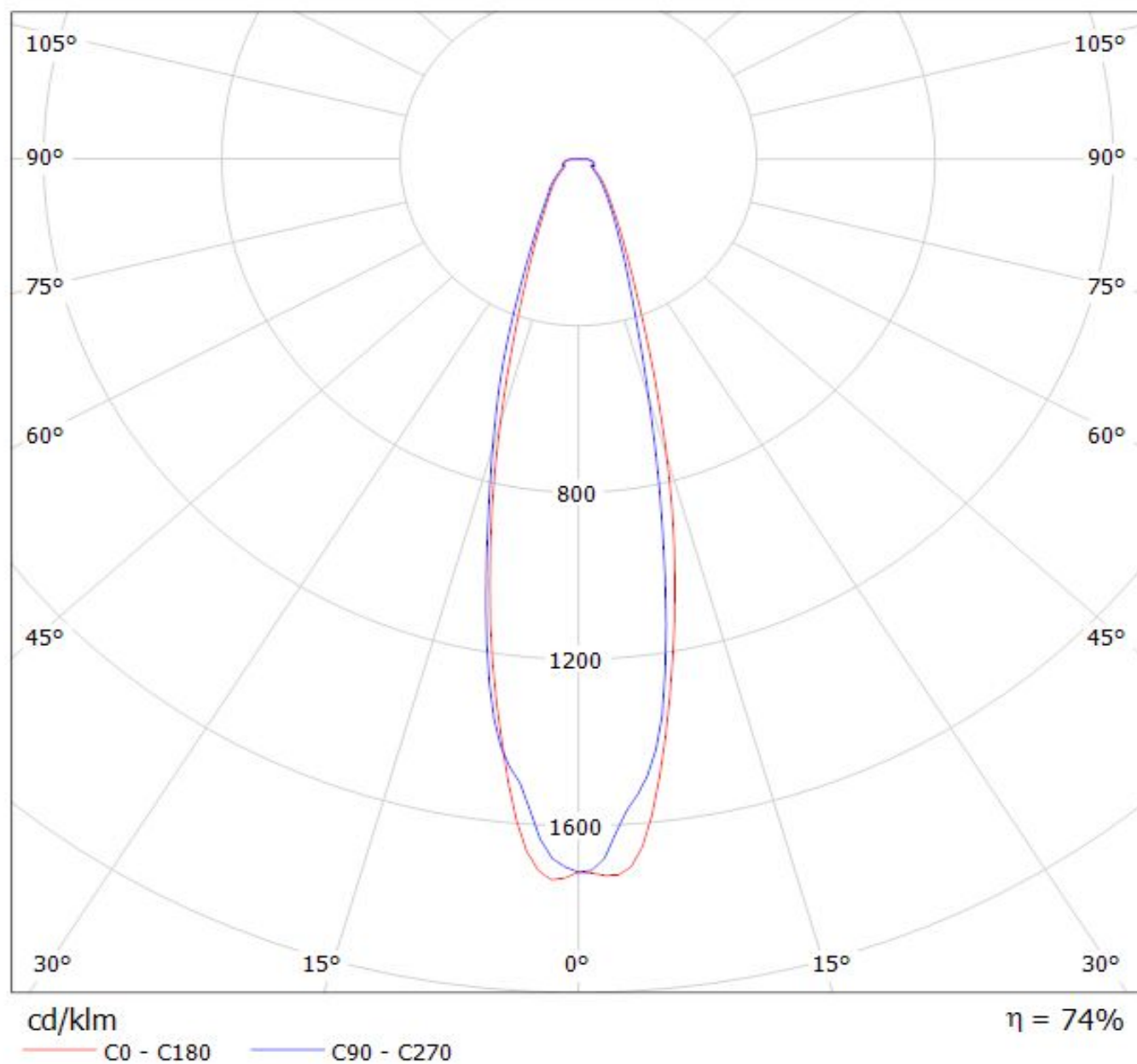



**NOTE: The typical divergence will be changed by different color, chip size and chip position tolerance. The typical total divergence is the full angle measured where the luminous intensity is half of the peak value.**