

**FAG****6309-RSR**

Deep groove ball bearing

Deep groove ball bearing 63...-RSR, single row, seal, steel sheet metal cage

Technical information

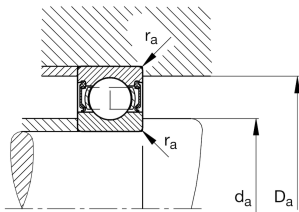
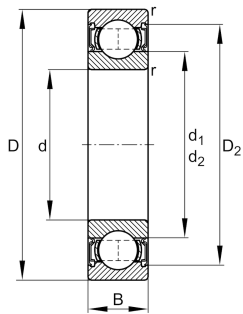

Your current product variant

Sealing	RSR	Contact seal on one side
Cage	JN	Steel sheet metal
Tolerance class	PN	Normal (PN)
Dimensional / heat stabilization	S0	Rings dimensional stabilized up to 150°
Lubricant	Without	Bearing not greased
Radial internal clearance	CN (Group N)	Normal internal clearance
Bore type	Z	Cylindrical

Main Dimensions & Performance Data

d	45 mm	Bore diameter
D	100 mm	Outside diameter
B	25 mm	Width
C _r	56,000 N	Basic dynamic load rating, radial
C _{0r}	31,500 N	Basic static load rating, radial
C _{ur}	2,240 N	Fatigue load limit, radial
n _G	4,300 1/min	Limiting speed
≈m	0.829 kg	Weight

Mounting dimensions

d _{a min}	54 mm	Minimum diameter shaft shoulder
D _{a max}	91 mm	Maximum diameter of housing shoulder
r _{a max}	1.5 mm	Maximum fillet radius



Dimensions

r _{min}	1.5 mm	Minimum chamfer dimension
D ₁	83.3 mm	Shoulder diameter outer ring
D ₂	85.64 mm	Caliber diameter outer ring
d ₁	62 mm	Shoulder diameter inner ring







Temperature range

T _{min}	-30 °C	Operating temperature min.
T _{max}	100 °C	Operating temperature max.

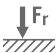
Calculation factors

f ₀	12.9	Calculation factor
----------------	------	--------------------

Characteristics

-  Radial load
-  Axial load in one direction
-  Axial load in two directions
-  Grease Lubrication
-  Oil Lubrication
-  Sealed on one side