

FAG

61976-MA

Deep groove ball bearing

Deep groove ball bearing 619..-MA, single row, solid brass cage

Technical information

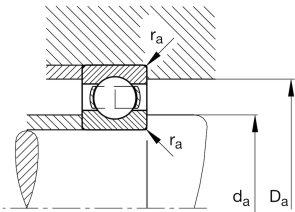
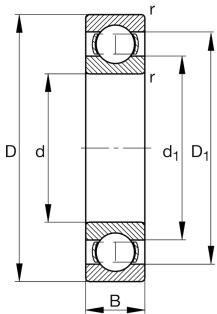

Your current product variant

Sealing	Without	Not sealed
Cage	MA	Solid brass cage, outer ring guided
Tolerance class	PN	Normal (PN)
Dimensional / heat stabilization	S1	Rings dimensional stabilized up to 200°
Lubricant	Without	Bearing not greased
Radial internal clearance	CN (Group N)	Normal internal clearance
Bore type	Z	Cylindrical

Main Dimensions & Performance Data

d	380 mm	Bore diameter
D	520 mm	Outside diameter
B	65 mm	Width
C <sub>r</sub>	365,000 N	Basic dynamic load rating, radial
C <sub>0r</sub>	580,000 N	Basic static load rating, radial
C <sub>ur</sub>	15,600 N	Fatigue load limit, radial
n <sub>G</sub>	2,050 1/min	Limiting speed
n <sub>gr</sub>	1,450 1/min	Reference speed
≈m	41.5 kg	Weight



Mounting dimensions

$d_{a\min}$	394.6 mm	Minimum diameter shaft shoulder
$D_{a\max}$	505.4 mm	Maximum diameter of housing shoulder
$r_{a\max}$	3 mm	Maximum fillet radius

Dimensions

$r_{\min}$	4 mm	Minimum chamfer dimension
$D_1$	479.3 mm	Shoulder diameter outer ring
$d_1$	423.3 mm	Shoulder diameter inner ring

Temperature range

$T_{\min}$	-30 °C	Operating temperature min.
$T_{\max}$	200 °C	Operating temperature max.

Calculation factors

$f_0$	16.3	Calculation factor
-------	------	--------------------

Characteristics

- 

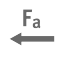
Radial load
- 

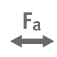
Axial load in one direction
- 

Axial load in two directions
- 

Grease Lubrication
- 

Oil Lubrication
- 

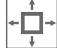
Not sealed
- 

Large bearing