

# 61906-2RS1

## Dimensions

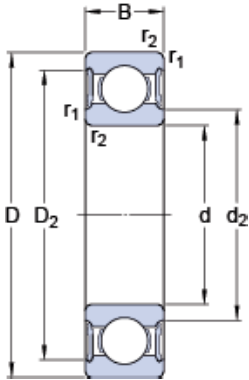

d	30	mm
D	47	mm
B	9	mm
D <sub>2</sub>	≈ 42.7	mm
r <sub>1,2</sub>	min. 0.3	mm

## Abutment dimensions

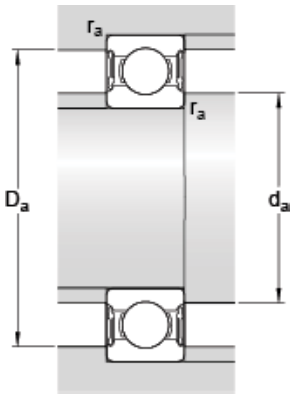

d <sub>a</sub>	min. 32	mm
d <sub>a</sub>	max. 34	mm
D <sub>a</sub>	max. 45	mm
r <sub>a</sub>	max. 0.3	mm

## Calculation data

Basic dynamic load rating	C	7.28	kN
Basic static load rating	C <sub>0</sub>	4.55	kN
Fatigue load limit	P <sub>u</sub>	0.212	kN
Limiting speed		8500	r/min
Calculation factor	k <sub>r</sub>	0.02	
Calculation factor	f <sub>0</sub>	14.4	

## Mass

Mass bearing	0.051	kg
--------------	-------	----