

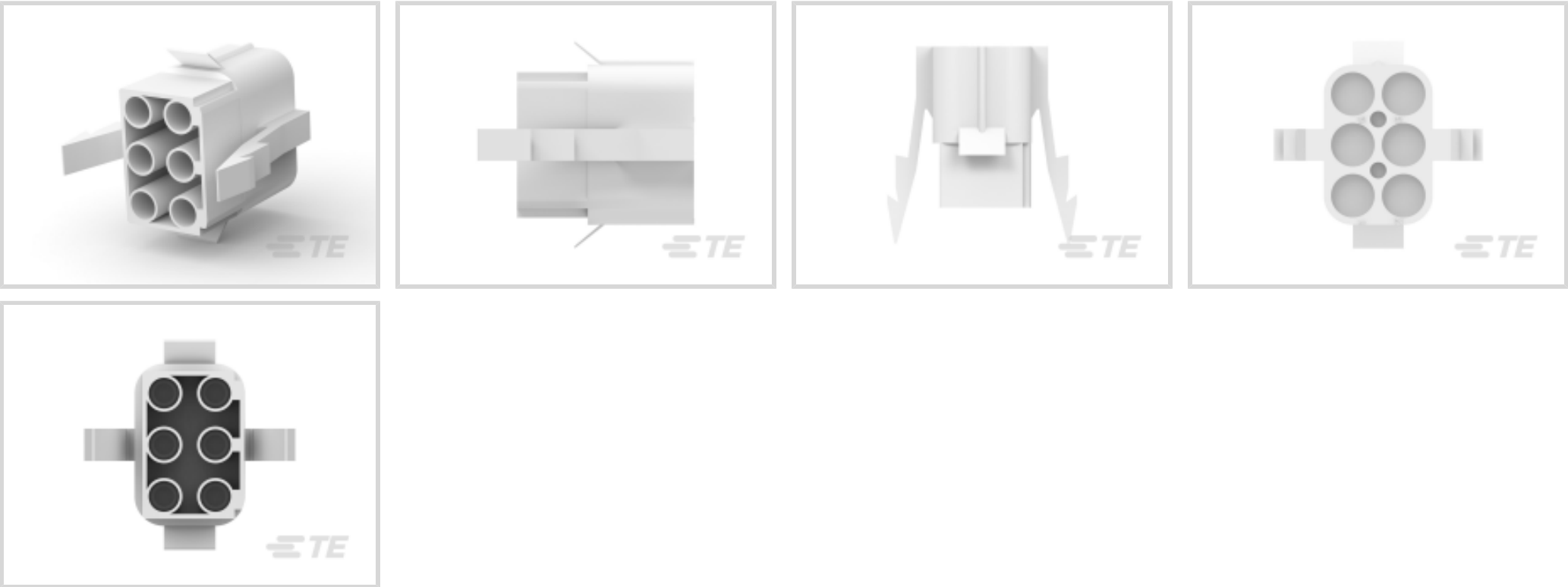

Connectors > Rectangular Connectors > Standard Rectangular Connectors



Connector Product Type: **Housing**
Connector & Housing Type: **Plug**
Termination Method to Wire & Cable: **Crimp**
Connector System: **Wire-to-Panel, Wire-to-Wire**
Contact Retention Within Housing: **Without**

Features

Product Type Features

Connector Product Type	Housing
Connector & Housing Type	Plug
Connector System	Wire-to-Panel, Wire-to-Wire
Sealable	No
Connector & Contact Terminates To	Wire & Cable

Configuration Features

Number of Positions	6
Number of Rows	2

Electrical Characteristics

Operating Voltage	250 VAC
-------------------	---------

Body Features

Primary Product Color	Natural
-----------------------	---------

Contact Features

--	--



Contact Type	Socket
Contact Retention Within Housing	Without

Termination Features

Termination Method to Wire & Cable	Crimp
------------------------------------	-------

Mechanical Attachment

Panel Mount Feature	With
Panel Mount Feature Type	Locking Leg
Connector Mounting Type	Panel Mount

Housing Features

Housing Material	Nylon
Centerline (Pitch)	7.11 mm[.28 in]

Dimensions

Row-to-Row Spacing	7.1 mm[.28 in]
Panel Thickness (Recommended)	.64 – 1.65 mm[.025 – .065 in]

Usage Conditions

Operating Temperature Range	-55 – 105 °C[-67 – 221 °F]
-----------------------------	----------------------------

Operation/Application

Circuit Application	Power & Signal
---------------------	----------------

Identification Marking

Circuit Identification Feature	With
--------------------------------	------

Industry Standards

Compatible With Agency/Standards Products	CSA, UL
UL Rating	Certified, Recognized
Compatible With Approved Standards Products	UL E28476
CSA Rating	LR 16455
Glow Wire Rating	Standard Part - Not Glow Wire
UL Flammability Rating	UL 94V-2

Packaging Features

Packaging Quantity	400
Packaging Method	Bag



Product Compliance

For compliance documentation, visit the product page on TE.com>

EU RoHS Directive 2011/65/EU	Compliant
EU ELV Directive 2000/53/EC	Compliant
China RoHS 2 Directive MIIT Order No 32, 2016	No Restricted Materials Above Threshold
EU REACH Regulation (EC) No. 1907/2006	Current ECHA Candidate List: JAN 2025 (247) Candidate List Declared Against: JAN 2025 (247) Does not contain REACH SVHC
Halogen Content	Low Halogen - Br, Cl, F, I < 900 ppm per homogenous material. Also BFR/CFR/PVC Free
Solder Process Capability	Not applicable for solder process capability

Product Compliance Disclaimer

This information is provided based on reasonable inquiry of our suppliers and represents our current actual knowledge based on the information they provided. This information is subject to change. The part numbers that TE has identified as EU RoHS compliant have a maximum concentration of 0.1% by weight in homogenous materials for lead, hexavalent chromium, mercury, PBB, PBDE, DBP, BBP, DEHP, DIBP, and 0.01% for cadmium, or qualify for an exemption to these limits as defined in the Annexes of Directive 2011/65/EU (RoHS2). Finished electrical and electronic equipment products will be CE marked as required by Directive 2011/65/EU. Components may not be CE marked. Additionally, the part numbers that TE has identified as EU ELV compliant have a maximum concentration of 0.1% by weight in homogenous materials for lead, hexavalent chromium, and mercury, and 0.01% for cadmium, or qualify for an exemption to these limits as defined in the Annexes of Directive 2000/53/EC (ELV). Regarding the REACH Regulation, the information TE provides on SVHC in articles for this part number is based on the latest European Chemicals Agency (ECHA) ‘Guidance on requirements for substances in articles’ posted at this URL: <https://echa.europa.eu/guidance-documents/guidance-on-reach>

Compatible Parts



TE Part # 1-163035-0
6P.MATE-N-LOK HSG

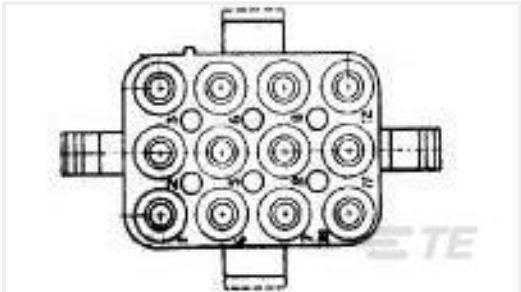

TE Part # 1-163032-0
MATEN LOK HOUSING

Also in the Series | Commercial MATE-N-LOK



Connector Contacts(150)

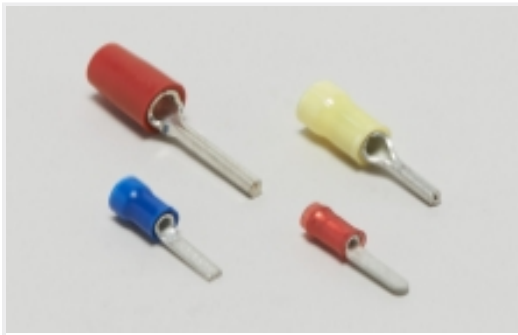

Crimp Wire Pins, Tabs & Ferrules(2)



Power Contacts(146)



Rectangular Connector Housings(118)



Rectangular Power Connectors(182)



Standard Circular Connectors(2)



Standard Rectangular Connectors(126)

Customers Also Bought

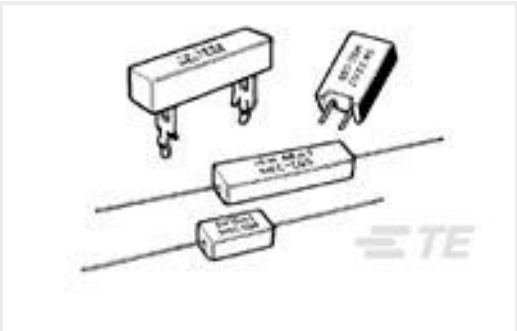

TE Part #1-1623782-2
SQM5 470R 5% (METAL FILM)



TE Part #2-1879223-7
CPF 0603 442R 0.1% 25PPM 1K RL



TE Part #CAT-H3399-SL34
Heavy Duty Sealed Connector Series
Fixing Slides

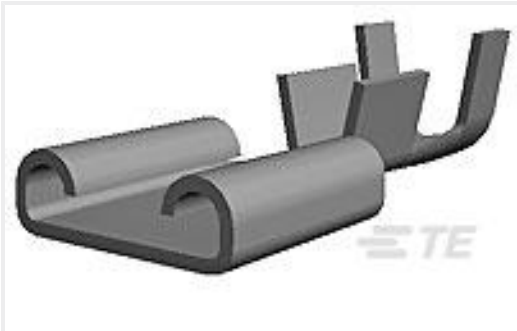

TE Part #5-160432-3
250 FASTON REC 20-16 AWG BR



TE Part #1879224-1
CPF 0603 3K01 0.1% 25PPM 1K RL



TE Part #3-644461-6
06P MTA156 CONN ASSY 18AWG LF

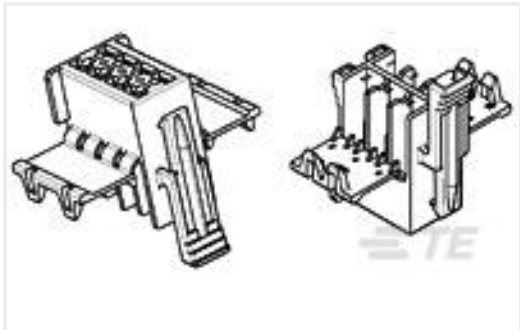

TE Part #1-929504-5
2X 7P JUN-POW-TIMGH



TE Part #1483354-3
MICRO-MATCH LEAD 12P 250MM



TE Part #1587733-1
SHIPPING CAP, CAP, HVA280-3PM

Documents



Product Drawings

6P.MATE-N-LOK HSG

English

CAD Files

Customer View Model

ENG_CVM_1-163036-0_G.3d_igs.zip

English

Customer View Model

ENG_CVM_1-163036-0_G.3d_stp.zip

English

Customer View Model

ENG_CVM_1-163036-0_G.2d_dxf.zip

English

3D PDF

English

By downloading the CAD file I accept and agree to the [Terms and Conditions](#) of use.

Product Specifications

Application Specification

English

Agency Approvals

Agency Approval Document

English