



**FAG**

## SES522-619-L [↗](#)

### Plummer block housing

Split plummer block housing for various bearing designs. The SNV series will be replaced by the new SES series in 2022.

## Technical information

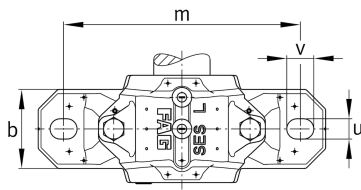

### Main Dimensions & Performance Data

D	200 mm	Outside diameter bearing
a	410 mm	Length base
h <sub>1</sub>	242 mm	Height
g	175 mm	Width housing body
K	80 mm	Width bearing seat
≈m	22.8 kg	Weight

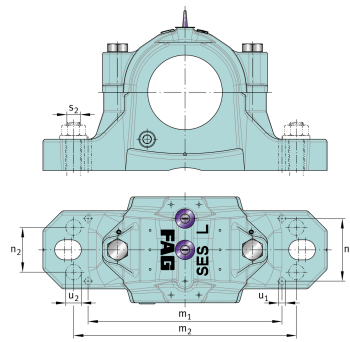
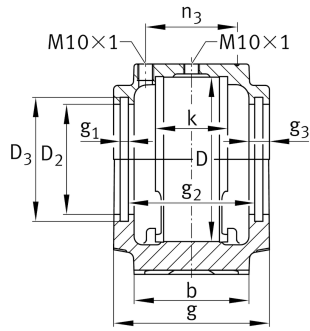
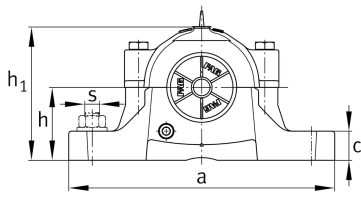

## Dimensions

b	120 mm	Width base
c	45 mm	Height base
h	125 mm	Base to shaft centerline height
m	350 mm	Distance fixing bore
s	22.225 mm	Screw size
s	M24	Size of fixing screws
u	26 mm	Width slot
v	32 mm	Length slot
D 2	147.5 mm	Diameter sealing
D 3	157.5 mm	Diameter sealing groove
D 5	154.7 mm	Outside diameter sealing labyrinth
g 1	6 mm	Width sealing groove
g 2	155 mm	Distance sealing
g 3	14 mm	Wall thickness
g 4	37.5 mm	Distance oil lubrication
m 1	296 mm	Distance holes aligned pins m1
n 3	111 mm	Distance lubrication
n 4	157 mm	Distance lubrication sealing
u 1	8 mm	Bore diameter u1
u 2	18 mm	Bore diameter u2