

Features

- Silver plated
- 2 Claw Support
- Female
- 10A

RS PRO Heavy Duty Connectors Contacts

RS Stock No.:

0180196



RS PRO is the own brand of RS. The RS PRO Seal of Approval is your assurance of professional quality, a guarantee that every part is rigorously tested, inspected, and audited against demanding standards. Making RS PRO the Smart Choice for our customers.

Product Description

The RS Pro Heavy-Duty Connector series is a full range of heavy-duty inserts, housings, crimps and accessories. These crimps have two claws for extra support and are compatible with the RS Pro range of heavy-duty inserts. These connectors have been designed for situations where they will encounter harsh environments. This makes them ideal for food & beverage manufacturing, packaging machines, conveyor belt systems, railway, oil & gas processing and other industrial automation.

General Specifications

Material	Silver Plated
Connector type	Crimp
Current Rating	10A
Gender	Female
Contact Resistance	$\leq 3\text{m}\Omega$
For Use With	RS-HD, RS-HDD, RS-HM, RS-HK, RS-HQ inserts

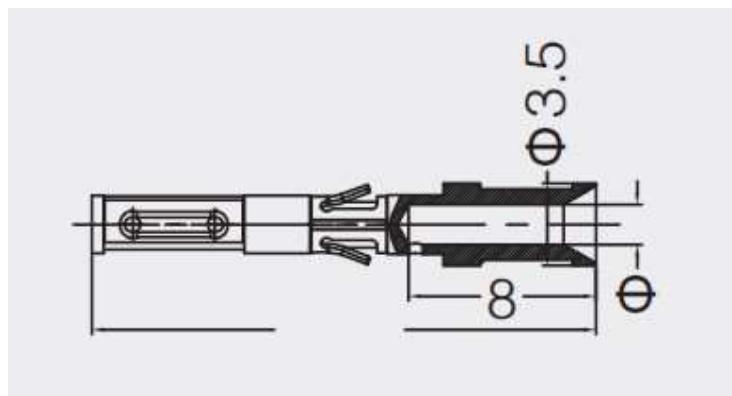

Wire Gauge	Φ	Stripping length
0.5 mm ²	1.1	8 mm