

Core
FS-1ETD-3411-00

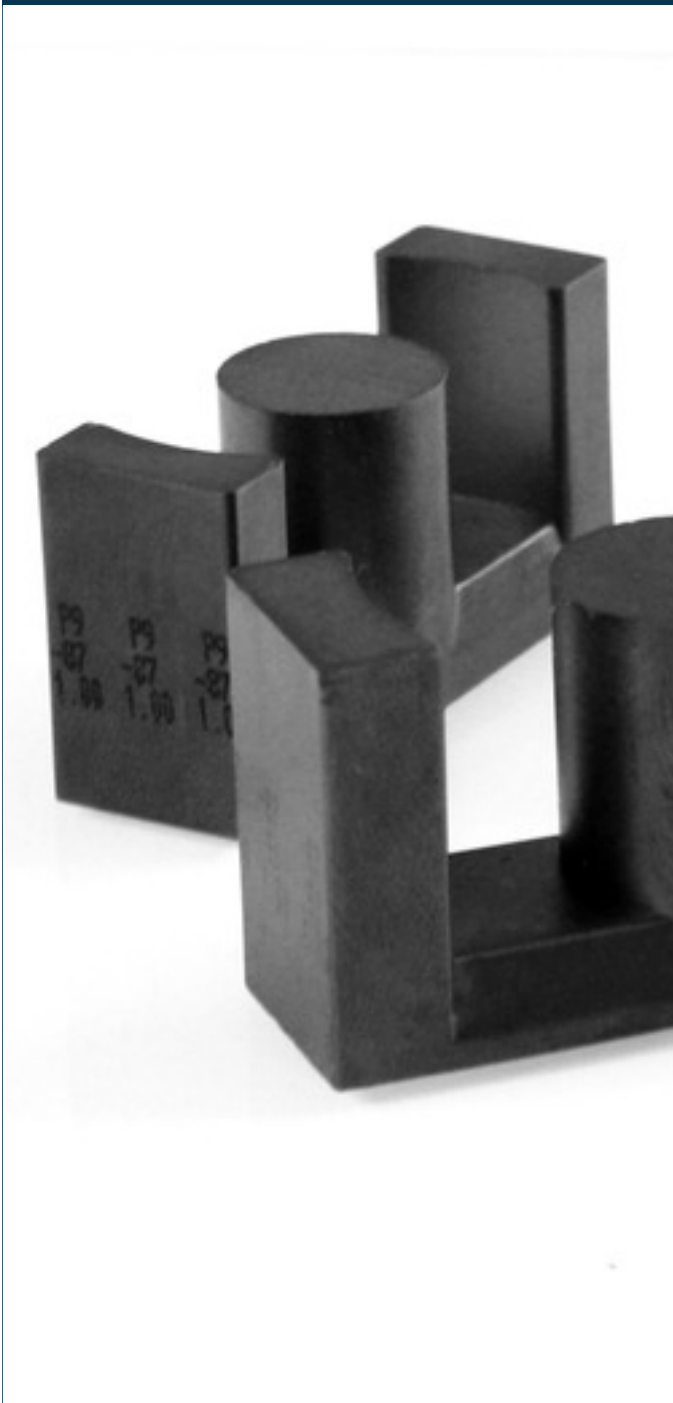

Advantages

Insertion of air gaps on request

On request wound inductors to EN61558-2-16 standard an EN60950 or vacuum potted

Cost saving and easy compilation of components for pattern construction through unification

Applications

Transformers and reactors in switch mode power supplies

Approvals

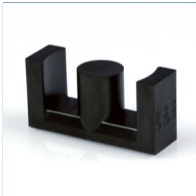

Core FS-1ETD-3411-00

Type		FS-1ETD-3411-00
Electrical data	General data	
	for housing	FS-1ETD-3411
	Magnetic characteristics	
		>210°C
		<450 kW/m³
		21A/m @25°C
		13A/m @100°C
		>380
	Ae	97.1 mm²
		91.6 mm²
	Le	78.6 mm
		2600 nH ± 25%
		0 nH ± 10%
		790 nH ± 10%
		482 nH ± 10%
	251 nH ± 10%	
	153 nH ± 10%	
	115 nH ± 10%	
	93 nH ± 10%	
	80 nH ± 10%	
Operating data		
		25 kHz - 200 kHz
Notes		
		ISO 2768-m
Order numbers		
Order Number		FS-1ETD-3411-00

Type		FS-1ETD-3411-00
Notes		
Remark		

30 Mechanical data

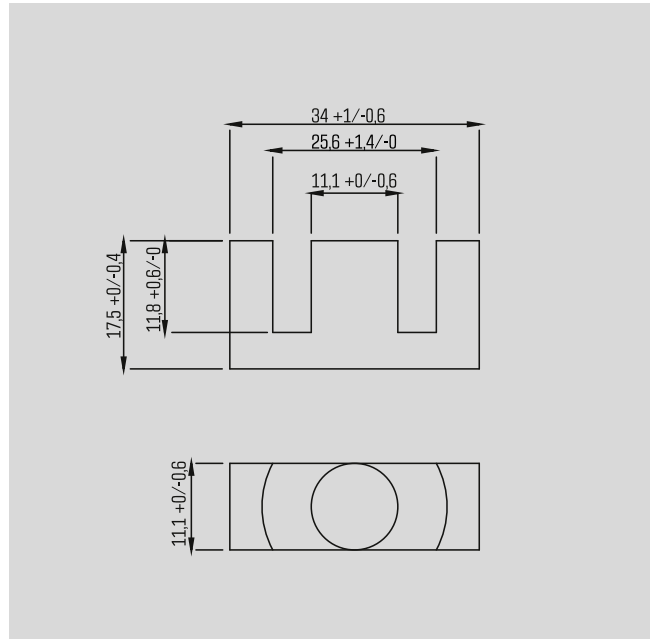

Subjects to change.