



Preinsulated Female, Male and Piggyback Disconnects

General features

- ✓ Tin-plated brass double crimp "S" version.
- ✓ Tin-plated bronze double crimp "51000" version.
- ✓ Copper sleeve for crimping insulation giving better resistance to vibration.
- ✓ Polycarbonate insulation sleeve.
- ✓ Max. operating temperature: +125°C.
- ✓ Flammability rating: UL94V0.



POLYCARBONATE INSULATION

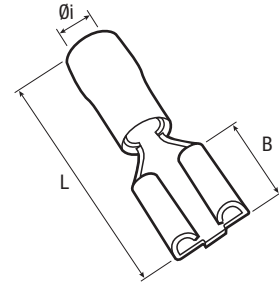

Preinsulated Female Disconnects

mm ²	Brass				Bronze				Male disconnect		Ø i	B	L	
	Bulk packing		x100 /Box		Bulk packing		x100 /Box		Width	Thickness				
	Item code	Part No.	Item code	Part No.	Item code	Part No.	Item code	Part No.						
● 0.34 - 1.5	7250500	SQA2,8-3*	7251017	B100SQA2,8-3*	7260505	51031-3*	7261026	B100-51031-3*	3.6	2.8	0.3	1.7	6.5	19.5
	7250501	SQA2,8-5*	7251014	B100SQA2,8-5*	7260506	51031-2*	7261019	B100-51031-2*	3.6	2.8	0.5	1.7	6.5	19.5
	7250502	SQA2,8-8*	7251018	B100SQA2,8-8*	7260508	51031-8*	7261029	B100-51031-8*	3.6	2.8	0.8	1.7	6.5	19.5
	7251084	SQA4,7-5	7251086	B100SQA4,7-5	-	-	-	-	3.6	4.8	0.5	1.7	6	18.7
	7251065	SQA4,7-8	7251066	B100SQA4,7-8	-	-	-	-	3.6	4.8	0.8	1.7	6	18.7
	7251024	SQA-5N	7251037	B100SQA-5N	7261042	51081-2	7261047	B100-51081-2	3.6	5	0.8	1.7	7.7	21
● 1 - 2.5	7251032	SQA-6,35	7251033	B100SQA-6,35	7261072	51181-2	7261071	B100-51181-2	3.6	6.3	0.8	1.7	7.7	21
	7251085	SQB4,7-5	7251087	B100SQB4,7-5	-	-	-	-	4.3	4.8	0.5	2.4	6	18.7
	7251067	SQB4,7-8	7251068	B100SQB4,7-8	-	-	-	-	4.3	4.8	0.8	2.4	6	18.7
	7251044	SQB5N	7251038	B100SQB5N	7261052	51131-2	7261053	B100-51131-2	4.8	5	0.8	2.4	7.7	21
	7251052	SQB6,35	7251053	B100SQB6,35	7261082	51231-2	7261081	B100-51231-2	4.8	6.3	0.8	2.4	7.7	21
	7251055	SQB8**	7251080	B100SQB8**	-	-	-	-	4.3	8	0.8	2.4	9	23
● 2.6 - 6	7251072	SQC6,35	7251082	B100SQC6,35	7261109	51661-4J	7261112	B100-51661-4J	6.8	6.3	0.8	3.4	7.7	25
	7251074	SQC9,5**	7251083	B100SQC-9,5**	-	-	-	-	6.4	9.4	1.2	3.4	12.1	29.6

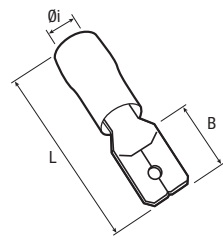

SQM...

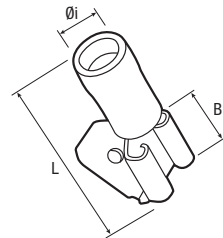

SQV...

Preinsulated Male and Piggyback Disconnects

mm ²	Bulk packing		x100 /Box		Male disconnect		Ø i	B	L	
	Item code	Part No.	Item code	Part No.	Width	Thickness				
					Ø mm					
● 0.34 - 1.5	7250011	SQMA-6,35	7250012	B100SQMA-6,35	3.5	6.3	0.8	1.7	8	20.5
	7251251	SQVA-6,35	7251253	B100SQVA-6,35	3.5	6.3	0.8	1.7	7.8	22.2
● 1 - 2.5	7250021	SQMB-6,35	7250022	B100SQMB-6,35	4	6.3	0.8	2.4	8	20.5
	7251261	SQVB-6,35	7251260	B100SQVB-6,35	4	6.3	0.8	2.4	7.8	22.2
● 2.6 - 6	7250031	SQMC-6,35	7250033	B100SQMC-6,35	5.5	6.3	0.8	3.4	8	24.5
	7250031	SQMC-6,35	7250033	B100SQVC-6,35	5.5	6.3	0.8	3.4	8	24
	7251271	SQVC-6,35	7251272	B100SQVC-6,35	5.5	6.3	0.8	3.4	8	24

Conductor size (mm²)

Packing

Cable insulation max Ø

* = Polyamide insulation
** = Notched

Unless otherwise stated, all dimensions are in millimeters.