

Without locking ring.

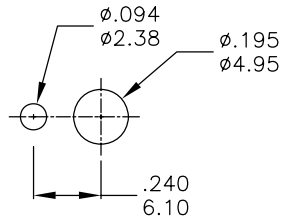

With standard locking ring.

PANEL MOUNTING

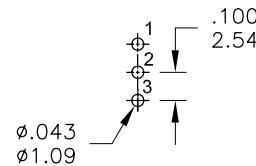

P.C. MOUNTING

Model No.	POS.1	POS.2	POS.3
2MS3	ON	OFF	ON
Term. Comm.	2-3	OPEN	2-1
SCHEMATIC			

SWITCH FUNCTION



**SPECIFICATIONS**

- MECHANICAL LIFE:** 30,000 make-and-break cycles.
- CONTACT RESISTANCE:** 20mΩ max. initial @ 2-4VDC  
100mA for both silver and gold plated contacts.
- INSULATION RESISTANCE:** 1,000MΩ min.
- DIELECTRIC STRENGTH:** 1,000 V RMS@sea level.
- OPERATING TEMPERATURE:** -30°C to 85°C.

**MATERIALS**

- CASE -** Diallyl phthalate(DAP)( UL94V-0 )
- ACTUATOR -** Brass,chrome plated
- BUSHING -** Brass,nickel plated
- HOUSING -** Stainless Steel
- SWITCH SUPPORT -** Brass,tin plated.
- TERMINALS/CONTACT -** Brass, with Silver or gold plated.
- RoHS- 2002/95/EC**

**RATING :**

- R : 0.4 Volt-Amps(VA) max. @20V max.(AC or DC)
- Q : 1Amp @250VAC
- 3Amps @120 VAC or 28 VDC

符號	原尺寸	修改後尺寸	變更日期	SCALE (比例) : 3 : 2	TITLE 圖名	Sub - Miniature Toggle Switches	SIZE 圖紙	A4		
1	(A)			TOLERANCE (公差) : 0.00 mm ± 0.25mm 0.0 mm ± 0.40mm ANGULAR : ± 5° FILE NAME : 2MSP0506	DWG NO. 圖號	2MS3T1B4M2QES	UNIT 單位	inch mm		
2	(B)				REV. 版本	A	DATE 日期	MAY - 16 - 2008	SHEET 張數	1 of 1
3	(C)				CHECKED BY 審核	RICHARD	DRAWN BY 製圖	FION		
4	(D)									
5	(E)									