

# SKINTOP® K-M, KR-M ATEX

Special cable gland according to ATEX for hazardous areas

equip. group II  
cat. 2G+1D



## SKINTOP® K-M ATEX

**Approval No.:**  
**DMT 03 ATEX E 044X**

The construction and design are the same as those of the well known SKINTOP® ST-M, with multiple trapezoidal thread for easy and safe installation and equipped with patented protection against vibration. Especially for cables in

selfprotecting circuits in hazardous areas, which require class “e” security. The SKINTOP® K-M ATEX are approved according to the directive 94/9/EC ATEX 100a (DIN EN 50014/50019). The tested features are especially:

- dynamic strain stability
- strain relief
- protection class

Application fields are devices, machines and installations of protection class increased security, e.g. in chemical and petrochemical industry.



## SKINTOP® KR-M ATEX

**Approval No.:**  
**DMT 03 ATEX E 044X**

The SKINTOP® KR-M ATEX possesses the same characteristics as the SKINTOP® K-M

ATEX and is equipped with a reduced sealing-ring, to seal cables and wires of small outer diameter.

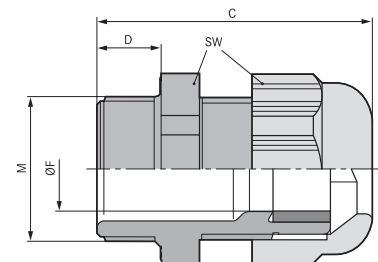

Technical Data	Material:	Standard colour:	Temperature range:	Protection class:	Tests:	Attention
SKINTOP® K-M ATEX	body: polyamid sealing: CR/NBR	RAL 9005 black	-20°C up to +80°C	IP 64	DIN-EN 50014 DIN-EN 50019	Installation dimensions and tightening torque values see instruction leaflet
SKINTOP® KR-M ATEX	body: polyamid sealing: CR/NBR	RAL 9005 black	-20°C up to +80°C	IP 64	DIN-EN 50014 DIN-EN 50019	Installation dimensions and tightening torque values see instruction leaflet

Part number	Designation size M	Thread M	Clamping range F mm	Wrench size mm	C mm	D mm	PU pieces
<b>SKINTOP® K-M ATEX</b>							
5411 5200	K-M 12 ATEX	12 x 1,5	3 - 5,5	15	26,5 - 30	8	50
5411 5210	K-M 16 ATEX	16 x 1,5	7 - 9	19	29 - 34	8	50
5411 5220	K-M 20 ATEX	20 x 1,5	7 - 13	25	34 - 37	9	50
5411 5230	K-M 25 ATEX	25 x 1,5	11 - 17	30	35 - 40	10	25
5411 5240	K-M 32 ATEX	32 x 1,5	12 - 21	36	39 - 47	10	25
5411 5250	K-M 40 ATEX	40 x 1,5	19 - 28	46	43 - 52	10	10
5411 5260	K-M 50 ATEX	50 x 1,5	27 - 35	55	54 - 62	12	5
5411 5270	K-M 63 ATEX	63 x 1,5	36 - 45	66	59 - 71	12	5
<b>SKINTOP® KR-M ATEX</b>							
5411 5205	KR-M 12 ATEX	12 x 1,5	2 - 4	15	26,5 - 30	8	50
5411 5215	KR-M 16 ATEX	16 x 1,5	4 - 6	19	29 - 34	8	50
5411 5225	KR-M 20 ATEX	20 x 1,5	5 - 10	25	34 - 37	9	50
5411 5235	KR-M 25 ATEX	25 x 1,5	6 - 13	30	35 - 40	10	25
5411 5245	KR-M 32 ATEX	32 x 1,5	9 - 15	36	39 - 47	10	25
5411 5255	KR-M 40 ATEX	40 x 1,5	16 - 23	46	43 - 52	10	10
5411 5265	KR-M 50 ATEX	50 x 1,5	22 - 29	55	54 - 62	12	5
5411 5275	KR-M 63 ATEX	63 x 1,5	29 - 39	66	59 - 71	12	5