

## Manifold

### Technical characteristics

**Operating pressure:** 2 to 12 bar

**Temperature:** - 20°C to + 80°C

**Construction:** Aluminium

Drill Ø: 6.5 mm

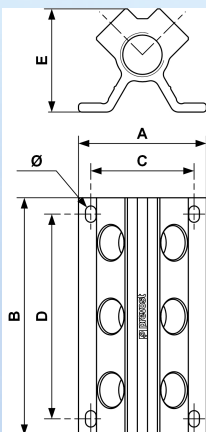

A (mm)	B (mm)	C (mm)	D (mm)	E (mm)	Inlet BSPP female thread	Number of outlet	Outlet BSPP female thread	Parts Numbers
78	100	63	80	6,5	G 3/4	4	G 1/2	<b>MF 104S4</b>
78	145	63	125	6,5	G 3/4	6	G 1/2	<b>MF 104S6</b>
78	190	63	170	6,5	G 3/4	8	G 1/2	<b>MF 104S8</b>
78	235	63	215	6,5	G 3/4	10	G 1/2	<b>MF 104S10</b>