

## Features

- Maximum operating pressure is 50 bar.
- Operating temperature range -20°C to +100°C.
- Material: argely Stainless Steel with 17% chromium content
- ISO 6150-C

## RS PRO Pneumatic Quick Connect Coupling

RS Stock No.: 0325641



RS PRO is the own brand of RS. The RS PRO Seal of Approval is your assurance of professional quality, a guarantee that every part is rigorously tested, inspected, and audited against demanding standards. Making RS PRO the Smart Choice for our customers.

## Product Description

### RS PRO Series 107 Quick Connect Couplings Plugs

Pneumatic quick-connect coupling connectors are found across industry in pneumatic systems as diverse as robotic assembly lines and other equipment.

- Largely Stainless Steel with 17% chromium content.
- Maximum operating pressure is 50 bar.
- Operating temperature range -20°C to +100°C.
- Material: argely Stainless Steel with 17% chromium content
- ISO 6150-C

## Specifications

Manufacturer Series	107
Coupling Type	Quick Connect Coupling Plug
Connection Standard	ISO 6150-C
Minimum Operating Temperature	-20°C
Maximum Operating Temperature	+100°C
Maximum Operating Pressure	50 bar
Flow Direction & Sealing	Through type coupling
Material	Stainless Steel
Finish	N/A
Connection Type	Hose Barb
Thread Size	N/A
Thread Standard	N/A
Thread Gender	N/A
Coupling Gender	Male
Threaded Connection	N/A
Seal material	N/A
Hose Barb Connection	8mm

## Specifications

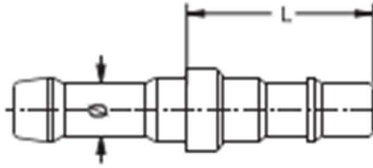

Dimensions (mm)		
SW	L	ØD
-	34	-

Pneumatic charts flow rate/Pressure drop from the single shut-off system  
Pneumatische Durchflusswiderstandskurven mit einseitiger Absperrung (Druckluft)

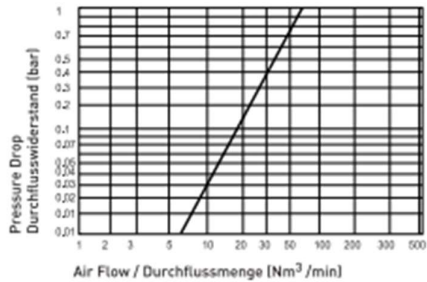

Hydraulic charts flow rate/Pressure drop  
Hydraulische Durchflusswiderstandskurve

