

Flush-type connector - SACC-E-MINFS-4CON-PG13/0,5 - 1521423

Please be informed that the data shown in this PDF Document is generated from our Online Catalog. Please find the complete data in the user's documentation. Our General Terms of Use for Downloads are valid (<http://download.phoenixcontact.com>)



Sensor/actuator flush-type socket, 4-pos., 7/8", front mounting with Pg13.5 fastening thread, with 0.5 m PVC litz wire, 4 x 0.75 mm²



Key commercial data

| | |
|--------------------------------------|--|
| Packing unit | 1 pc |
| GTIN |  4 017918 949648 |
| Weight per Piece (excluding packing) | 40.3 g |
| Custom tariff number | 85366990 |
| Country of origin | Germany |

Technical data

Dimensions

| | |
|-----------------|-------|
| Length of cable | 0.5 m |
|-----------------|-------|

Ambient conditions

| | |
|---------------------------------|---------------------------|
| Ambient temperature (operation) | -40 °C ... 85 °C (Socket) |
| Degree of protection | IP67 |

General

| | |
|------------------------|-----------------------|
| Rated current at 40°C | 9 A |
| Rated voltage | 250 V |
| Number of positions | 4 |
| Contact resistance | ≤ 5 mΩ |
| Insulation resistance | ≥ 100 MΩ |
| Coding | A - standard |
| Status display | No |
| Surge voltage category | II |
| Pollution degree | 3 |
| Connection method | Individual wires |
| Mounting type | Front mounting Pg13.5 |

Flush-type connector - SACC-E-MINFS-4CON-PG13/0,5 - 1521423

Technical data

Material

| | |
|---|------------------------------|
| Inflammability class according to UL 94 | HB |
| Contact material | CuZn |
| Contact surface material | Au |
| Contact carrier material | PUR |
| Material, knurls | Zinc die-cast, nickel-plated |
| Sealing material | Viton |

Cable

| | |
|------------------------------------|--|
| Cable type | PVC litz wire |
| Conductor cross section | 0.75 mm ² |
| AWG signal line | 18 |
| Conductor structure signal line | 24x 0.20 mm |
| Core diameter including insulation | 2.7 mm |
| Thickness, insulation | 0.85 mm (Core insulation) |
| Wire colors | brown, white, blue, black |
| Material conductor insulation | PE |
| Ambient temperature (operation) | -40 °C ... 85 °C (cable, fixed installation) |

Classifications

eCl@ss

| | |
|------------|----------|
| eCl@ss 4.0 | 27140815 |
| eCl@ss 4.1 | 27140815 |
| eCl@ss 5.0 | 27143423 |
| eCl@ss 5.1 | 27143423 |
| eCl@ss 6.0 | 27143423 |
| eCl@ss 7.0 | 27449001 |
| eCl@ss 8.0 | 27449001 |

ETIM

| | |
|----------|----------|
| ETIM 2.0 | EC001297 |
| ETIM 3.0 | EC002061 |
| ETIM 4.0 | EC002062 |
| ETIM 5.0 | EC002061 |

UNSPSC

| | |
|---------------|----------|
| UNSPSC 6.01 | 31251501 |
| UNSPSC 7.0901 | 31251501 |
| UNSPSC 11 | 31251501 |
| UNSPSC 12.01 | 31251501 |
| UNSPSC 13.2 | 31251501 |

Flush-type connector - SACC-E-MINFS-4CON-PG13/0,5 - 1521423

Approvals

Approvals

Approvals

UL Recognized / cUL Recognized / GOST / cULus Recognized

Ex Approvals

Approvals submitted

Approval details

| | |
|--|-------|
| UL Recognized  | |
| mm²/AWG/kcmil | 20 |
| Nominal current I _N | 8 A |
| Nominal voltage U _N | 600 V |

| | |
|--|-------|
| cUL Recognized  | |
| mm²/AWG/kcmil | 20 |
| Nominal current I _N | 8 A |
| Nominal voltage U _N | 600 V |

| |
|--|
| GOST  |
|--|

| |
|--|
| cULus Recognized  |
|--|

Drawings

Flush-type connector - SACC-E-MINFS-4CON-PG13/0,5 - 1521423

Dimensioned drawing

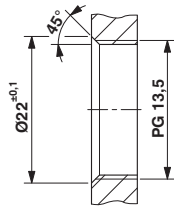

Mounting panel with thread

Schematic diagram

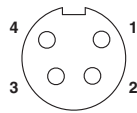

Pin assignment, socket, 7/8"-16UNF, 4-pos., view of female side

Dimensioned drawing

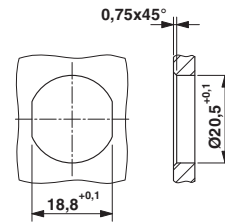

Mounting panel with feed-through hole

Dimensioned drawing

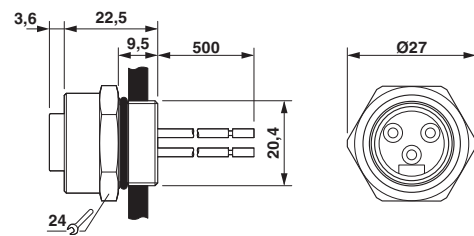

7/8" flush-type plug