

## Deep groove ball bearings, single row, seal on both sides

Principal dimensions			Basic load ratings		Fatigue load limit $P_u$	Speed ratings		Mass	Designation
d	D	B	dynamic	static		Reference speed	Limiting speed		
mm			kN		kN	r/min		kg	-
25	47	12	11,9	6,55	0,275	-	9500	0,080	6005-2RSH *

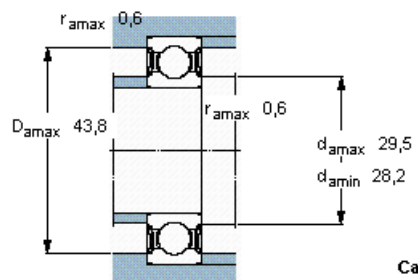
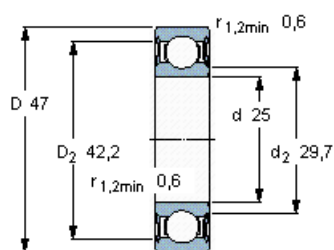

### Calculation factors

$k_r = 0,025$

$f_0 = 14$