

Fiche technique

Limes rondes de RS Pro

FR



Caractéristiques du produit :

- Acier à haute teneur en carbone
- Doubles surfaces de coupe
- Effilé vers la pointe
- Type de coupe : 1 = bâtarde, 2 = mi-doux, 3 = doux

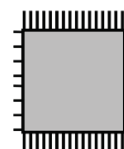
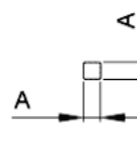
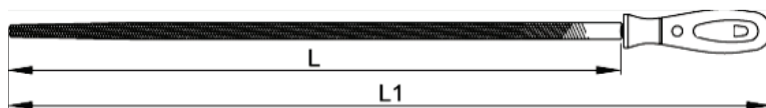

CODE COMMANDE RS	REFERENCE	L mm - pouces	A mm	L1 mm	Type de coupe		8
1923689	J58-108HRS	200 – 8 pouces	8	315	1	J71-04	115