

# Aluminium-Copper Terminal Ends

## Deep Indent Crimping



### General features

- ✓ Friction welded aluminium-copper terminal ends.
- ✓ The aluminium barrel, closed by a protection cap, is covered inside with neutral grease for a better electrical contact.
- ✓ Crimping by deep indent.

**C-AU Series**

**Compliant NF C 33-090-1**

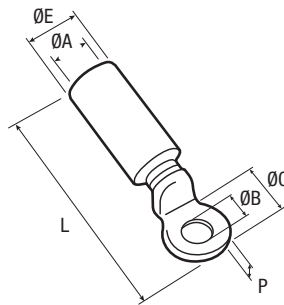

Tongue from C0 AU 16 to C5 AU 400

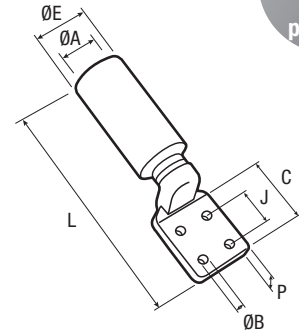

Tongue from C6 AU 500 to C8 AU 1300

mm <sup>2</sup>	Item code	x3	Part No.	Ø A	Ø E	Ø C	Ø B	J	L	P	Dies Punches	
											..MC0E	0E
16	7580011		C0AU16	5.5	16	20	10.5	-	79	4.5	..MC0E	0E
25	7580021		C0AU25	6.5	16	20	10.5	-	79	4.5	..MC0E	0E
35	7580031		C0AU35	8	16	25	12.8	-	86	5	..MC0E	0E
50	7580041		C1AU50	9	20	25	12.8	-	86	5	..MC1E	1E
70	7580051		C1AU70	11	20	25	12.8	-	86	5	..MC1E	1E
95	7580061		C1AU95	12.5	20	25	12.8	-	86	5	..MC1E	1E
120	7580071		C2AU120	13.7	25	30	12.8	-	110	6	..MC2E	2E
150	7580081		C2AU150	15.5	25	30	12.8	-	110	6	..MC2E	2E
185	7580091		C4AU185	17	32	30	12.8	-	110	6	..MC4E	4E
240	7580101		C4AU240	19.5	32	30	12.8	-	110	6	..MC4E	4E
300	7580111		C5AU300	23.3	40	36	16.5	-	153	7	..MC5E	5E
400	7580121		C5AU400	26	40	36	16.5	-	153	7	..MC5E	5E
500	7580131		C6AU500	29.1	47	60 x 60	4 Ø 9	30	200	10	..MC6E	6E
630	7580141		C6AU630	32.5	47	60 x 60	4 Ø 9	30	200	10	..MC6E	6E
800	7580171		C7AU800	37.5	60	80 x 80	4 Ø 11	40	260	10	..MC7E	7E
1 000	7580181		C7AU1000	42	60	80 x 80	4 Ø 11	40	260	10	..MC7E	7E
1 200	7580191		C8AU1200	45.5	65	80 x 80	4 Ø 11	40	270	10	..MC8E	8E
1 300	7580201		C8AU1300	47.5	65	80 x 80	4 Ø 11	40	270	10	..MC8E	8E

Conductor size (mm<sup>2</sup>)

Packing

Type of dies

Unless otherwise stated, all dimensions are in millimeters.