

FAG

4212-B-TVH [🔗](#)

Deep groove ball bearing

Deep groove ball bearing 42...-B-TVH, double row, plastic cage

Technical information

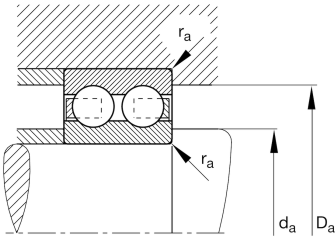
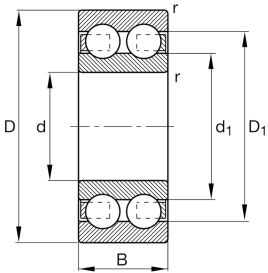

Your current product variant

Design variant	B	Bearing without filling slot
Cage	TVH	Solid cage made of glass-fiber reinforced polyamid PA66
Radial internal clearance	CN (Group N)	Normal internal clearance

Main Dimensions & Performance Data

d	60 mm	Bore diameter
D	110 mm	Outside diameter
B	28 mm	Width
C _r	56,000 N	Basic dynamic load rating, radial
C _{0r}	56,000 N	Basic static load rating, radial
C _{ur}	2,900 N	Fatigue load limit, radial
n _G	5,000 1/min	Limiting speed
n _{gr}	5,400 1/min	Reference speed
≈m	1.077 kg	Weight

Mounting dimensions

d _{a min}	69 mm	Minimum diameter shaft shoulder
D _{a max}	101 mm	Maximum diameter of housing shoulder
r _{a max}	1.5 mm	Maximum fillet radius



Dimensions

r _{min}	1.5 mm	Minimum chamfer dimension
D ₁	95.34 mm	Shoulder diameter outer ring
d ₁	79.8 mm	Shoulder diameter inner ring

Temperature range

T _{min}	-20 °C	Operating temperature min.
T _{max}	120 °C	Operating temperature max.

Calculation factors

f ₀	15	Calculation factor
----------------	----	--------------------

Characteristics

	Radial load
	Axial load in one direction
	Axial load in two directions
	Grease Lubrication
	Not sealed